

DAY CARE CENTER REVIEW

3-D-06-UR
#76

Case No. : 3-D-06 UR

Applicant : Word Afire Church

Zoning Ordinance Requirements (Article 5, Section 3, G.4)

- **Minimum Lot Size**
Required: 15,000 sq. ft.
Request: 120,661 sq. ft.
- **Minimum Size for Fenced Outdoor Play Area**
Required: 4,000 sq. ft. (4000 sq. ft. for first 20 children; 100 sq. ft. per each additional child)
Request: 2,700 sq. ft.
- **Minimum Building Area**
Required: 700 sq. ft. (35 sq. ft. per child, with not less than 75% of this space provided in the primary care area of the building)
Request: 12,400 sq. ft.
- **Minimum Off-Street Parking (Article 5, Section 7)**
Required: 4 teacher/employee spaces (two (2) parking spaces per three (3) teachers and employees)
3 off-street loading spaces (one (1) off-street loading space per eight (8) pupils)
Request: 4 teacher/employee spaces
3 off street loading spaces

Site Plan

For

Dord Afire Church
 706 Sevier Heights Rd
 Knoxville TN 37920

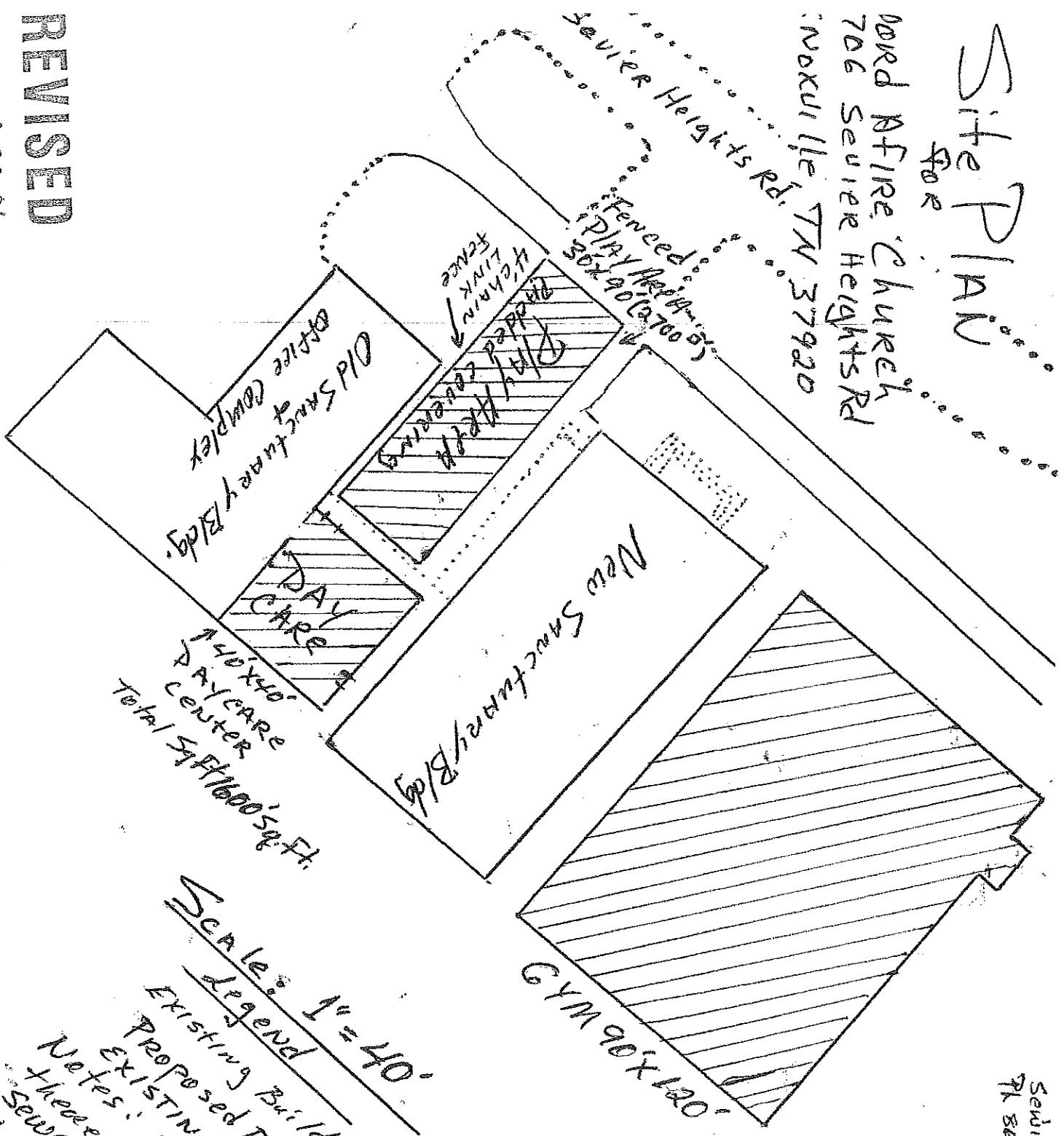

440 X 40'
 DAY CARE
 Total 5471600 sq. Ft.

SCALE: 1" = 40'

- Legend
- Existing Building [Solid Line]
 - Proposed Building [Dashed Line]
 - EXISTING COUNTOURS [Dotted Line]

Notes:
 There are no underground
 sewers, gas lines or phone
 lines or electrical lines under
 the play ground area

Sevier Pastore (319) 964 1122
 PK 865-579-6228 EXT 201

REVISED

3-D-06 UR 2-23-06



WORD AFIRE CHURCH
P.O. Box 9777 • 3706 SEVIER HEIGHTS ROAD • KNOXVILLE, TN 37940-9777 • *A Division of Wayne Marler Crusades, Inc.

February 22, 2006

Metropolitan Planning Commission
City County Bldg., Suite 403
400 Main Street
Knoxville, TN 37902

FEB 23 2006

(3-D-06-UR)

Dear Kelli:

I am writing in regard to the questions you asked by phone concerning our application for a day care at our Church.

You requested to know the number of students and teachers we will have at our day care. We will be seeking a license through the Department of Human Resources for a day care for less than 20 children. Requirements for adult supervision vary according to the ages of the children. We anticipate an enrollment that would require us to have 4 adults as day care workers. With regard to parking, the day care will operate at different hours than the church. The church staff will be here at the same time the day care providers however, there is more than adequate parking space available for both the church staff and the day care providers. Currently, there are only two employees on staff at the Church.

With regard to the play ground area we are aware that padding or wood chips is a requirement. As I stated earlier we are in the process of applying for the day care license through the Department of Human Resources. If you need any additional information please give me a call at 579-6228 ext. 201

In His Service,

Wayne Marler
Senior Pastor

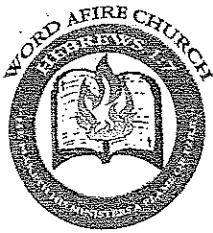

WORD AFIRE CHURCH

P.O. Box 9777 • 3706 SEVIER HEIGHTS ROAD • KNOXVILLE, TN 37940-9777 • *A Division of Wayne Marler Crusades, Inc.

February 3, 2006

3-D-06-UR

Metropolitan Planning Commission
City County Bldg., Suite 403
400 Main Street
Knoxville, TN 37902

Dear MPC:

In regard to the play ground area for the day care I am asking for a variance. The area we would like to designate for the play ground would be between the old and new sanctuaries. This area is roughly 90ft. X 30 ft. The day care will access to the gym in addition to the play area.

This area is not part of the parking area which consists of over 275 parking spaces. According to MPC's General Provisions we are required to have one parking space per four seats or one per 30 square feet of useable floor area of the auditorium, whichever is greater. Taking the greater, our auditorium is 60X120 (outside dimension), 7200 sq. ft. This translates into 240 parking spaces of which we have 275 marked spaces.

We clearly have enough parking for the requirement, however, I am requesting a variance on the necessary square footage for the fenced in play ground.

A map/drawing indicates the area for the play ground. Thanks in advance and God bless the MPC.

In His Service,

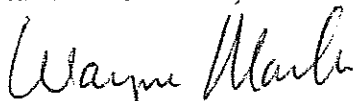
Wayne Marler
Senior Pastor



WORD AFIRE CHURCH

P.O. Box 9777 • 3706 SEVIER HEIGHTS ROAD • KNOXVILLE, TN 37940-9777 • A Division of Wayne Marler Crusades, Inc.

February 1, 2006

Metropolitan Planning Commission
City County Bldg., Suite 403
400 Main Street
Knoxville, TN 37902

Dear MPC:

It is the intension of Word Afire Church to start a day care at their facility. The operating hours will be Monday through Friday from 6am until 6pm. We would like to begin in May or June of this year.

WAC has over 75,000 square feet of building space available and over 2 acres of parking. Recently, the Knox County Fire Marshall inspected our facility and we are current with all the requests made.

We will be glad to furnish any additional information to the MPC at your request.

We have adequate play ground areas, however at the present they are not fenced. Our plan is to have this completed in the near future.

Thank you in advance for your assistance in this matter. God bless you.

In His Service,

Wayne Marler
Senior Pastor

U.O.R.

DATE 2/6/06

3-D-06UR