



**KNOXVILLE/KNOX COUNTY METROPOLITAN PLANNING COMMISSION
SUBDIVISION REPORT - FINAL**

▶ **FILE #:** 11-SK-06-F

AGENDA ITEM #: 40

AGENDA DATE: 11/9/2006

▶ **SUBDIVISION:** RIDGEFIELD ADDITION RESUB.

▶ **APPLICANT/DEVELOPER:** GRAHAM CORPORATION

OWNER(S): GRAHAM DEVELOPMENT CORP.

TAX IDENTIFICATION: 68 N C 014

JURISDICTION: City Council District 5

▶ **LOCATION:** **Northeast side of Clinton Hwy., northwest side of Merchants Drive**

SECTOR PLAN: Northwest City

GROWTH POLICY PLAN: Urban Growth Area (Inside City Limits)

▶ **APPROXIMATE ACREAGE:** 1.05 acres

▶ **NUMBER OF LOTS:** 1

▶ **ZONING:** **C-3 (General Commercial)**

SURVEYOR/ENGINEER: Professional Land Systems

▶ **VARIANCES REQUIRED:** **1. To reduce the utility and drainage easement from 10' to 5' along the right of way lines of the property.**

STAFF RECOMMENDATION:

▶ **DENY Final Plat**

COMMENTS:

Staff has recommended denial of this Final Plat because a reviewable plat was not received until corrections deadline. Staff has now received a corrected plat and the applicant now has an approvable plat and will be requesting waiver of the 9 day rule and approval of the plat.

MPC's approval or denial of this request is final, unless the action is appealed to . The date of the appeal hearing will depend on when the appeal application is filed.

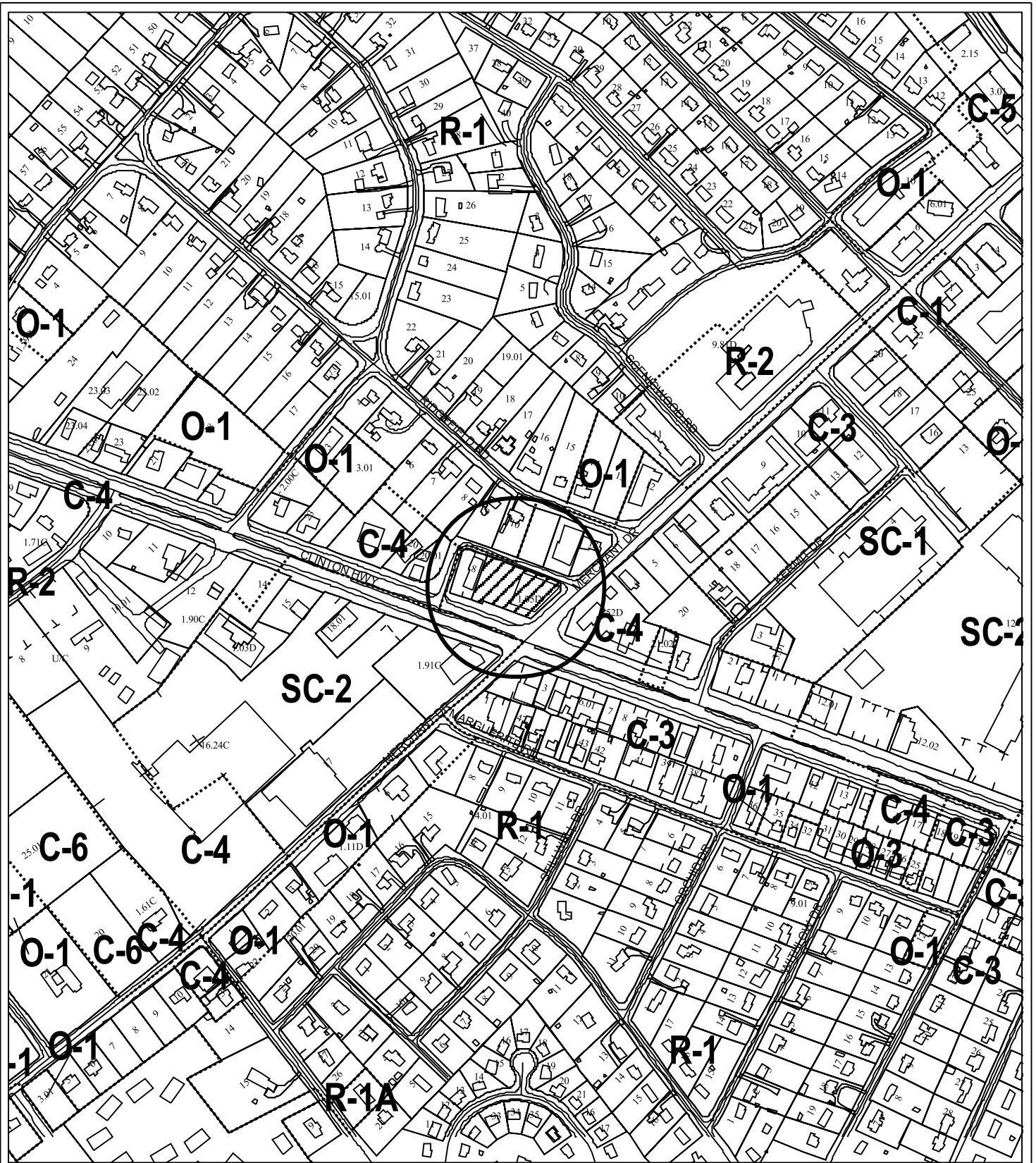

11-SK-06-F
FINAL SUBDIVISION PLAT



Final Plat for: Ridgefield Addition Resub.

Original Print Date: 11/03/06 Revised: 11/03/06
Metropolitan Planning Commission * City / County Building * Knoxville, TN 37902

Subdivision: Graham Corporation

Map No: 68

Jurisdiction: City



