



**KNOXVILLE/KNOX COUNTY METROPOLITAN PLANNING COMMISSION
SUBDIVISION REPORT - CONCEPT/USE ON REVIEW**

▶ **FILE #:** 4-SB-07-C **AGENDA ITEM #:** 13
4-A-07-UR **AGENDA DATE:** 5/10/2007

POSTPONEMENT(S): 4/12/2007

▶ **SUBDIVISION:** M & M PARTNERS ON RATHER RD.

▶ **APPLICANT/DEVELOPER:** M & M PARTNERS

OWNER(S): M&M Partners

TAX IDENTIFICATION: 89 173

JURISDICTION: County Commission District 6

▶ **LOCATION:** East side of George Light Rd., north side of Rather Rd.

SECTOR PLAN: Northwest County

GROWTH POLICY PLAN: Planned Growth Area

▶ **APPROXIMATE ACREAGE:** 12.81 acres

▶ **ZONING:** PR (Planned Residential) pending

▶ **EXISTING LAND USE:** One mobile home and vacant land

▶ **PROPOSED USE:** Attached residential subdivision

SURROUNDING LAND USE AND ZONING: The area on the east side of Pellissippi Pkwy. is developed primarily with agricultural and rural residential uses, under A zoning. The site is within the Technology Overlay along the Pellissippi corridor. A technology type business is developed adjacent to this site to the southeast under BP/TO.

▶ **NUMBER OF LOTS:** 43

SURVEYOR/ENGINEER: Batson, Himes, Norvell & Poe

ACCESSIBILITY: Access is via Rather Rd., a local street with a pavement width of 14' to 16' within a 40' wide right-of-way.

▶ **SUBDIVISION VARIANCES REQUIRED:** None

STAFF RECOMMENDATION:

▶ **APPROVE the concept plan subject to 9 conditions**

1. Connection to sanitary sewer and meeting any other relevant requirements of the Knox County Health Department.
2. Provision of a street name which is consistent with the Uniform Street Naming and Addressing System within Knox County (91-1-102)
3. Meeting all applicable requirements of the Knox County Dept. of Engineering and Public Works
4. The applicant widening Rather Rd. from George Light Rd. to the proposed subdivision entrance to a minimum width of 20'. The widening is to be done with the approval of and under the supervision of the Knox County Dept. of Engineering and Public Works.
5. Prior to certification of the final plat for the subdivision, establishing a property owners association for the

purpose of maintaining the storm water drainage system.

6. Certification on the final plat by the applicant's engineer that there is 300' of sight distance at the intersection of the proposed subdivision entrance and Rather Rd.
7. Place a note on the final plat that all lots will be access from the internal road system only
8. Note on the plan the required 25 from center line minimum right-of-way dedication on Rather and George Light Roads.
9. A final plat based on this concept plan will not be accepted for review by MPC until certification of design plan has been submitted to MPC staff

► **APPROVE the development plan for up to 43 attached residential dwellings on individual lots subject to 2 conditions.**

1. Prior to obtaining any building permits submit a revised typical landscaping plan that incorporates the use of shrubs, flowering and shade trees for MPC staff review and approval
2. Meeting all other applicable requirements of the Knox County Zoning Ordinance

COMMENTS:

The applicant has present a concept plan for 43 lots on this 12.81 acre site. This matter was postponed at the April MPC meeting to permit County commission to act on the rezoning of the site. On April 16, 2007 the Knox County Commission approved the rezoning of this site to PR (Planned Residential) at 5 du/ac. The proposed development will consist of 43 attached residential units. Development of this site with attached dwellings allows the density to be concentrated outside the area of steepest slopes on the property.

EFFECT OF THE PROPOSAL ON THE SUBJECT PROPERTY, SURROUNDING PROPERTY AND THE COMMUNITY AS A WHOLE

1. The proposed subdivision will have minimal impact on local services since water and sewer will be provided to this site.
2. The proposed attached residential subdivision at a density of 3.36 du/ac, is consistent in use and density with the approved zoning of the property.
3. Any school age children living in this development are presently zoned to attend Hardin Valley Elementary, Karns Middle School and Karns High School.

CONFORMITY OF THE PROPOSAL TO CRITERIA ESTABLISHED BY THE KNOX COUNTY ZONING ORDINANCE

1. The proposed attached residential subdivision meets the standards for development within a PR Zone and all other requirements of the Zoning Ordinance with the recommended conditions.
2. The proposed residential development is consistent with the general standards for uses permitted on review:
 - A. The proposed development is consistent with the adopted plans and policies of the General Plan and Sector Plan. The Northwest County Sector Plan proposes this site for low density residential use which may permit a maximum density of 5 dwellings per acre. The overall development density of the proposed development is 3.36 dwellings per acre.
 - B. The use is in harmony with the general purpose and intent of the Zoning Ordinance. The proposed development complies with all the height, bulk and area requirements of the Knox County Zoning Ordinance. The proposed development meets all the requirements of the PR (Planned Residential) District).
 - C. The use is compatible with the character of the neighborhood where it is proposed. As previously noted, the proposed development is compatible in use and intensity of development with the surrounding area.
 - D. The use will not significantly injure the value of adjacent property.
 - E. The use will not draw additional non-residential traffic through residential areas. This is a low density residential development within an area designated for low density residential use. The traffic generated from this project will be similar to the traffic that is generated by other residential developments.

CONFORMITY OF THE PROPOSAL TO ADOPTED PLANS

1. The Northwest County Sector Plan designates this property for low density residential use. The PR zoning approved for the property allows consideration of up to 5.0 du/ac . The proposed subdivision with its distribution of density on the site and overall density of 3.36 du/ac is consistent with the Sector Plan and the proposed zoning designation.
2. The site is located within the Planned Growth Area on the Knoxville-Knox County-Farragut Growth Policy

Plan map.

MPC's approval or denial of this concept plan request is final, unless the action is appealed to Knox County Chancery Court. The date of the Knox County Chancery Court hearing will depend on when the appeal application is filed.

MPC's approval or denial of this use on review request is final, unless the action is appealed to the Knox County Board of Zoning Appeals. The date of the Knox County Board of Zoning Appeals hearing will depend on when the appeal application is filed.

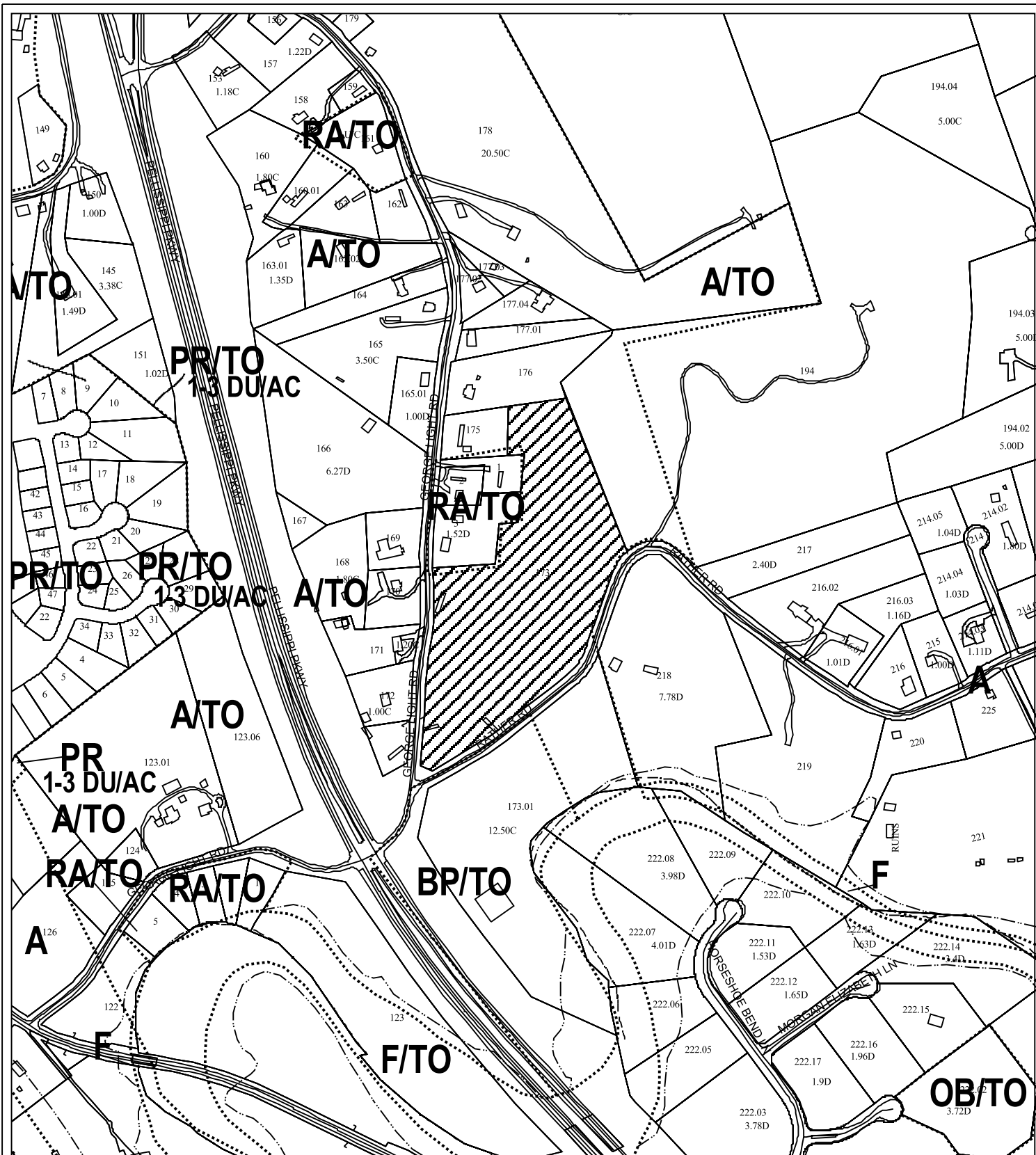

4-SB-07-C/4-A-07-UR
 CONCEPT PLAN/USE ON REVIEW

 Attached residential development in PR (Planned Residential) pending

Original Print Date: 03/21/07 Revised:
 Metropolitan Planning Commission * City / County Building * Knoxville, TN 37902

Petitioner: M & M Partners on Rather Rd.
 M & M Partners

Map No: 89

Jurisdiction: County



