



AGENDA ITEM #: 93

MEMORANDUM

TO: Metropolitan Planning Commission
FROM: Buz Johnson, Deputy Director
DATE: Monday, April 30, 2007
SUBJECT: Staff Report for Plans of Service - 5-B-07-OB

The Planning Commission staff has received and reviewed Plans of Service for the following properties and has found them to be in conformance with the minimum statutory requirements for plans of service as outlined in Tennessee Code Annotated 6-6-102:

- 1-5-07.AX-A tract of land south of Luscombe Dr. and southeast of the intersection of Bardon Rd. and Luscombe Dr.
- 2-5-07.AX-A tract of land south of Luscombe Dr. and approx. 300' northeast of the intersection of Bardon Rd. and Luscombe Dr.
- 3-5-07.AX-A tract of land south of Luscombe Dr. and approx. 710' northeast of the intersection of Bardon Rd. and Luscombe Dr.
- 4-5-07.AX-A tract of land south of Luscombe Dr. and approx. 30' southwest of the intersection of Moneta Rd. and Luscombe Dr.
- 5-5-07.AX-A tract of land south of Luscombe Dr. and approx. 490' northeast of the intersection of Moneta Rd. and Luscombe Dr.
- 6-5-07.AX-A tract of land south of Luscombe Dr. and approx. 175' southwest of the intersection of Morrell Rd. and Luscombe Dr.

STAFF RECOMMENDATION:

Approve and adopt this report and forward these findings to the Knoxville City Council.

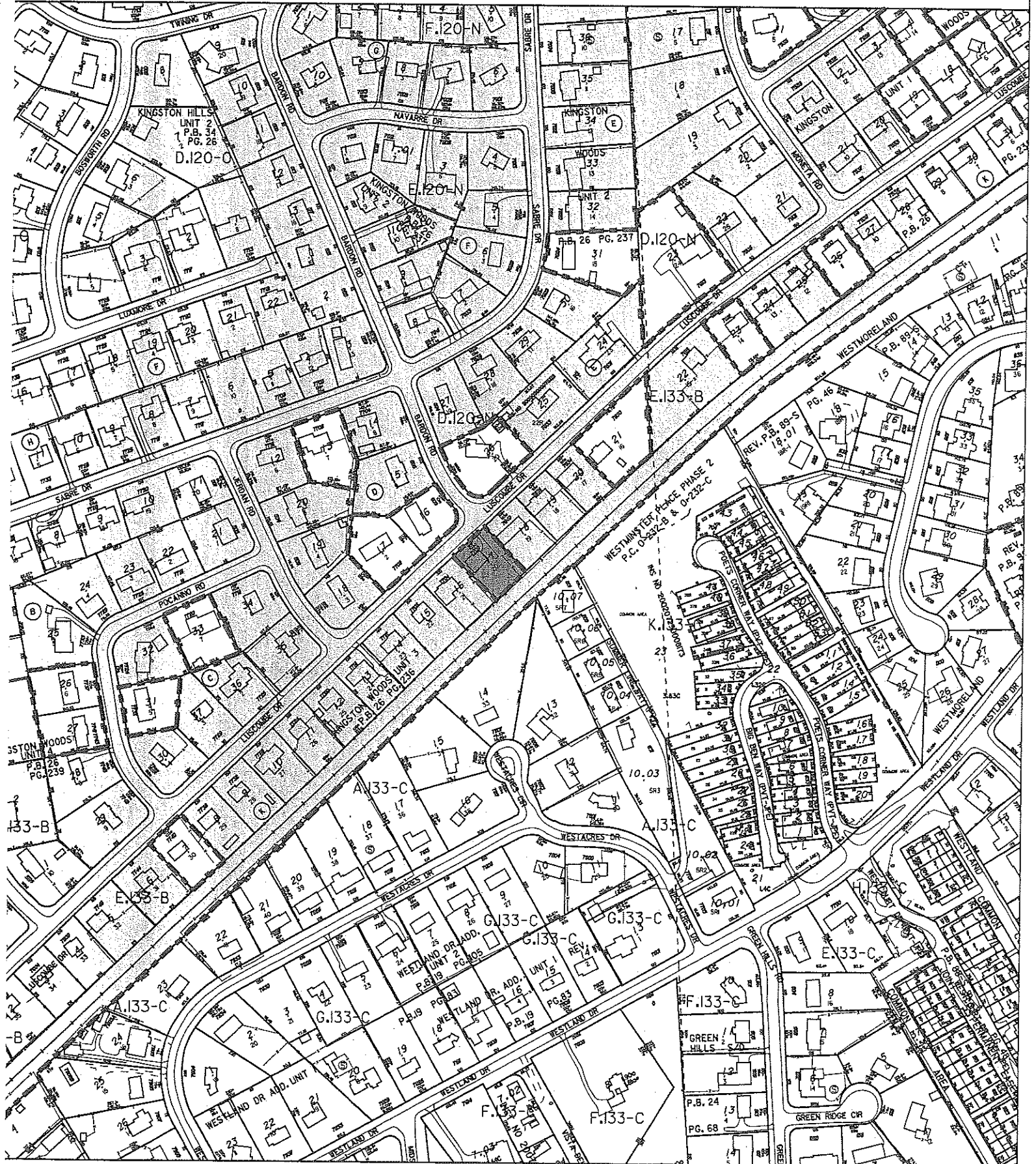

Parcel Number: 133BE07
 Calculated Acres : 0.3366
 MPC May 10, 2007

5-Apr-2007
 Agenda Item # 93
 Scale: 1 in = 300 ft



Parcel Number: 133BE021
 Calculated Acres : 0.6139
 MPC May 10, 2007

5-Apr-2007
 Agenda Item # 93
 Scale: 1 in = 300 ft



Parcel Number: 133BE032
 Calculated Acres : 0.3272
MPG May 10, 2007

5-Apr-2007
Agenda Item # 93
 Scale: 1 in = 300 ft



Parcel Number: 133BE035

Calculated Acres : 0.3028

5-Apr-2007

Agenda Item # 93

MPC May 10, 2007

Scale: 1 in = 300 ft