



**KNOXVILLE/KNOX COUNTY METROPOLITAN PLANNING COMMISSION  
PLAN AMENDMENT/REZONING REPORT**

▶ **FILE #:** 5-M-07-RZ  
5-A-07-SP

**AGENDA ITEM #:** 82  
**AGENDA DATE:** 5/10/2007

▶ **APPLICANT:** THE FULLER GROUP  
**OWNER(S):** HOUSER CLARA MARIA LIFE ESTATE

**TAX ID NUMBER:** 90 162  
**JURISDICTION:** Commission District 6

▶ **LOCATION:** Southwest side Gray Hendrix Rd., east side Hodge Rd., north of Byington Solway Rd.

▶ **TRACT INFORMATION:** 11.5 acres.

**SECTOR PLAN:** Northwest County

**GROWTH POLICY PLAN:** Planned Growth Area

**ACCESSIBILITY:** Access is via Gray Hendrix Rd., a local street with 17' of pavement width with 50' of right of way or Hodge Rd., a local street with 11-12' of pavement width within 30-40' of right of way.

**UTILITIES:** Water Source: West Knox Utility District  
Sewer Source: West Knox Utility District

▶ **PRESENT PLAN DESIGNATION/ZONING:** LDR (Low Density Residential) / RA (Low Density Residential)

▶ **PROPOSED PLAN DESIGNATION/ZONING:** LI (Light Industrial) / I (Industrial)

▶ **EXISTING LAND USE:** Residence and vacant land

▶ **PROPOSED USE:** Office warehouse

**EXTENSION OF PLAN DESIGNATION/ZONING:** Yes, extension of LI designation and I zoning from the south

**HISTORY OF ZONING REQUESTS:** None noted

**SURROUNDING LAND USE, PLAN DESIGNATION, ZONING**

North: Dwellings / LDR / RA (Low Density Residential)  
South: Mobile home park and detached dwellings / LI, LDR / I (Industrial) and RA (Low Density Residential)  
East: Gray Hendrix Rd. - Dwelling and pastureland / A (Agricultural)  
West: Hodge Rd. - Dwellings / LDR / I (Industrial) and RA (Low Density Residential)

**NEIGHBORHOOD CONTEXT:** South of the site, along the railroad and Byington-Solway Rd., are light industrial uses, zoned I. To the north, east and west are residential uses, zoned A and RA.

**STAFF RECOMMENDATION:**

▶ **DENY LI (Light Industrial) sector plan designation.**

Light industrial uses on this site would be an intrusion of incompatible uses into a residential area. The access streets to the site for these uses are not adequate.

► **DENY I (Industrial) zoning.**

Industrial zoning is not compatible with the surrounding land uses and zoning pattern and is not consistent with the sector plan proposal for this site.

**COMMENTS:**

**NEED AND JUSTIFICATION FOR THE PROPOSAL**

1. The requested plan amendment and zoning are an intrusion into an established residential area.
2. Light industrial uses should be limited to the area to the south along the railroad and Byington-Solway Rd. where industrial zoned properties are already established.
3. The sector plan proposes low density residential uses for this site, which should be maintained because of the established residential uses to the north and west.
4. The access to the proposed site is not adequate for light industrial uses including the applicant's proposed office/warehouses. The property fronts on two local streets, neither of which has a pavement width of more than 17 feet, that serve primarily residential uses in the immediate area. Even if the site had direct access to Byington-Solway Rd., a wider, major collector street, the proposal still could be considered an intrusion into a residential area.

**THE EFFECTS OF THE PROPOSAL**

1. Public water and sewer utilities are in place to serve the site.
2. The proposal will have no impact on schools. The exact impact on the street would depend on the size and type of development that is proposed.
3. The proposal is not compatible with adjacent residential uses on three sides and will have a negative impact on them. The current low density residential zoning and plan proposal are appropriate for this site.
4. Staff recommends denial of these requests. If MPC, however, is inclined to approve a zone that will allow the applicant's proposed office/warehouse use, staff would recommend approval of the light industrial sector plan designation, limited to PC zoning only. PC zoning would require the applicant to submit a development plan for use on review consideration by MPC. At this time, however, no rezoning of the property is recommended.

**CONFORMITY OF THE PROPOSAL TO ADOPTED PLANS**

1. The Northwest County Sector Plan proposes low density residential uses for this site, consistent with the surrounding land uses, which staff recommends to be maintained.
2. The Knoxville-Knox County-Farragut Growth Policy Plan designates this site as Planned Growth Area.
3. Approval of this request may generate similar requests for light industrial plan designations and zones in this area, further creating an inappropriate transition in land uses.

If approved, this item will be forwarded to Knox County Commission for action on 6/25/2007. If denied, MPC's action is final, unless the action to deny is appealed to Knox County Commission. The date of the appeal hearing will depend on when the appeal application is filed. Appellants have 30 days to appeal an MPC decision in the County.

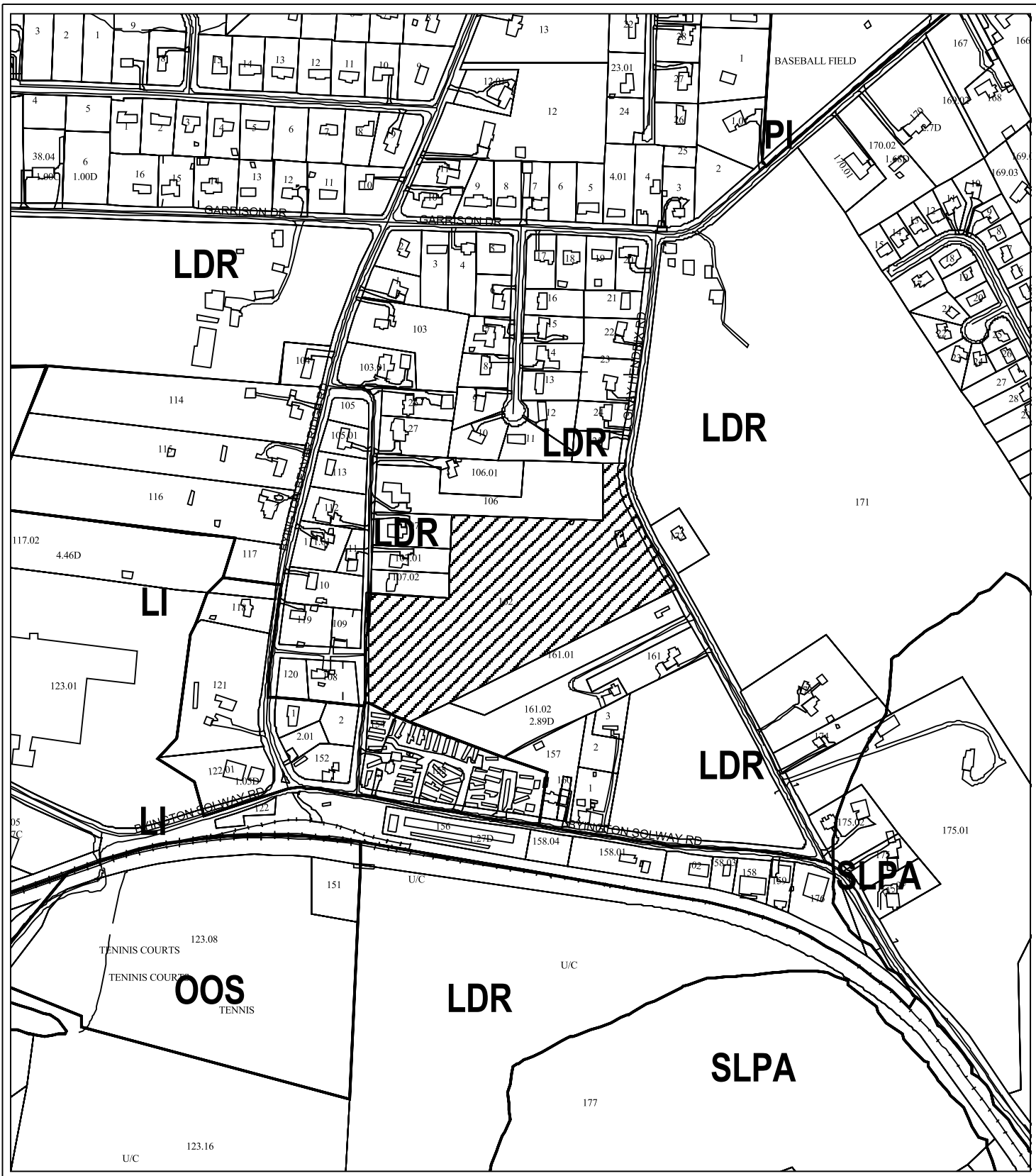

**5-A-07-SP/5-M-07-RZ  
SECTOR PLAN AMENDMENT  
NORTHWEST COUNTY SECTOR PLAN AMENDMENT**

Petitioner: The Fuller Group  
 Map No: 90  
 Jurisdiction: County



 From: LDR (Low Density Residential)  
 To: LI (Light Industrial)

Original Print Date: 04/25/07 Revised:  
 Metropolitan Planning Commission \* City / County Building \* Knoxville, TN 37902

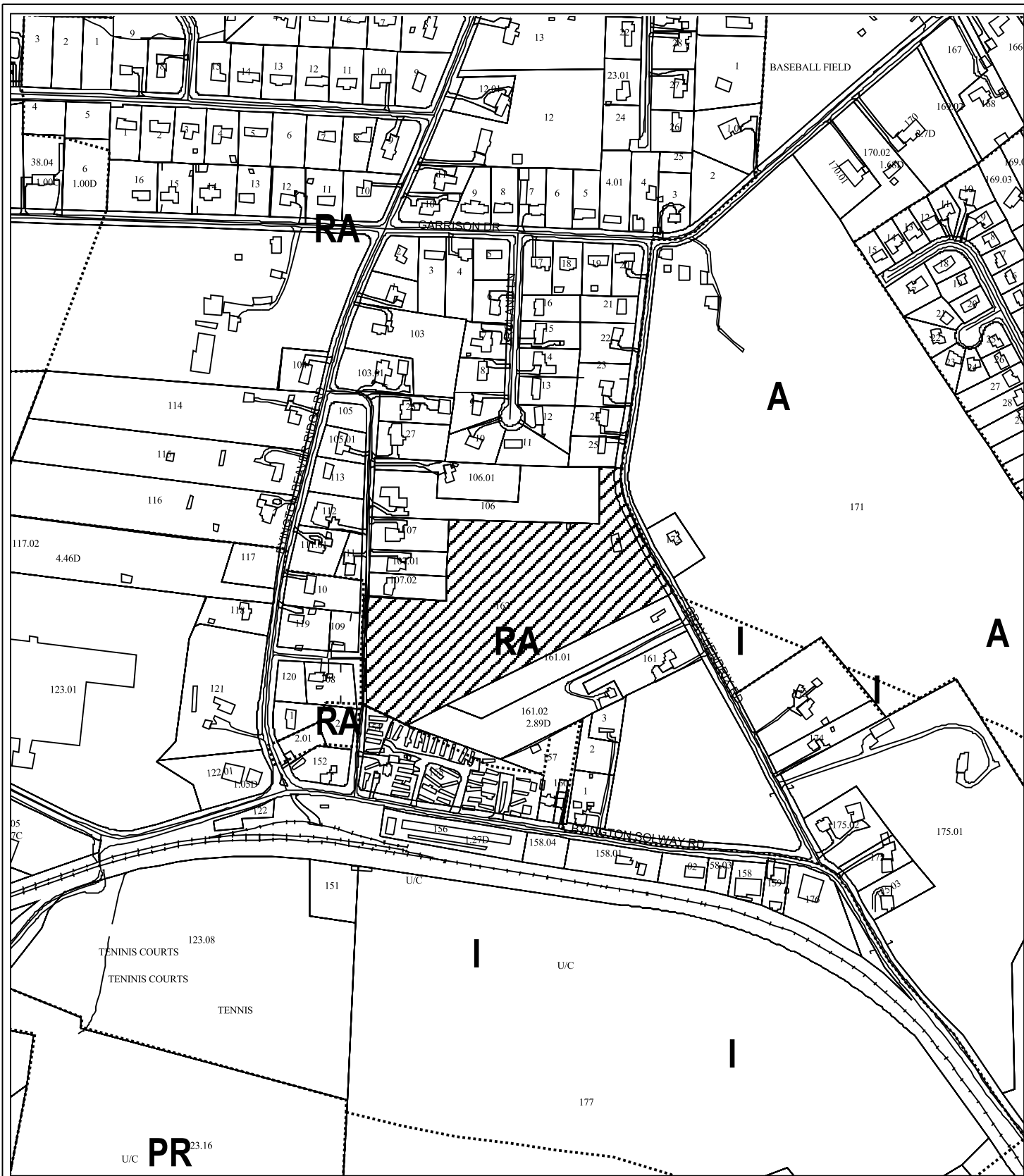

**5-M-07-RZ  
REZONING**

Petitioner: The Fuller Group

Map No: 90

Jurisdiction: County



From: RA (Low Density Residential)

To: I (Industrial)

Original Print Date: 04/25/07

Revised:

Metropolitan Planning Commission \* City / County Building \* Knoxville, TN 37902



**Agenda Item # 82**

\* **301** Signatures  
to "oppose" this  
proposal.

Attention = Buzz Johnson  
(MPC)

attached = LETTER & Petition  
opposing REZONING  
From - Agri to IND  
(pictures encl.)

Submitted to MPC  
on May 3, 2007

### NOTICE OF PUBLIC HEARING

The Knoxville/Knox County Metropolitan Planning Commission will hold a public hearing on  
**Thursday, May 10, 2007** at 1:30 p.m. The hearing will be in the Main Assembly  
Room of the City/County Building, 400 Main Street, in downtown Knoxville.

The following application for development near your property will be considered at the MPC public hearing:

File Number(s): 5-A-07-SP 5-M-07-RZ (THE FULLER GROUP)

Application Type: PLAN AMENDMENT

Curr. Plan Category: LDR (Low Density Residential)

Req. Plan Category: LI (Light Industrial)

Current Zoning: RA (Low Density Residential)

Requested Zoning: I (Industrial)

Proposed Use: Office warehouse

Location: Southwest side Gray Hendrix Rd., east side Hodge Rd., north of  
Byington Solway Rd.

Applicant/Rep.: Fuller - Sims Development (740-7434)

Check for automatic postponement of this item by calling 215-3830.

Questions? Call **Michael Brusseau at MPC (215-2500)**.

To Whom It May Concern:

Petition to oppose the rezoning of the Edgar A. Houser ( Clara ) property at  
2613 Gray – Hendrix Road, Knoxville, TN. 37931-3228  
From – Agricultural to industrial to be considered at the May 10<sup>th</sup>, 2007 MPC meeting

The proposal of building an office warehouse on this 11-½ acre property with frontage property at Gray – Hendrix Road and Hodge Road by the “Fuller Group” should be denied.

Please consider the following facts when a decision regarding this matter is made:

Our primary concern is that we do not need commercial development in a residential area. It should be for residential use only. Gray – Hendrix and Hodge Roads will not handle any more traffic. The roads are narrow. We have many drop off's on the pavement, wrecks occur frequently, (especially in this area), the road has a sharp curve, a narrow bridge and a rise on the road that obstructs ones view. We have school buses that make the traffic so heavy during school hours that it is nearly impossible to get out of driveways. There have been wrecks that have accrued because of the narrow roads including school buses. It is also a cut across for an excessive amount of traffic.

Hopefully, the petition to rezone from agricultural to industrial will be denied.

Please have someone to come out during these busy hours and you will understand our concerns.

Sincerely,

“Home owners / citizens against rezoning this property”

Date submitted to MPC

**May 10, 2007 Meeting**

**82. THE FULLER GROUP**

Southwest side Gray Hendrix Rd., east side Hodge Rd., north of Byington Solway Rd., Commission District 6.

**a. Northwest County Sector Plan Amendment 5-A-07-SP**

From LDR (Low Density Residential) to LI (Light Industrial).

**b. Rezoning 5-M-07-RZ**

From RA (Low Density Residential) to I (Industrial).

**April 12, 2007 Meeting**

**76. THE FULLER GROUP**

Southeast side Hickory Creek Rd., southeast of West Gallaher Ferry Rd., Commission District 6.

**a. Northwest County Sector Plan Amendment 4-D-07-SP**

From A/RR (Agricultural/Rural Residential) to LDR (Low Density Residential).

**b. Rezoning 4-F-07-RZ**

From A (Agricultural) to PR (Planned Residential).

# PLEASE

Try to be present at the proposed rezoning for  
the property of  
Edgar and Clara Houser  
2613 Gray Hendrix Road  
Knoxville, TN. 37931

This petition is against the proposal of Industrial  
Warehouses in a residential neighborhood.

The meeting will start promptly at 1:30 P.M. on  
Thursday May 10<sup>th</sup> at the City / County  
Building, First door to the right when entering  
the building.

The more we have to be at this meeting to voice  
our concerns...the more effective it may be.

Thank you



Home owners / citizens against rezoning property:

2613 Gray - Hendrix Road from agricultural to industrial for proposed building of an office warehouse by "Fuller Group".

Date submitted to MPC

Please sign name & address:

<u>Name</u>	<u>Address</u>	<u>Phone (optional)</u>
OTIS & Pauline O'Dell	2607 Gray-Hendrix Rd. KNOX, TN 37931	
MAUREEN DIXON	2525 Hammond Lane KNOXville, TN 37912	(865) 525-0860
Charlene Henshaw	6717 Pheasant Ln. Knox. Tn, 37923	
Crystal Matthews	7819 Carpenter Road KNOX TN 37931	
Remie Mc Falls	8500 Garrison Rd. Knoxville, TN 37931	
Mr. & Mrs. Jack Kiser	8517 Garrison Dr. 37931	
RUSSELL & INEZ FANN JANICE COX	2717 GRAY HENDRIX ROAD 37931	
Milford Payne	2709 Gray Hendrix	3793
Joni J. Morgan	2609 Gray Hendrix	37931
Tina Whitson	2705 Gray Hendrix Rd.	
Joni Whitson	2705 Gray Hendrix Rd	Agenda item # 8210 (over)

Larry C Turvis  
2816 Gray Memorial Rd.  
Knox, TN, 37931

Bruce Job  
2535 Andrews Crossing Rd.  
Knoxville, TN, 37931

Mary & Leigh Bransner  
2729 Andrews Crossing Rd  
Knoxville, TN 37931

Michael & Debbie Murphy  
2724 Andrews Crossing Rd.  
Knoxville, TN 37931

✓ Melba & Bill Huff  
2723 Andrews Crossing Rd  
Knox, TN 37931

Timothy Furmanak  
2718 Andrews Cr.  
Knox, TN 37931

Ron Zmuda  
2701 Andrews Crossing  
Knoxville, TN 37931

Nancy Stansberry  
2937 John Andrew Ln  
Knoxville, TN 37931

Dave Gibson & Wendy Gibson  
2925 John Andrew Ln  
Knoxville, TN 37931

Travis Young & Crystal Young  
2919 John Andrew Lane  
Knoxville TN 37931

Chizuko Yoshida  
2912 John Andrew Ln  
Knoxville TN 37931

Anthony O Thomas  
John Andrew Ln  
Knoxville, TN. 37931

Evan & Amy Hutcherson  
2901 John Andrew Lane  
Knoxville, TN 37931

Mark Stansberry  
2907 John Andrew Lane  
Knoxville, TN 37931

Home owners / citizens against rezoning property:

2613 Gray – Hendrix Road from agricultural to industrial for proposed building of an office warehouse by “Fuller Group”.

Date submitted to MPC

Please sign name & address:

<u>Name</u>	<u>Address</u>	<u>Phone (optional)</u>
1. Zelen Stachlewsky	2708 Hodge Rd	693-2952- 898-632
2 Ted Howard	2708 Hodge Rd	693-2952-
3. Martha Knight	2712 Hodge Rd.	693-2570
4. Alan Bennett	2706 Hodge Rd.	690-3458
5. Kenneth S Evans	2706 Hodge Rd.	690-3458
6. Rose G. Evans	2706 Hodge Rd	690-3458
7. W. J. Moore	2705 Hodge rd NW	748-2098
8 Tracy M. Moore	2705 Hodge Rd Apt A	789-3000
9. Jim Lucas	} 2704 Byington Beaver Ridge rd.	(865) 951-0206
10. Annie Lucas		
11. Kelli Kirby	} 2724 Hodge Rd.	(865) 539-4471
12. Randeelynn Kirby		
13. Randy Kirby		
14. Jecenette Kirby		
15. Delano Pierce	2912 Byington Beaver Rd	
16. Mary Pierce	2912 Byington	

Home owners / citizens against rezoning property:

2613 Gray - Hendrix Road from agricultural to industrial for proposed building of an office warehouse by "Fuller Group".

Date submitted to MPC

Please sign name & address:

<u>Name</u>	<u>Address</u>	<u>Phone (optional)</u>
Kim Hutchison	8113 Wiebel Dr	865-455-4078
Stewart Daugherty	2626 Sherwin Rd	865-539-9717
Kathy Marshall	2642 Sherwin Rd	865-470-0942
John Miller	2611 Sherwin Rd	865-470-2663
Renee Butts	2630 Sherwin Rd	865 691-2355
Tamera Daugherty	2626 Sherwin Rd	865 539 9717
Tony C. Douglas	2614 Sherwin Rd	865-690-4817
Michelle Blackburn	2606 Sherwin Rd	865 691-4258
Eric Keon	2602 Sherwin Rd	865 363-7550
Mick Meadows	2332 Sherwin Rd	865-693-4792
Richardment, Frenel Street		
Linda Ray	8101 Dee Ct	865-694-3924
Christa Turner	8110 Dee Ct	865-539-1861
Anne Henderson	8106 Dee Ct	865-617-8416
William C. Henderson	8106 Dee Ct	865 617 6646
MPC May 10, 2007	2602 Sherwin Rd	865-851-7343
DP Shaubert	2536 SHERWIN RD KNOXVILLE TN	865 531-0555

Kevin W. Johnson	2533 Sherwin R	693-4719
Tricia F. Johnson	2533 Sherwin Rd	693-4719
Jacki E. Kellogg	2529 Sherwin Rd	470-3600
Zelma Booth	2525 Sherwin Rd	531- <del>6539</del> 6539
J.L. Booth	2525 Sherwin Rd	531-6539
Mark Long	2524 Sherwin Rd	539-3454
LeAnn Bruce	2516 Sherwin Rd	851-7233
Annette Thomas	2512 Sherwin Rd	694-0155
<i>[Signature]</i>	2504 Sherwin Rd	388-4970
Kenneth Ray Ely	2505 Sherwin Rd	531-7456
Chris Ely	2609 Wynmoor Cir.	691-9734
John M. Wurd	8117 Wiebels Dr	560-1968
Violet Isom	7825 BROWN VUE RD.	690-2899
Emerise Dapson	7969 Wiebels Dr.	690-0868
Preston Hedderley	8113 Wiebels Dr.	973-0536
<i>[Signature]</i>	8114 Wiebels Dr	691-2840
Linda Crawford	8114 Wiebels Dr.	691-2840
Tommy Freaghy	8112 Wiebels	691-8146
Judy Gregory	8112 Wiebels	691-8146
Beth Sullivan	8109 Wiebels Drive	640-4952
<i>[Signature]</i>	8109 Wiebels Drive	640-4953
Kathlyn S. Pardue	8109 Wiebels Dr	640-4952
Elizabeth Marcotte	8104 Wiebels Dr	693-2173
<i>[Signature]</i>	8104 Wiebels Dr	693-2173
Valerie Sampson	8012 Wiebels Dr.	405-3667
<i>[Signature]</i>	8004 Wiebels Dr	690-2580
<i>[Signature]</i>	8004 Wiebels Dr.	690-2580

Home owners / citizens against rezoning property:

2613 Gray - Hendrix Road from agricultural to industrial for proposed building of an office warehouse by "Fuller Group".

Date submitted to MPC

Please sign name & address:

<u>Name</u>	<u>Address</u>	<u>Phone (optional)</u>
Robert Ernest		
Condy Sharp	3017 GRAY HENDRIX RD	
Ed Hawkins	3045 Gray Hendrix Rd	
Edith Housby	3101 " " "	
Shelma Atkins	3041 " "	
Andy Higginbotham	3057 Gray Hendrix Rd.	
Geneva Higginbotham	3057 Gray Hendrix Rd.	
Kenneth E. Troutman	2230 Buxington Solway Rd	
Jeanita Troutman	2230 Buxington Solway Rd	
Vivonne Knight	8529 Boss Rd Knox 37931	
Loyce (Hughes) Tridell	- Property Owner - AT - 2609 Gray - Hendrix Rd - Knox, TN -	37931
Katherine Roe	1338 Buxington - Beecher 37931 Ridge	
* Dallis Walker	8408 Dolph Dr. Knoxville	
Olav Bruce	8609 Dolph Dr. Knox	
Sandra K Weige	8628 Dolph Dr. (865) 694-7686 KNOX-TN 37931	
Alvark Leadman	6752 Greenbush Dr. Knox 37931	938-6858
Marilyn Leadman		

William T. + Sylvia Clay 3210 BISCO DRIVE KNOX. 37931  
 3205 BISCO DR. KNOX 37931  
 Kyle B. Davis  
 Shirley Osborn 3208 Bisco Dr Knoxville TN  
 37931  
 Cheryl Hayne 3208 Bisco Dr Knoxville TN  
 37931  
 S Fay McPherson 3209 Bisco Dr. Knoxville, TN.  
 Steve McPherson 3209 Bisco Dr. Knoxville, TN. 37931  
 Jim Roberts 3212 Bisco Dr Knoxville TN. 37931  
 Son FehI 8633 Terrada Drive Knoxville TN 37931  
 Paul + Margaret Blomhorn 8650 Terrada Drive KNOX TENN  
 37931  
 Kenn + Lori Pokryjka 8656 Terrada Drive Knox, TN 37931  
 Stacie Strader 8656 Terrada Drive Knox, TN 37931  
 David Shaun Brown 8662 Terrada Drive Knox, TN 37931  
 Rebecca Doug Hunter 8670 Terrada Drive Knoxville, TN 37931  
 Nikki Campbell 8672 Terrada Drive Knoxville TN 37931  
 Rosie Souma 8675 Terrada Dr; Knox, TN 37931  
 Brooke Johnson 8671 Terrada Dr. Knox, TN 37931  
 Jason Shum 8673 Terrada Dr. Knox TN 37931  
 Summer J 8673 Terrada Dr. Knox. TN 37931  
 Adam Sullivan 8617 Royal Oaks Drive 37931  
 DAVID Sullivan 8613 Royal Oaks Drive 37931  
 R. Ief Williams 8612 Royal Oaks Dr 37931  
 Alice Williams 8612 Royal Oaks Dr 37931  
 Berniece Beardow 3212 Byington - Beaver Ridge 37931  
 Rodney W. Moore 3120 Byington Beaver Ridge 37931

Home owners / citizens against rezoning property:

2613 Gray – Hendrix Road from agricultural to industrial for proposed building of an office warehouse by “Fuller Group”.

Date submitted to MPC

Please sign name & address:

<u>Name</u>	<u>Address</u>	<u>Phone (optional)</u>
Peggy Bahinger	6921 W. Emory Rd.	
Bill Bahinger	6921 W. Emory Rd.	
Chris Stone	3000 Emory Rd.	
Gene Everett		
Barbara Everett		
Tom Johnson	2921 Byington/Bene Ridge Rd.	
Jill H.	3221 Boomerang Cr.	
Marilyn Markle	7917 Wilnoty Drive	37931
Katie Cagley	4809 Guinn Rd.	Knox.TN 37931
Matt Jackson	3801 Riverdrive	Knox.TN 37931
Dusty Eynold	7336 oak Ridgeway	Knoxville TN 37931



Home owners / citizens against rezoning property:

2613 Gray – Hendrix Road from agricultural to industrial for proposed building of an office warehouse by “Fuller Group”.

Date submitted to MPC

Please sign name & address:

	<u>Name</u>	<u>Address</u>	<u>Phone (optional)</u>
17	Kathy Roach	2713 Hodge Rd	
18	Kathleen Vayles	2712 Byington Beaver Rd.	
19	Ali K. Hook	2713 Hodge Rd.	
20	Charles Drain	2718 " "	
21	Billy Harne	2718 " "	
22	Ronnie Penland	2713 Hodge Rd.	
23	Elaine Stapleton	2700 Hodge Rd	
24	<del>Codee</del>	Hodge Rd	
25	<del>Jenny Hlave</del>	Hodge Rd.	
26	James G. Freshour Sr.	Byington Beaver Ridge	
27	<del>Jean C. Freshour</del>	Byington Beaver Rd	
28	<del>Sonya Stooksburg</del>	7602 Blacks Ferry Rd Knox 37931	
29	<del>J. David Hooker</del>	7602 Blacks Ferry Rd. Knox 37931	
30	<del>Wanda B. Smith</del>	Greywolf Dr Knox	
31	<del>_____</del>		
32	<del>Cathy Stooksburg</del>		
33	<del>Steven Stooksburg</del>		
34	<del>MPC May 10, 2007</del>	Hodge Rd.	
35	<del>CA Hendrix</del>	Hodge Rd.	

**Home owners / citizens against rezoning property:**

**2613 Gray – Hendrix Road from agricultural to industrial for proposed building of an office warehouse by “Fuller Group”.**

**Date submitted to MPC**

**Please sign name & address:**

<u>Name</u>	<u>Address</u>	<u>Phone (optional)</u>
Jack Bloomer	7309 Oxmoor	216-9088
Louise Bloomer	“	
Jean Whitaker	7324 Ball Camp Pike	
J.J. Whitaker	“ “ “ “	
[Redacted]	[Redacted]	[Redacted]
Loe Dailey	2506 Gray Hendrix Rd.	690-2880
Rose Whited	1210 Wilkenson Rd.	
Sherry Powell	Joy Ln.	
Chris Powell	Joy Ln.	
Joyce Ellis	4772 Meredith Rd.	938-8319
Florence Cavington	“ “ “ “	“ “ “ “
Linda Fay Wallace	Lovelace Rd	
Halbert Wallace	Lovelace Rd	
Dora Hickey	Lovelace Rd	
Calvin Hickey	Lovelace Rd	
Marti Hickey	Lovelace Rd	
Kenneth Troutman	Byington + Sewly Rd	
Juanita Troutman	Byington + Sewly Rd.	

Home owners / citizens against rezoning property:

2613 Gray – Hendrix Road from agricultural to industrial for proposed building of an office warehouse by “Fuller Group”.

Date submitted to MPC

Please sign name & address:

<u>Name</u>	<u>Address</u>	<u>Phone (optional)</u>
James Voyles	8516 GARRISON DR.	690-2908
Karl Allen	2717 Roland LN	531-5697
Sammy Huskey	2700 Roland LN	560-9832
Dennis Depp	2516 Gray Hendrix Rd	824-9340
Jerry Depp	2516 Gray Hendrix Rd.	824-9340
Jim Cot	2818 " " "	690-1680
Bj Cot	2818 Gray Hendrix Rd.	690-1680
M.E. Way	2377 Bryant Ln	693-4158
Larry Edsell	11926 Couchmill Rd	694-6077
Paul Wright	1217 Reston Ct -	680-6902
J.D. R. Smith	2908 Gray Hendrix Rd	671-3812
John Astor	10,000 West Emory Rd.	640-5055
[Signature]	2001 BLUE MEADOW LANE	693-7407
John T. Smith	9627 Emory Rd	690-2820
Martha C. Dailey	2500 Hendrix Rd.	670-9632
[Signature]	2502 Gray Hendrix Rd	690-3680

Home owners / citizens against rezoning property:

2613 Gray - Hendrix Road from agricultural to industrial for proposed building of an office warehouse by "Fuller Group".

Date submitted to MPC

Please sign name & address:

<u>Name</u>	<u>Address</u>	<u>Phone (optional)</u>
Dannio D. Coffey	2512 Grayhendrix Rd.	539-1096
James R. Dailey	2506 Gray Hendrix Rd.	690-2880
James R. Edsell	2006 ELIZA GLENN- 1A1N KNOX - TENN- 37921	
Dwight Flynn	5917 Ball Road Knoxville, TN 37931	690-3041
Kevin Crigger	6024 Starhurst Dr. Knoxville, TN 37921	254-5571
Joe Dailey	8512 Garrison Rd Knox. In 37931	
Jackie Dailey	8512 Garrison Knox. In 37931	
Pick Dailey	244 Byington Solway Rd Knoxville 37931	
Tony Wright	2436 Byington Solway Rd Knoxville 37931	
Stephanie Wright	2436 Byington Solway Rd Knoxville 37931	
Jack McReynolds	9319 Garrison Rd. Knoxville 37931	
John Wmence	9928 Tinsmith Way Knoxville, TN 37931	692-0499

Home owners / citizens against rezoning property:

2613 Gray – Hendrix Road from agricultural to industrial for proposed building of an office warehouse by “Fuller Group”.

Date submitted to MPC

Please sign name & address:

<u>Name</u>	<u>Address</u>	<u>Phone (optional)</u>
Pam M. Robertson	2701 GRAY HENDRIX	(865) 947-0354
Eric Robertson	" "	(865) 567-0975
Sham Roberts	" "	(865) 567-6576
Jan Shannon	3229 Shady Oak	865 690-2587
Ann Scarborough	3025 Shady Oak Ln.	
James Peater	3217 Shady Oak Ln	694-5979
Michelle McCauley	3216 Shady Oak Ln	691-4811
Wayne Naessig	3208 Shady Oak Lane	690-5125
Barbra Naessig	Knoxville, TN 37931	
Ricky Patterson	8524 Boss Rd.	
Darlene Ritzsell	8520 Boss Rd.	690-7726
John Ritzsell	8520 Boss Rd	690-7726
Georgia West	8519 Boss Rd	694-8695
John West	8519 Boss Rd	621 8875
Brenda Moore	8515 Boss Rd	691-1474
Chris Bailey	8505 Boss Rd.	951-0491
Imogene R Cox	8313 Boss Rd	690-2780
Mildred Davis	8304 Boss Rd	960.6996
Margie Denton	8300 Boss Rd	
Hugh Denton	8300 Boss Rd	

- 19 Larry and Susan Hutzell 4628 Edgedale
- <sup>20</sup> 21 Patricia Felber 3336 Cliffbranch Lane
- 22 Susame Green 10026 W. Emory Rd. 37931
- 23 Sue Herron W. Gallaher
- 24 Alvin Kinnon
- 25 Anna Vaughn Sam Lee Rd
- 26 Nancy O'Keefe
- 27 Paula Scrimer
- 28 Donna Ellstrom 3622 Laurel Oak Ln. 37931
- 29 Paul Ward 3013 Bakertown Rd. Knoxville Tn 37931
- 30 Connie Miller, 2720 Georg Miller Rd., Knox, TN
- 31 Kgw E Miller " " " " " "
- 32 Kim Harrison 1106 Andrewbrook Ln. Knox, TN 37923
- 33 Cindy Bault - 7032 Castlewood TN, Knox TN 37931
- 34 Jerry Shackberry, Jr. Williams Rd.

Home owners / citizens against rezoning property:

2613 Gray – Hendrix Road from agricultural to industrial for proposed building of an office warehouse by “Fuller Group”.

Date submitted to MPC

Please sign name & address:

<u>Name</u>	<u>Address</u>	<u>Phone (optional)</u>
1 Anne Anderson	7105 Regency Rd Knox, TN	
2 Dianna Nelson	2905 Williams Rd	
3 Mary C. Francis	3234 W. GALLATHER Ferry Rd	
4 Janet Stooksbury	Knox - 379.32 2911 Williams Rd.	
5 Peggy Bouten	6264 Heatherbrook Dr	
6 Joyce Bruce	8609 Dolph Drive	
7 Jane Sygen	7105 Regency Rd	
8 Rick Nisell	7115 Lavender Ln	
9 Betty McBord	7914 Gleason W.	
10 Susan Melton	7209 Regency Rd	
11 Norma Moore	7204 Della Dr.	
12 Jama Detsen	7521 Brittany Dr.	
13 Wilburn Mays	Regency Rd.	
14 Carolin Kelena		
15 Charles White	3436 Ashworth Rd	
16 Rhonda Gordon	721 Oak Ridge Hwy	
17 Brenda Williams	- 7610 Blackberry Rd.	
18 Angela Leach	7610 Blackberry Rd	

**Home owners / citizens against rezoning property:**

**2613 Gray-Hendrix Road from agricultural to industrial for proposed building of an office warehouse by "Fuller Group".**

**Date submitted to MPC**

**Please sign name & address:**

<u>Name</u>	<u>Address</u>	<u>Phone (optional)</u>
Kenneth Smith	1921 Wiebels Dr	578-3221
Krista Crawford	2600 Brownvale Rd	691-3963
Barbara Shepley	2600 Brownvale	691-3963
Hazel Whitacre	8000 Wilnoty	691-4117
Raymond Brown	8000 Wilnoty	237-2074
Sonia Harper	8029 Wilnoty	539-6354
Christina J. Plummer	8105 Wiebels Drive	936-3330
Lois	8106 Wiebels Dr.	560-1602
Amy Landrus	551 Lost Tree Ln.	9539-0289
Mary Garratt	700 Kimbee Road	690-4009
Angela Inman	10515 Plum Creek Dr.	966-6659
Paul Chazars	874 Shoreham Blvd	8056225
Kim Blankenship	11216 Couch Mill Rd.	927-1516
Jennifer Kennedy	10810 Stable Run Dr	809-4527
Pat Nis	6749 Heatherbrook Dr.	
Tim Kelly	12012 RIDGELAND DR	671-4063



Home owners / citizens against rezoning property:

2613 Gray – Hendrix Road from agricultural to industrial for proposed building of an office warehouse by “Fuller Group”.

Date submitted to MPC

Please sign name & address:

<u>Name</u>	<u>Address</u>	<u>Phone (optional)</u>
Mary Walker Curtis Walker	2715 Byington- Beaver Ridge Rd Knoxville, TN 37931	690-3087
Daniel W. Staetzel	8101 Boss Rd.	539-6568
Hans Wolfenbarger	7921 Boss Rd.	531-3986
Carole Wolfenbarger	7921 Boss Rd	531-3986
James F. Masey,	2408 Rowena Ln.	690-2586
Rubens Parnis	2713 Roland Ln	693-3215
Tammy Akard	2717 Roland Ln	531-5097
Douglas R Parnish	2713 Roland Ln	693-3215
Mary G. Houser	2716 Roland Ln.	690-0987
Ellen R. Houser	7029 Hamell Rd.	947-9761
Steven R. Fann	2720 Roland Lane	690-8225
Randy Sutherland w/ Butter	7204 Old Blacks Ferry Rd	938-0030 690-1288
Sarah Doak	114 Lansdowne Dr	690-2781

Home owners / citizens against rezoning property:

2613 Gray – Hendrix Road from agricultural to industrial for proposed building of an office warehouse by “Fuller Group”.

Date submitted to MPC

Please sign name & address:

<u>Name</u>	<u>Address</u>	<u>Phone (optional)</u>
Britton Butler	9628 Shirley Couch Way, Knoxville, TN 37931	
Sherry Curtis	2608 Grey Hendrix Rd Knoxville TN 37931	865-696-5112
Cyndi Butk	2102 Andes Rd Knoxville TN 37931	865 692-0014
Michael Medina	409 E Oak Hill Ave Knoxville, TN 37912	
Ed Butler	8604 Scrimshaw Rd Knox. 2 37931	
Jim Butler	2102 Andes Rd Knoxville TN 37931	
Kristen Morgan	2801 Gray Hendrix Rd Knoxville TN 37931	
Thomas Whitza	6321 Beaver Ridge Rd 37931	

36 - Osud Swann	Hodge Rd.	K.T.
37 Vivian Swanner	Hodge Rd	K.T.
38 Georgia Lee	Hodge Rd	KT.
39 Susan L. Shular	2716 Hodge Road,	Knoxville,
40 Gary L. Shular	2716 Hodge Road	TN 37931
41 Matthew Shular	" "	"
42 Mary L. Chapman	2705 Hodge Rd	
43 Jerry Dorsey	" "	"
44 J. J. [Signature]	" "	"

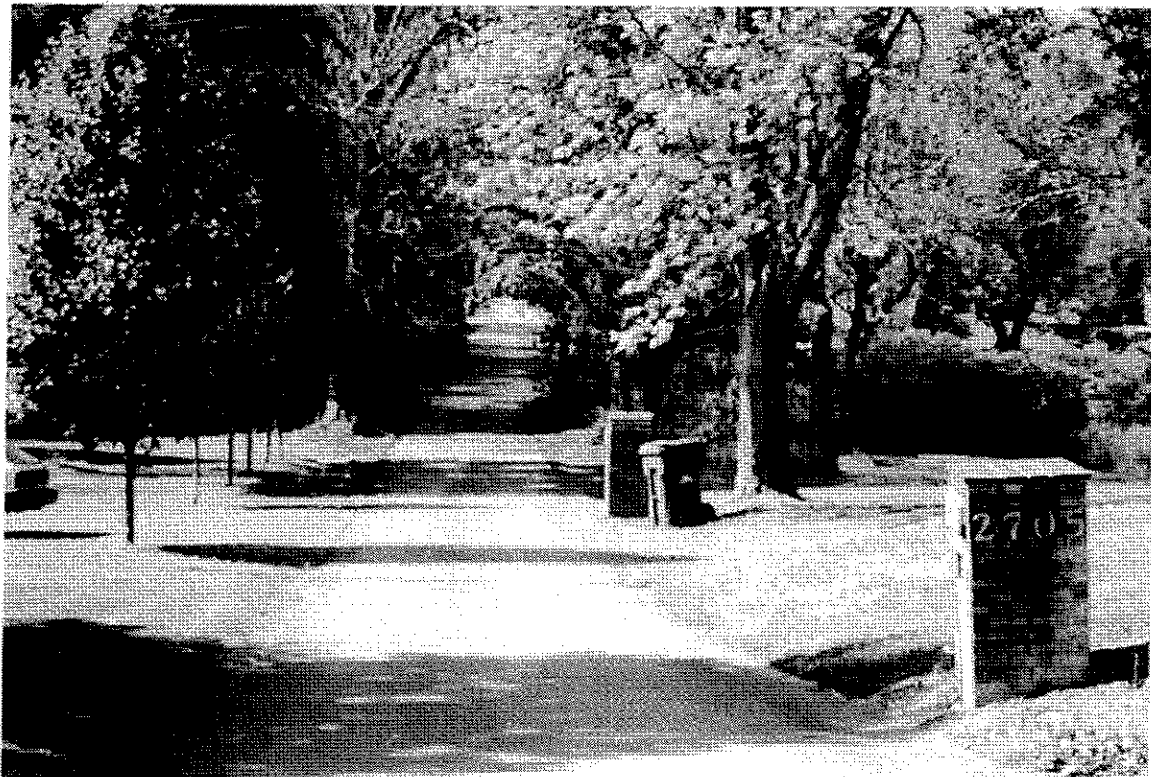
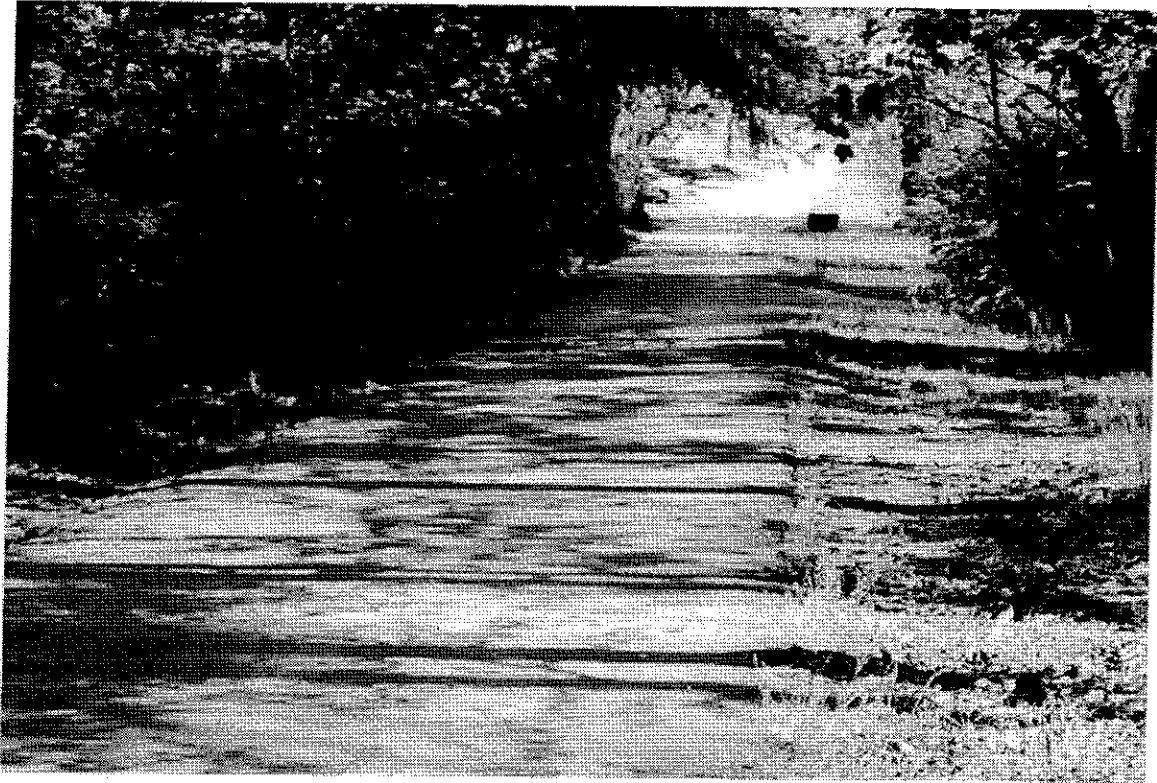

MPC May 10, 2007

5-M-07-R2/  
5A-07 Agenda Item # 82

