



**KNOXVILLE/KNOX COUNTY METROPOLITAN PLANNING COMMISSION
USE ON REVIEW REPORT**

▶ **FILE #:** 9-E-07-UR

AGENDA ITEM #: 86

AGENDA DATE: 9/13/2007

▶ **APPLICANT:** DOLLAR & EWERS ARCHITECTURE, INC. BRIAN EWERS

OWNER(S): PHILIP J. & MARY A. DANIEL

TAX ID NUMBER: 49 02302

JURISDICTION: County Commission District 7

▶ **LOCATION:** Southwest side of Fountainhead Ln., northwest of Lindsey Blair Ln. and Tazewell Pike.

▶ **APPX. SIZE OF TRACT:** 4.67 acres

SECTOR PLAN: North City

GROWTH POLICY PLAN: Urban Growth Area

ACCESSIBILITY: Access is via Fountainhead Ln., a local street with a 26' pavement width within a 50' right-of-way.

UTILITIES: Water Source: Knoxville Utilities Board

Sewer Source: Knoxville Utilities Board

WATERSHED: Whites Creek

▶ **ZONING:** RA (Low Density Residential)

▶ **EXISTING LAND USE:** Residence

▶ **PROPOSED USE:** After school day care program for up to 99 students

HISTORY OF ZONING: None noted

SURROUNDING LAND USE AND ZONING: North: Vacant land / PR (Planned Residential)

South: Residences / PR (Planned Residential)

East: Residences / PR (Planned Residential)

West: Vacant land / RA (Low Density Residential)

NEIGHBORHOOD CONTEXT: The site is located in an area along Tazewell Pike that has developed with a mix of low density residential housing.

STAFF RECOMMENDATION:

▶ **APPROVE the request for a after school day care program for up to 99 children at this location subject to the following 5 conditions**

1. Meeting all applicable requirements of the Knox County Health Department.
2. Meeting all applicable requirements of the Tennessee Department of Education.
3. Installing a type "A" landscape screen (see attachment) around the fenced enclosure for the outdoor play area within six months of issuance of occupancy permit for the project.
4. Meeting all applicable requirements of the Knox County Department of Engineering and Public Works.
5. Meeting all applicable requirements of the Knox County Zoning Ordinance.

With the conditions noted above, this request meets all requirements of the RA (Low Density Residential)

zoning district, as well as other criteria for approval of a use on review.

COMMENTS:

The Smithwood Learning Center is proposing to locate to this 4.67 acre site and operate a school and after school day care program. The Smithwood Learning Center is regulated by the Tennessee Department of Education (see attached correspondence) and not by the Tennessee Department of Human Services as is the case for a day care center. Under the Knox County Zoning Ordinance, a school is a permitted use within the RA (Low Density Residential) zoning district. Since the after school day care program will serve up to 99 children from the Shannondale and Fountain City Elementary Schools it was determined that the after school program would require a use-on-review approval.

The proposed site for the facility is an existing residence on 4.67 acres located off of Tazewell Pike. Access to the site is from Fountainhead Ln., a local public street that also serves Fountainhead Condominiums which are located on the south and east sides of the project site. Fountainhead Condominiums were approved by the Planning Commission in 2003 for a total of 51 attached residential units. While not a part of the 2003 approval, the site plan for the condominiums identified additional units proposed on the north side of the project site.

The proposed after school day care facility will serve an enrollment of up to 99 children with a maximum of 12 teachers. The existing building will have approximately 3500 square feet of indoor play area for the children. A 25,000 square foot fenced in outdoor play area is also provided. The site far exceeds the minimum requirements of the zoning ordinance for a day care facility.

EFFECT OF THE PROPOSAL ON THE SUBJECT PROPERTY, SURROUNDING PROPERTIES AND THE COMMUNITY AS A WHOLE

1. To help reduce the noise impact from the outdoor play area, Staff is recommending a condition that a type "A" landscape screen (see attachment) be installed around the fenced enclosure for the outdoor play area.
2. Public utilities are available to serve the development.
3. While the average daily trips for a day care facility of this size is estimated at 272, the actual trips should be a lot less since the children will be bused to the site after school.

CONFORMITY OF THE PROPOSAL TO CRITERIA ESTABLISHED BY THE KNOX COUNTY ZONING ORDINANCE

1. The proposed day care facility is consistent with the general standards for uses permitted on review: The proposed development is consistent with the adopted plans and policies of the General Plan and Sector Plan. The use is in harmony with the general purpose and intent of the Zoning Ordinance. The use is compatible with the character of the neighborhood where it is proposed. The use will not significantly injure the value of adjacent property.
2. The proposal meets all requirements for approval of a day care facility in the RA (Low Density Residential) zoning district.

CONFORMITY OF THE PROPOSAL TO ADOPTED MPC PLANS

1. The North City Sector Plan proposes low density residential uses for this area. The Knox County Zoning Ordinance allows schools as a permitted use within the RA zoning district and allows consideration of child day care facilities.
2. The site is located within the Urban Growth Area of the Knoxville-Knox County-Farragut Growth Policy Plan.

ESTIMATED TRAFFIC IMPACT 272 (average daily vehicle trips)

Average Daily Vehicle Trips are computed using national average trip rates reported in the latest edition of "Trip Generation," published by the Institute of Transportation Engineers. Average Daily Vehicle Trips represent the total number of trips that a particular land use can be expected to generate during a 24-hour day (Monday through Friday), with a "trip" counted each time a vehicle enters or exits a proposed development.

ESTIMATED STUDENT YIELD: Not applicable.

MPC's approval or denial of this request is final, unless the action is appealed to the Knox County Board of Zoning Appeals. The date of the Knox County Board of Zoning Appeals hearing will depend on when the appeal application is filed. Appellants have 30 days to appeal an MPC decision in the County.

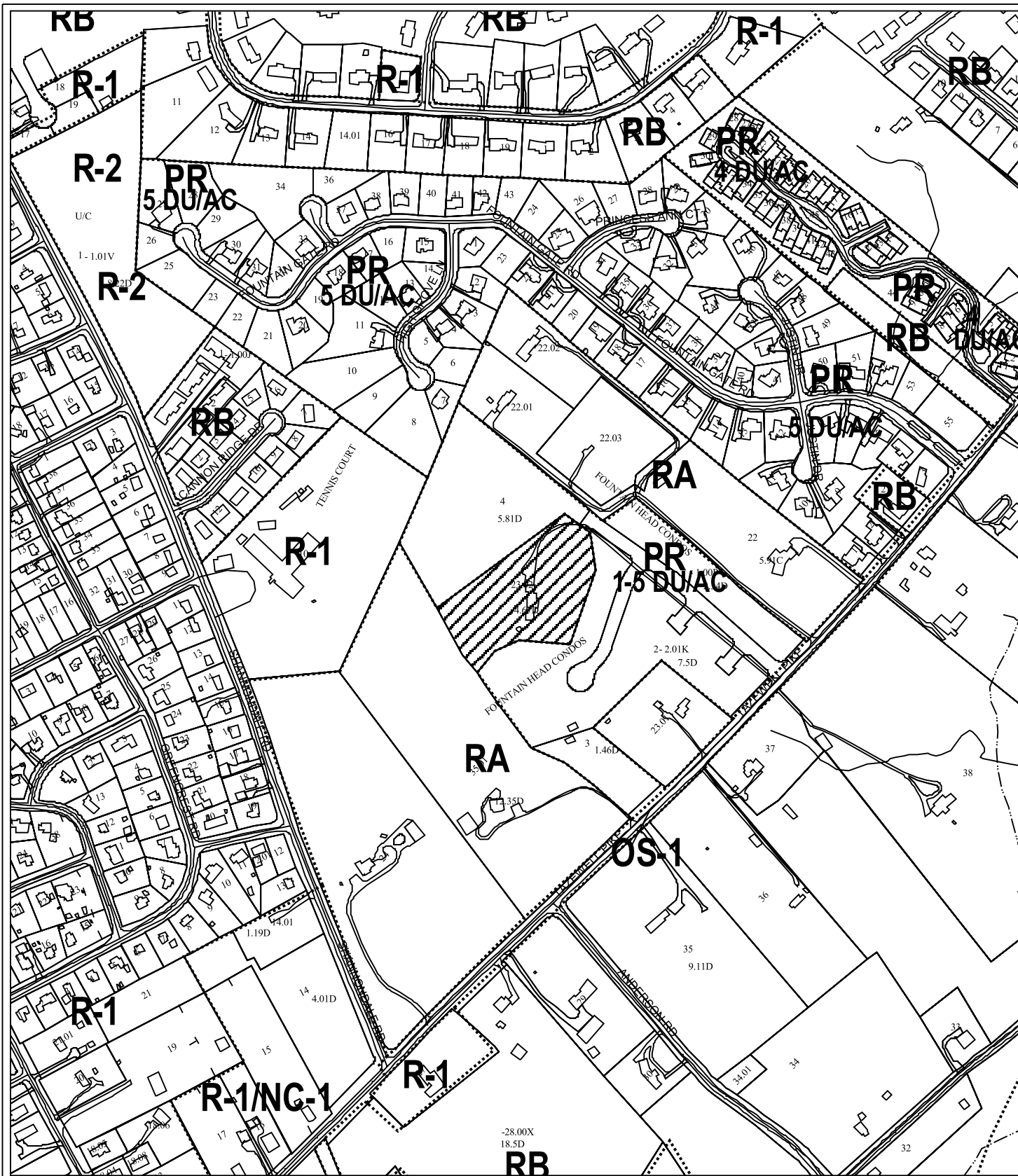

9-E-07-UR
 USE ON REVIEW



After school day care program for up to 99 students in RA (Low Density Residential)

Original Print Date: 08/28/07 Revised:
 Metropolitan Planning Commission * City / County Building * Knoxville, TN 37902

Petitioner: Dollar & Ewers
 Architecture, Inc.
 Map No: 49
 Jurisdiction: County



DAY CARE REVIEW

Case No. 9-E-07-UR

Applicant Dollar & Ewers Architecture, Inc, Brian Ewers

ZONING ORDINANCE REQUIREMENTS (Article 4, Section 4.91)

• **Minimum Lot Size**

Required: 10,000 sq. ft.

Request: 4.67 acres

• **Minimum Size for Fenced Outdoor Play Area**

Required: 10,400 sq. ft. sq. ft. (2500 sq. ft. for first 20 children; 100 sq. ft. per each additional child)

Request: 25,000 sq. ft. sq. ft.

• **Minimum Building Area**

Required: 2970 sq. ft. 30 square feet per child

Request: 3437 sq. ft. sq. ft.

• **Minimum Off-Street Parking (Article 3, Section 3.50)**

Required: 8 teacher/employee spaces (two (2) parking spaces per three (3) teachers and employees)

13 off-street loading spaces (one (1) off-street loading space per eight (8) pupils)

Request: 8 teacher/employee spaces

13 off-street loading spaces

GUIDELINES LANDSCAPE SCREENING

DESIGN

Type "A" Screen: Dense

APPROPRIATE LOCATION: Boundaries of commercial and industrial developments adjoining residential areas

NOTE: Landscape buffer strips should be a minimum of 15 feet in width, and sown with grass or ground cover for their full width, allowing for mulch at the base of plantings.

- Two offset rows of deciduous or evergreen canopy trees with a 6 ft high continuous dense evergreen hedge fence wall or earth berm

TREE HEIGHT
Installed: 8 ft.
Mature: 40 ft.

SHRUB HEIGHT
Installed: 4 ft.
Mature: 6 ft.

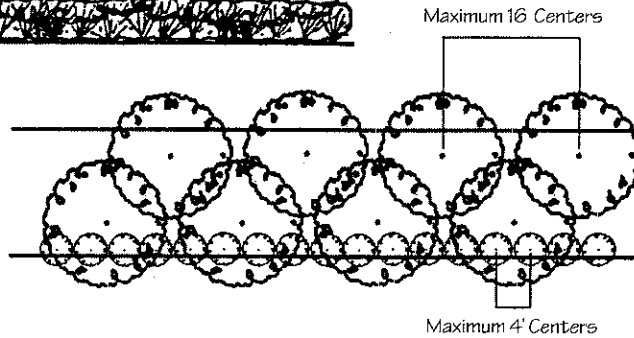

- Two offset rows of evergreen trees with branches touching the ground

TREE HEIGHT
Installed: 8 ft.
Mature: 30 ft.

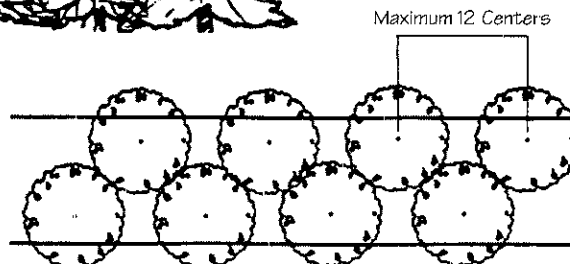
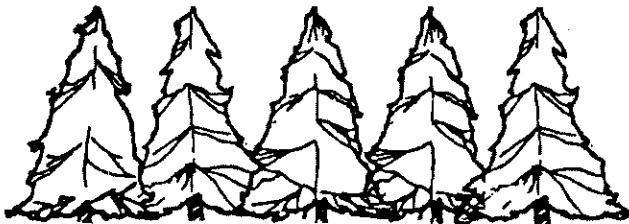

INTRODUCTION

Landscape screening reduces the impact of intense development upon adjacent land uses by providing visual separation, reducing the transmission of glare and air pollution, and limiting access. Screening also promotes the aesthetic appeal of a neighborhood and promotes higher property values.

This series of design guidelines defines several types of landscape screen. Each type is applicable to a certain intensity of conflict between adjacent land uses. Each screen type is illustrated by several planting schemes with an equivalent height, density and opacity of landscaping.

MPC uses these guidelines to illustrate desirable levels of screening appropriate to various site planning situations. Creative alternatives which achieve a comparable effect are encouraged.

For more information:

MPC
Development Services
Suite 403
City County Building
400 Main Street
Knoxville, TN 37902
Phone: 865 215-2500
Fax: 865 215-2068
Web: www.knoxmpc.org

The contents of these guidelines are advisory and are intended to supplement, but not replace, the requirements of the Knoxville Zoning Ordinance and the Knox County Zoning Ordinance.

9-E-07-UR

August 31, 2007

Ms. Emily Lasher, Director
Smithwood Learning Center
3203 Tazewell Pike
Knoxville, TN 37912

Dear Ms. Lasher:

This letters serves as confirmation that Smithwood Learning Center is approved by the Department of Education. Our department oversees the preschool and after school programs at Smithwood. If more information is needed please feel free to contact me at (865)594-6044 ext. 114.

Sincerely,



Cynthia Templin, Program Evaluator



STATE OF TENNESSEE
DEPARTMENT OF EDUCATION
 6th FLOOR, ANDREW JOHNSON TOWER
 710 JAMES ROBERTSON PARKWAY
 NASHVILLE TN 37243-0375

PHIL BREDESEN
 GOVERNOR

LANA C. SEIVERS, Ed.D
 COMMISSIONER

September 19, 2006

Emily Lasher
 Smithwood Learning Center
 3203 Tazewell Pike
 Knoxville, TN 37918

Dear Ms. Lasher:

This office has been notified by the Office of School Approval that Smithwood Learning Center is now recognized as a Category V school. It is our understanding that the Learning Center will enroll students preK - 1st grade and will be administering a before and after school program. As a school the preschool and the school-age care programs administered by Smithwood Learning Center would be school-administered and fall under the jurisdiction of the Department of Education.

All infant/toddler, preschool, pre-kindergarten and school-age care programs offering more than fifteen hours of care per week must be in compliance with child care rules and regulations. The School-Administered Child Care Rules, Chapter 0520-12-1, are available to download from the Secretary of State's website at www.state.tn.us/sos/rules/0520/0520-12/0520-12-01.pdf. If you need a hard copy of these rules, please contact this office.

All pre-kindergarten programs seeking approval as an educational program must be in compliance with Chapter 0520-1-3-.05(5) available at the Secretary of State's website www.state.tn.us/sos/rules

The Tennessee Department of Education has been responsible for monitoring for compliance with child care rules certain public school administered early childhood education and child care programs; and child care programs affiliated with private, church related schools as defined by T.C.A. § 49-50-801 since 1989.

The Child Care Reform Law adopted by the Tennessee General Assembly in 2000, expanded the programs to be monitored by the Department to include all public school administered programs including Title I funded preschools, all school-administered Head Start programs and state approved Montessori school programs.

In 2002 the General Assembly adopted Chapter No. 766 of Public Acts. Chapter No. 766 of Public Acts, 2002 amended the Department of Education portion of the Child Care Law to give the Department of Education responsibility for monitoring for compliance with child care standards all programs operated by private schools as defined by T.C.A. §49-6-3001(c)(3)(A)(iii). In short all infant/toddler programs, preschool programs and school-age before and after school programs administered by public or private schools are to be inspected by the Department of Education for compliance with child care standards.

The purpose of this letter is to introduce you to the Office of School-based Support Services which is responsible for implementation of the Child Care Law within the Department of Education.

05-0894 (Rev. 6-05)

9-E-07-UR 2

The inspections for compliance with child care standards and technical assistance are provided by the Department of Education's Child Care Consultants: Gail Anderson, Billy Benton, Meg Hall, Becky Hollingsworth, Judy Howard, Lois Madison, Dan Leonard, Annabel Mainord, Allison Miller, Jennifer Patrick, Ursula Price, Linda Solina, Brenda Speice, Jerri Tuten, and Chandra White. The Director of Early Childhood, Connie Casha, and Early Childhood Education Consultants, Sondra Dade, Cheryl Coffman, Jamie Flatt, Wendy Home, Kim McFall, and Sharon Waterfield, provide additional consultation specific to early childhood education (pre-kindergarten) programs

The State Board of Education School-Administered Child Care Rules, Chapter 0520-12-1, were promulgated by the Department of Education in accordance with the Child Care Law, Tennessee Code Annotated, Section 49-1-302(1)(2)(B) "The regulations shall provide equivalent protection for the health, safety and welfare of children, and shall use the same criteria for development of such protection as are used by the Department of Human Services and which are set forth in §71-3-502(a)(3). Although the standards and regulations need not be identical in all respects, the standards and regulations shall parallel, in substantial manner, the child care standards and regulations promulgated by the Department of Human Services.

Just as the law calls for standards which parallel Department of Human Services, the law creates some distinct differences between the Department of Education child care rules and the Department of Human Services. The following is a brief summary of distinct differences:

- The Department of Education is mandated to issue Certificates of Approval (not licenses) to those programs in compliance with child care standards.
- The Department of Education conducts a minimum of two inspections within the school year, one announced inspection and one unannounced inspection. Should there be any questions of non-compliance with the child care standards or should any complaints be logged, additional unannounced inspections are conducted.
- Each child care consultant has a large caseload of programs, dispersed throughout large geographic areas. In order to more efficiently complete the annual inspections efficiently and effectively, the inspection process does not occur on the same schedule as the inspections conducted by Department of Human Services' child care licensing staff. School-administered programs, located within specific geographic areas, are inspected within the same timeframe, while the child care consultant is in that specific area. Therefore, the inspections of school-administered programs may be completed in December of one year and the following year the inspection may be completed in October. Basically, compliance with child care standards during a school year earns the program a Certificate of Approval for the following school year.
- Except for new programs, Certificates of Approval are generated and distributed during the summer months, providing school-administered programs with current Certificates of Approval to display for each new school year.
- Criminal Background Checks: Criminal background investigations are required of any person applying for a position as a teacher and any person applying for any other position requiring proximity to school children or to children in a child care program. Fingerprint samples must be submitted to the Tennessee Bureau of Investigation for a criminal history records check. Each school system or private school must work directly with the Tennessee Bureau of Investigation to process the criminal history records check on each employee. The school system or school is responsible for the payment process associated with the criminal history records check. (This does not preclude the school system or school from requiring potential employees to reimburse the school system or school for the costs of the criminal history records check.)
- The Tennessee Bureau of Investigation requires that a "User Agreement" between the requesting agency (school system or school) and the TBI be on file prior to the processing of any criminal history records check. Each public school system has established a "User Agreement" with the TBI following the passage of T.C.A. §49-5-413 in 1999. For private schools to establish a "User Agreement" with the TBI, simply write a letter to the TBI explaining the need to have criminal history records checks completed by the TBI. The content of the letter should refer to the need to comply with T.C.A. § 49-5-413 requiring investigation of applicants for teaching or child care positions. Send the letter to:
Records and Identification Unit

3
9-E-07-UR

Tennessee Bureau of Investigation
901 R. S. Gass Blvd
Nashville, Tennessee 37216

In response to the school's letter, a "User Agreement" packet will be sent to the requesting school. If you have not established a "User Agreement" with the TBI, please make application as soon as possible. When the "User Agreement" is established, the school is assigned a User number, and with that number fingerprints may be submitted for review.

There is an option on the fingerprint submission process. The TBI has established a contract with Cogent Systems for electronic submission of applicant fingerprints. There is an extra fee for electronic submission. Please note: paper card submission of fingerprints continues to be an option, but very slow in processing. Enclosed you will find a copy of the TBI brochure describing Tennessee Applicant Processing Services, TAPS, and a listing of Fingerprinting Centers.

For additional information regarding the TBI and the criminal history records check, you may contact Ronan Harmon, 615-744-4004, or Bobbie Jackovich, 615-744-4287 at the TBI.



For additional information regarding the TBI and the criminal history records check, you may contact Ronan Harmon, 615-744-4004, or Bobbie Jackovich, 615-744-4287 at the TBI.

It is most important that the User Agreement is obtained as soon as possible. A criminal history records check will not be able to be processed until the User Agreement is established. In the meantime, any inspections of programs, recently transferred from the Department of Human Services to the Department of Education, will include a request to see a copy of the school's letter to TBI, requesting a User Agreement packet.

All LEAs should have established a User Agreement with the TBI and new child care programs administered by LEAs should use the established TBI user agreement to process the criminal history background check of early childhood or school-age care programs.

- The Child Care Law of 2000 mandated the development of a rated licensing system and annual report card for programs inspected by the Department of Human Services. As a result the STAR rating system was implemented. The Department of Human Services has agreed that any program, inspected by the Department of Education and wishing to participate in the STAR rating system, may be scheduled for an environmental assessment, ITERS (Infant Toddler Environmental Rating Scale), ECERS (Early Childhood Environmental Rating Scale), and/or SACERS (School-age Care Environmental Rating Scale). To learn more about the STAR Quality assessment, especially the Environmental Rating Scales, please go to <http://tnstarquality.org>. For those programs, participating in the STAR rating system, the Department of Education child care consultants will evaluate the following component areas: Director Qualifications, Professional Development, Compliance History, Parent/Family Involvement, Ratio and Group Size, and Staff Compensation. Should your school wish to participate in the STAR rating program, please notify this office immediately in order to expedite the school's enrollment in the program.
- The 2000 Child Care Law required the State Board of Education to appoint a Child Care Advisory Council to be composed of a director of a local school system, a representative from a private, church-related school organization, a representative of higher education, a parent a coordinator of child care programs, a representative of the Department of Education, a representative of the Department of Human Services Child Care Services, and four other members. The Child Care Advisory Council is responsible for recommending child care rules to the State Board of Education. In addition, the Council serves as the Hearing Board for Appeals for contested enforcement actions taken by the Department of Education against programs found in violation of child care rules. The Department of Education is mandated to use the following enforcement processes for programs operating in violation of child care rules:
 - Restricted certificate: limits the program's authority in one or more areas of operation.

9-E-07-UR

4

- Probation: for not less than 30 days but not more than 60 days for violating child care laws and regulations.
 - Summary Suspension of Approval: suspension of a child care program's certificate of approval if the department determines the health, safety and welfare of children in care is threatened. A hearing must be scheduled within three days of the suspension.
 - Denial or Revocation of Approval: for failure to comply with rules and regulations after reasonable notice of violations.
 - Civil Penalties: levied against programs in violation of child care rules and regulations.
 - Injunctions: filed against a program for operating illegally.
- Rules governing the transportation of children are guided by T.C.A. §49-6-2102. Please refer to the enclosed child care rules for specifics, see the Transportation sections 0520-12-1-06(8).

Special note: Compliance with child care rules is one component of the *Tennessee Early Childhood Education Policy*, adopted by the State Board of Education. For those preschool programs seeking recognition as an educationally approved preschool for three and four year old children and for all public school administered early childhood education/preschool programs, the programs must meet the higher standards as defined in the *Tennessee Early Childhood Education Policy*. The policy is available on the State Board of Education WEBSITE: www.state.tn.us/sbe/Policies/3.100%20Early%20Childhood%20Education.pdf Recognition of a qualifying preschool as an educationally approved preschool will allow licensed teachers to meet the requirements of teacher licensure for certified teachers to claim experience teaching in an approved school.

The adopted learning standards for early childhood education are known as the TN-ELDS, Tennessee Early Childhood Early Learning Development Standards. The standards for children ages birth to five years may be downloaded at www.state.tn.us/education/ci/cistnastards2001/earlychildhood/clearlychidcover.htm.

The child care program evaluator assigned to your region of the state is Dan Leonard. You may reach Mr. Leonard at phone number 865-594-6044, ext 303 or email Daniel.leonard@state.tn.us.

If you have additional questions, please don't hesitate to contact this office, 615-741-0345, FAX 615-532-4989 or email jan.bushing@state.tn.us.

Sincerely,



Jan Bushing
Director, School-based Support Services

c. Dan Leonard

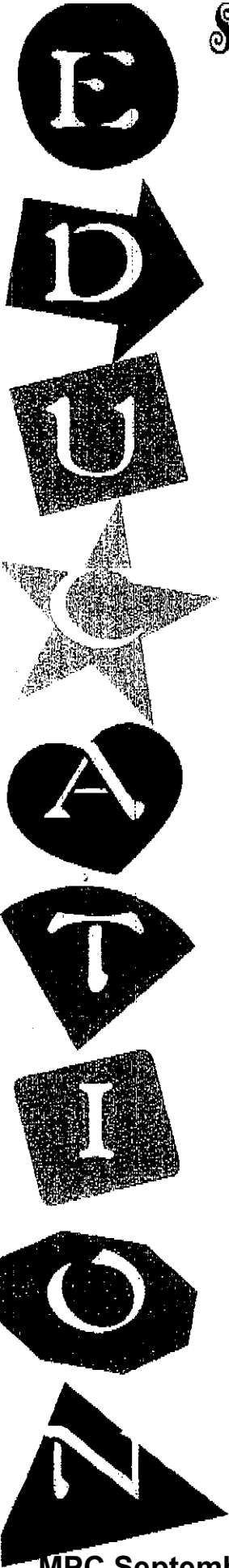

Smithwood Academy & Learning Center

We Dream, We Discover, We Learn

3203 Tazewell Pike

9-E-07-UR

Knoxville, TN 37918

865-687-5589

Hours of Operation:

Smithwood Academy

Monday - Friday

Pre-Kindergarten & Kindergarten

7:00 - 1:00

First Grade

7:00 - 2:30

Smithwood Learning Center

Monday - Friday

Pre-Kindergarten & Kindergarten

1:00 - 6:00

First Grade thru Fifth Grade

2:30 - 6:00

Children's Eye Health and
 Safety Month, Classical Music Month,
 Library Card Month

Sewing Month, Read a New Book Month,
 Chicken Month, Courtesy Month, Honey
 Month, Piano Month, Rice Month

September 2007

9-E-07-UR

Sunday	Monday	Tuesday	Wednesday	Thursday	Friday	Saturday
						1
2	3 Labor Day Closed	4 Skyscraper Day Amazing Skyscraper	5 Courtesy Month Courtesy Acts	6 Read a Book Day & Make it a new one!	7 HandPrint For Grandparent's Day	8
9	10 Breakfast Month Breakfast Foods & Importance	11 Eye Health & Safety Month Safety Activities	12 Library Card Month FIELDTRIP TO LIBRARY	13 Make Peanut Butter for Peanut Butter Day	14 Star Spangled Banner written in 1814 by Francis Scott Key	15
16 World Peace Day	17 Mexico's Independence Day	18 Play-Doh Day	19 Homemade Pudding Day	20 World Peace Day Activities	21 Music Month Musical art Activities	22
23	24 Honey Month Nourishing Nibbles	25 Rice Month Rice Art & Rice Information	26 Johnny Appleseed's Birthday	27 Native American Day Multicultural Activities	28 Chinese Mid-Autumn Festival	29
30						

9-E-07-UR

8-29-07 Wednesday at 10:39 a.m. called Bruce. Got Answering Machine and left a message! He returned my call that same day at 10:45 a.m. Our conversation began by an introduction of myself and the name of our facility. After the introduction, I requested that Bruce set up a meeting with myself so that I could discuss & explain my research and my reasoning behind my belief that we should be categorized as a private school. However he declined my request, stating "it would be a waste of both of our times because if we were going to bus children in from other schools he was going to classify us as a child-care center." I told him that I was aware of his classification and simply asked if I could get his decision on the classification in writing. He then paused and stated "that he could not do that". He stated "that he had not classified us as anything." He said "that in order for him to put his decision in writing I had to first write him a letter stating what my intended use was going to be & what type of operations would be taking place. He also stated that he gave us a permit for a private school. And if we Bused children in we will get a citation."



What are Knox County Codes, Rules, & Guidelines for & why are they not being adhered to?

These are the questions that Smithwood Academy & Learning Center is seeking the answers to. Smithwood Academy & Learning Center has been in operation for 19 years. Smithwood Academy & Learning Center is an elite Early Childhood Private School serving children Pre-K through 1st grade with an integrated educational after school study program that serves children from Shannondale Elementary & Fountain City Elementary. The after school educational study program is designed to promote educational & developmental growth based on individual learning. Smithwood Academy & Learning Center is certified & approved by the Department of Education. Smithwood's lease at their current facility was not renewed in May 2007 due to the addition of multiple programs being offered by Fountainhead College. Therefore, in order for Smithwood to stay in operation a new facility had to be found, preferably in Smithwood Area. As we all are aware, land and facility sites are scarce in this area. However, with a little luck and a lot of searching Smithwood found a facility & purchased it with intent of relocating. The facility purchased is located at 5267 Fountainhead Lane, Knoxville, TN, 37918.

9-E-07-UR

Before purchasing the facility, extensive research was done concerning the zoning ordinance and the requirements associated with the Department of Education, Department of Health, & Department of Safety. The facility purchased is zoned RA (RA Low Density Residential Zone). For the zoning ordinance RA, a school is permitted for use. Therefore, there were absolutely no concerns associated with the zoning of this property. As stated on Page 157 (5.11.02 C) of the Zoning Ordinance from the Knox County's Metropolitan Planning Commissions (MPC) web page www.knoxmpc.org "a private school may be zoned RA" with no need to apply for a use of review. However, during the process of applying for permits to complete necessary construction, the Director of Knox County's Department of Engineering & Public Works has decided to categorize Smithwood Academy & Learning Center as a Child Care Center, not a Private School. As listed on page 159 (5.11.03 C) "a child care center must apply for a use of review with the MPC if planned to locate in a RA zoning ordinance." Therefore, the facility purchased by Smithwood is now going up for a use of review due the categorization finalized by the Director of Knox County's Department of Engineering & Public Works. As documented on Page 13 Article 2 of the zoning ordinance definitions, a Child Care Center is defined as "an agency or organization licensed by the State of Tennessee Department of Human Services to provide care, protection and supervision for 13 or more children in a group center, pre-school, or extended day care facility."

Based on the information stated in the rules & the definitions it is apparent that Smithwood Academy & Learning Center is not a Child Care Center, but rather a Private School with an integrated after school educational program.

So again , the questions being asked are:

What are Knox County Codes, Rules, & Guidelines for & why are they not being adhered to?

Smithwood Academy & Learning Center is scheduled to go in front of the Metropolitan Planning Commission on September 13, 2007. The meeting will be held at 1:30 p.m. in the Main Assembly Room located in the City County Building.