



**KNOXVILLE/KNOX COUNTY METROPOLITAN PLANNING COMMISSION  
CITY OF KNOXVILLE CLOSURE OF PUBLIC RIGHT-OF-WAY**

▶ **FILE #:** 6-A-08-SC

**AGENDA ITEM #:**

**AGENDA DATE:** 6/12/2008

▶ **APPLICANT:** CITY OF KNOXVILLE

TAX ID NUMBER: 95 I B 006  
 JURISDICTION: Commission District 6  
 SECTOR PLAN: Central City  
 GROWTH POLICY PLAN: Urban Growth Area (Inside City Limits)  
 ZONING: C-2 (Central Business District)  
 WATERSHED: First Creek

▶ **RIGHT-OF-WAY TO BE CLOSED:** Clinch Ave.

▶ **LOCATION:** Between James White Parkway and S Hall of Fame Dr

IS STREET:  
 (1) IN USE?: no  
 (2) IMPROVED (paved)?: no

▶ **APPLICANT'S REASON FOR CLOSURE:** To develop with adjoining property and eliminate possible title questions concerning this strip of land.

DEPARTMENT-UTILITY REPORTS: No objections received as of 5/23/08; subject to any required easements

**STAFF RECOMMENDATION:**

▶ **APPROVE the closure subject to any required easements requested.**

This closure will permit the relocation of the City's central public transit facilities to the adjoining property and is needed to meet the public transportation needs of residents within the greater Knoxville area.

**COMMENTS:**

This street right-of-way is not used , or needed for public access to this area

If approved, this item will be forwarded to Knoxville City Council for action on 7/15/2008 and 7/29/2008. If denied, MPC's action is final, unless the action to deny is appealed to Knoxville City Council. The date of the appeal hearing will depend on when the appeal application is filed. Appellants have 15 days to appeal an MPC decision in the City.

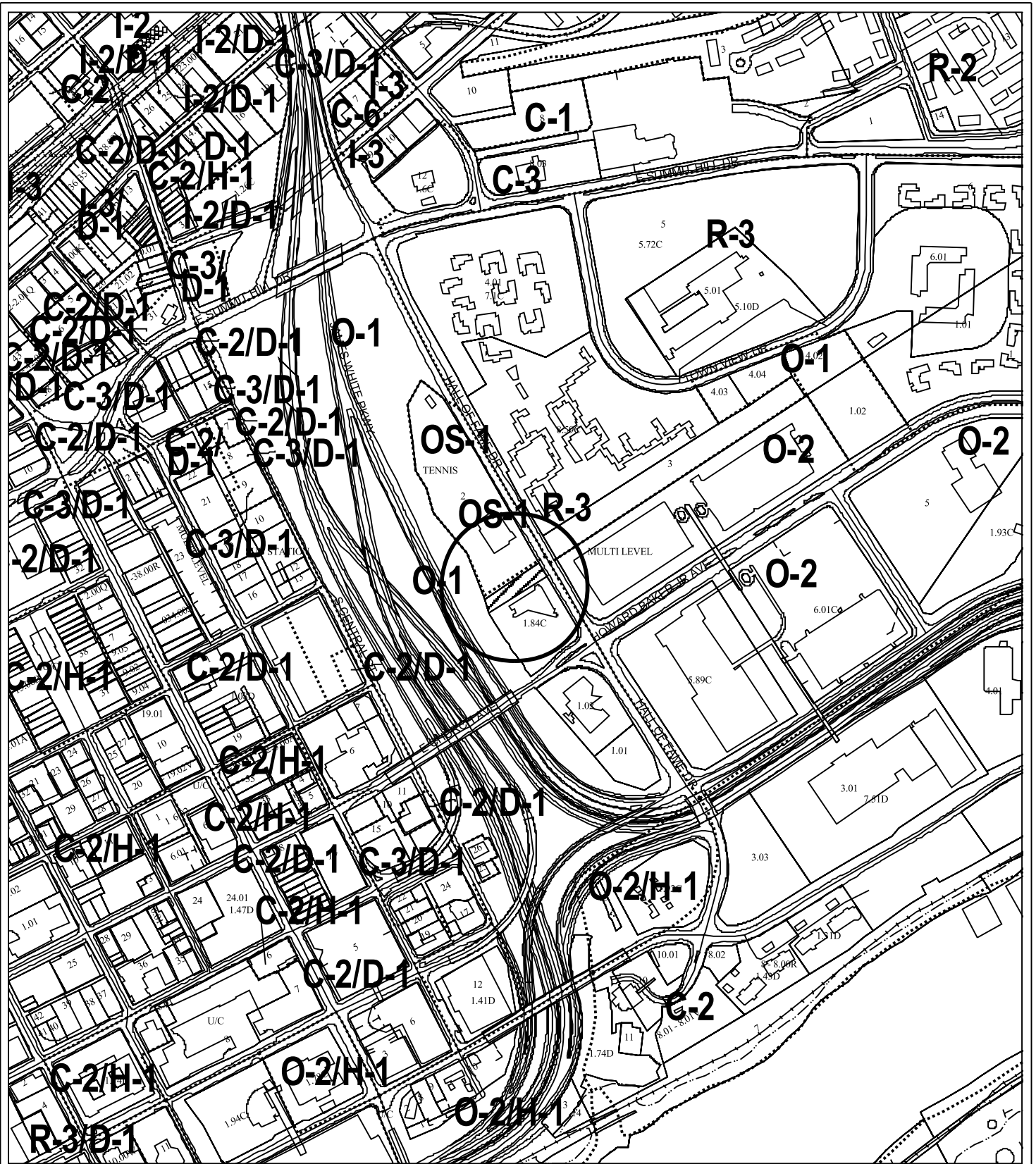

**6-A-08-SC**  
**CLOSURE OF PUBLIC RIGHT OF WAY**

Name of Street or Alley: Clinch Ave.  
 To be closed from: James White Parkway  
 To be closed to : S Hall of Fame Dr

Original Print Date: 05/22/08 Revised:  
 Metropolitan Planning Commission \* City / County Building \* Knoxville, TN 37902

Petitioner: City of Knoxville

Map No: 95

Jurisdiction: City



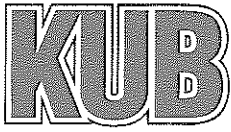

Knoxville Utilities Board



May 19, 2008

Mr. Ken Pruitt  
Knoxville-Knox County  
Metropolitan Planning Commission  
Suite 403, City-County Building  
Knoxville, Tennessee 37902

Dear Mr. Pruitt:

Re: **Right-of-Way Closure Request 6-A-08-<sup>S</sup>CC**

We have reviewed our records and find that we have existing utility facilities located within the subject right-of-way. The approximate location of these facilities is indicated on the attached prints. However, KUB does not release and hereby retains all easements and rights for existing utility facilities, whether or not shown on these prints.

Should this right-of-way be closed, KUB will require the following permanent easement for its utility facility.

- Gas – 12.5 feet on each side of the centerline of the gas line, 25 feet total width
- Water – 7.5 feet on each side of the centerline of the water line, 15 feet total width

So long as these conditions are met, KUB has no objection to the closure of this right-of-way. If you have any questions regarding this matter, please call me at (865) 558-2752.

Sincerely,

Cheryl E. Myers  
Engineering

cem/ggt

Enclosure

Right-Of-Way Closure - Clinch Avenue - Gas - Maintain 25' Easement

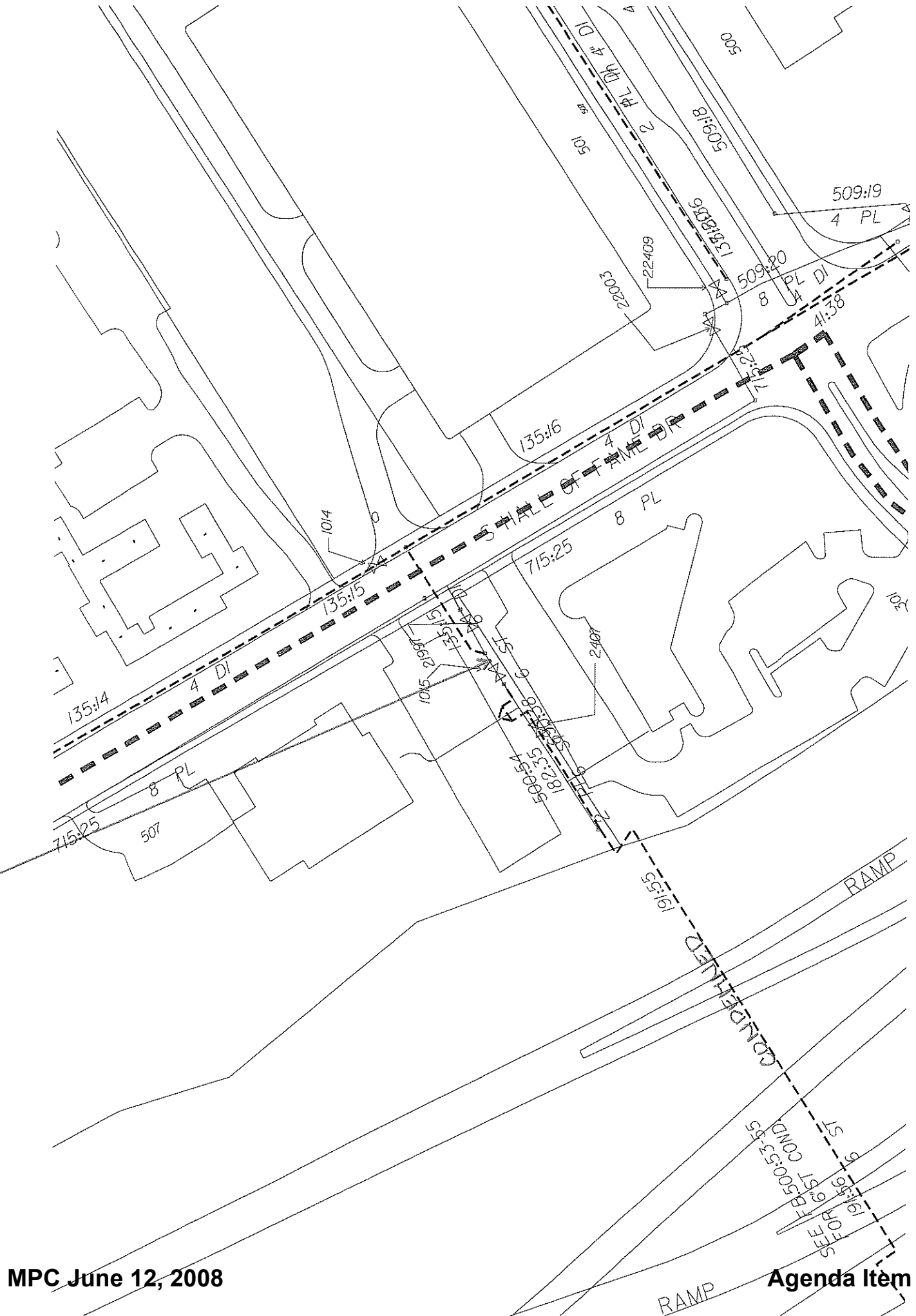

MPC June 12, 2008

Agenda Item # 9

Right-Of-Way Closure - Water - Maintain 15' Easement

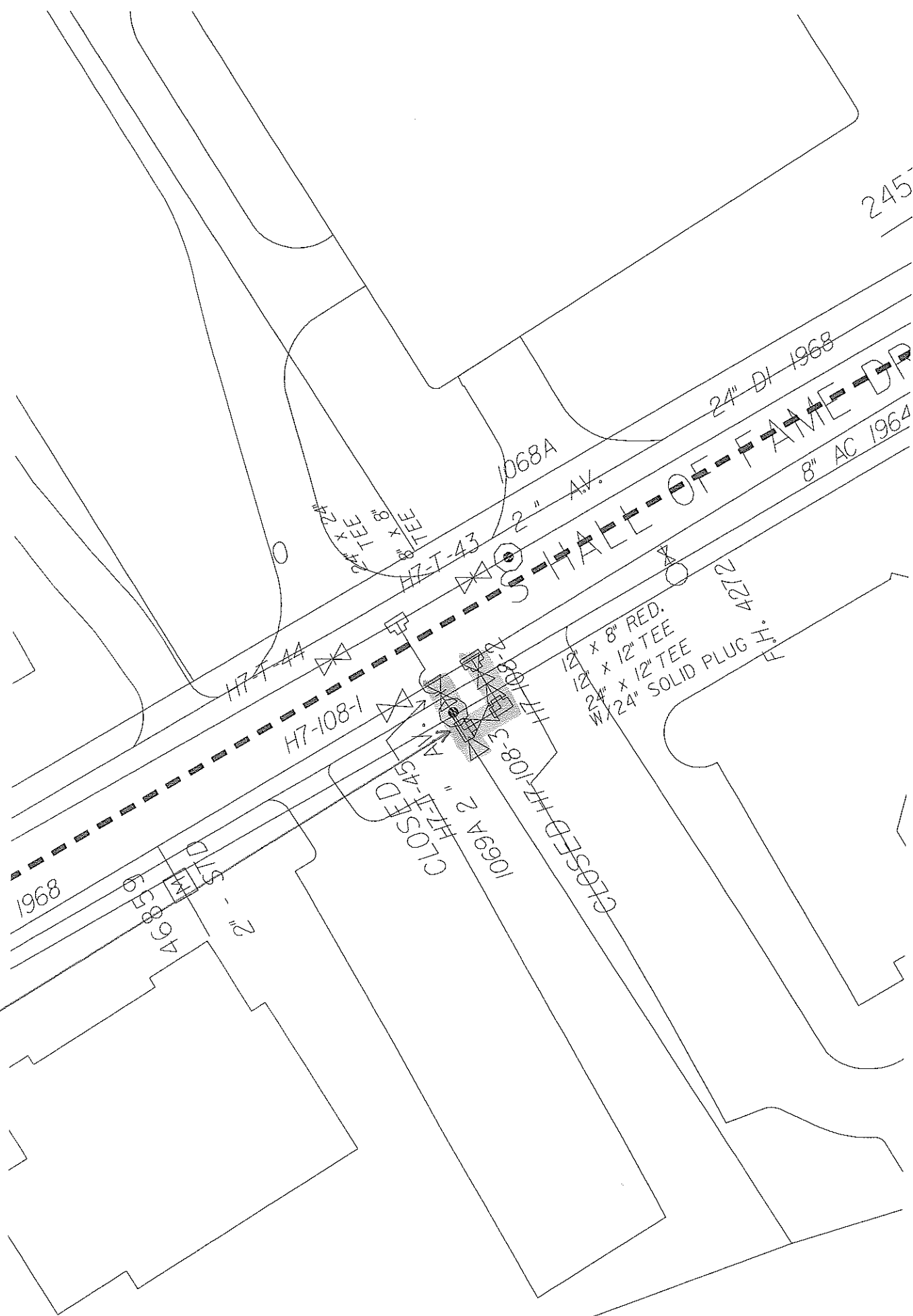

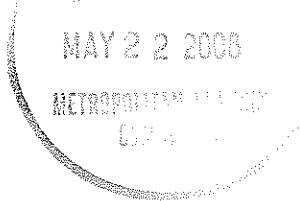

May 19, 2008

TO: Metropolitan Planning Commission

FROM: Walter Primm  
AT&T  
9733 Parkside Dr.  
Knoxville, TN 37922

SUBJECT: CITY OF KNOXVILLE – Closure of Clinch Avenue from James White  
Parkway to S. Hall of Fame Drive Council District 6, Central City Sector  
--6-A-08-CC  
5

AT&T has facilities in this area. The closing will be satisfactory as originally proposed with an easement to maintain and replace our plant as needed in the area in question.

Thank you,

A handwritten signature in cursive script, appearing to read "Walter Primm".

Walter Primm