



KNOXVILLE/KNOX COUNTY METROPOLITAN PLANNING COMMISSION
PLAN AMENDMENT/REZONING REPORT

File #: 7-A-08-MRP

AGENDA #: 48a.
AGENDA DATE: 11/13/2008

APPLICANT: Metropolitan Planning Commission

LOCATION: Loves Creek Road, north of Millertown Pike
TRACT INFORMATION: N/A

PRESENT PLAN DESIGNATION: Local street
PRESENT ZONING: N/A

PROPOSED PLAN DESIGNATION: Major collector street
PROPOSED ZONING: N/A

EXISTING LAND USE: Surrounded by commercially designated and developing commercial parcels zoned SC-3, C-3 and C-6

PROPOSED USE: Commercial development

DATE OF PREVIOUS MPC ACTION: 7/10/2008

PREVIOUS MPC ACTION:

Approved changing Loves Creek Road, north of Millertown Pike to a major collector.

COMMENTS:

Effective as of June 13th of this year, certain provisions of Title 13, Chapter 3 of Tenn. Code Ann. were amended by Public Chapter No. 1150. Specifically, T.C.A. 13-3-303 has been amended to require thirty (30) day publication notice prior to the adoption of any amendment to the General Plan. Previously, there was no statutory notice requirement, and the practice in Knoxville and Knox County has been to provide twelve (12) days publication notice, as is set forth in the MPC Administrative Rules and Procedures.

These requests were previously acted upon by MPC after the effective date of the new rule, and without the required thirty (30) day publication notice. As a result, the previous actions by MPC are not valid.

To rectify this situation, this plan amendment and rezoning request has been readvertized consistent with the 30 day requirement for ratification and reconfirmation of the previous MPC action.

**KNOXVILLE-KNOX COUNTY
METROPOLITAN PLANNING COMMISSION
A RESOLUTION AMENDING THE KNOXVILLE-KNOX COUNTY
MAJOR ROAD PLAN**

WHEREAS, the Knoxville-Knox County Metropolitan Planning Commission, a regional planning commission established pursuant to state statute, has the duty to make, adopt and amend plans for the physical development of Knoxville and Knox County; and

WHEREAS, the Metropolitan Planning Commission pursuant to state statute has prepared and adopted the Knoxville-Knox County General Plan 2033, as the official comprehensive plan for Knoxville and Knox County; and

WHEREAS, the Metropolitan Planning Commission has prepared the Knoxville-Knox County Major Road Plan, as an element of the General Plan; and

WHEREAS, The Metropolitan Planning Commission periodically updates the Major Road Plan to reflect changes in land use and travel patterns, or the need for transportation improvements; and

WHEREAS, the Metropolitan Planning Commission staff has submitted an amendment to the Major Road Plan to change the street classification of Loves Creek Road to a major collector street; and

WHEREAS, the Metropolitan Planning Commission staff recommends approval of the amendment to the Major Road Plan, as an element of the General Plan; and

WHEREAS, the Metropolitan Planning Commission, at its regularly scheduled public hearing on July 10, 2008, after consideration of the staff recommendation and testimony from those persons in support and opposed to the amendment, approved the amendment, as requested.

NOW, THEREFORE, BE IT RESOLVED BY THE KNOXVILLE-KNOX COUNTY METROPOLITAN PLANNING COMMISSION:

SECTION 1: The Planning Commission hereby adopts the amendment to the Knoxville-Knox County Major Road Plan, with its accompanying staff report and map, file #7-A-08-MRP.

SECTION 2: This Resolution shall take effect upon its approval.

SECTION 3: The Planning Commission further recommends that the Council of the City of Knoxville and the Commission of Knox County likewise consider this amendment to the General Plan 2033 by resolution.

Date

Chairman

Secretary

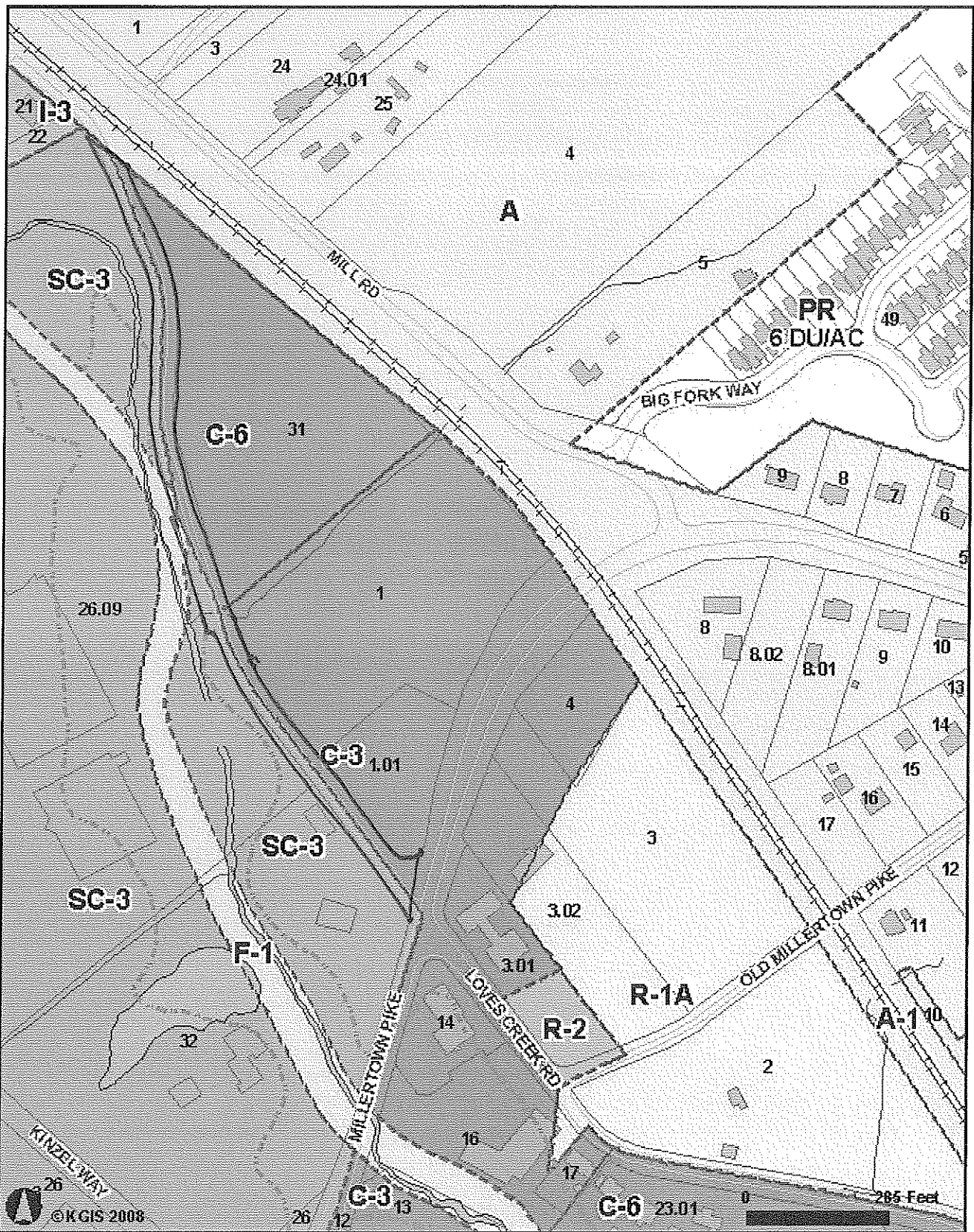

KGIS Map

KGIS - 606 Main St - Suite 150 - Knoxville, TN 37902 - www.kgis.org

Printed: Tue Jul 1 2008

Disclaimer: KGIS makes no representation or warranty as to the accuracy of this map and its information nor to its fitness for use. Any user of this map product accepts the same AS IS, WITH ALL FAULTS, and assumes all responsibility for the use thereof, and further covenants and agrees to hold KGIS harmless from any and all damage, loss, or liability arising from any use of this map product. KGIS - Copyright © 2007

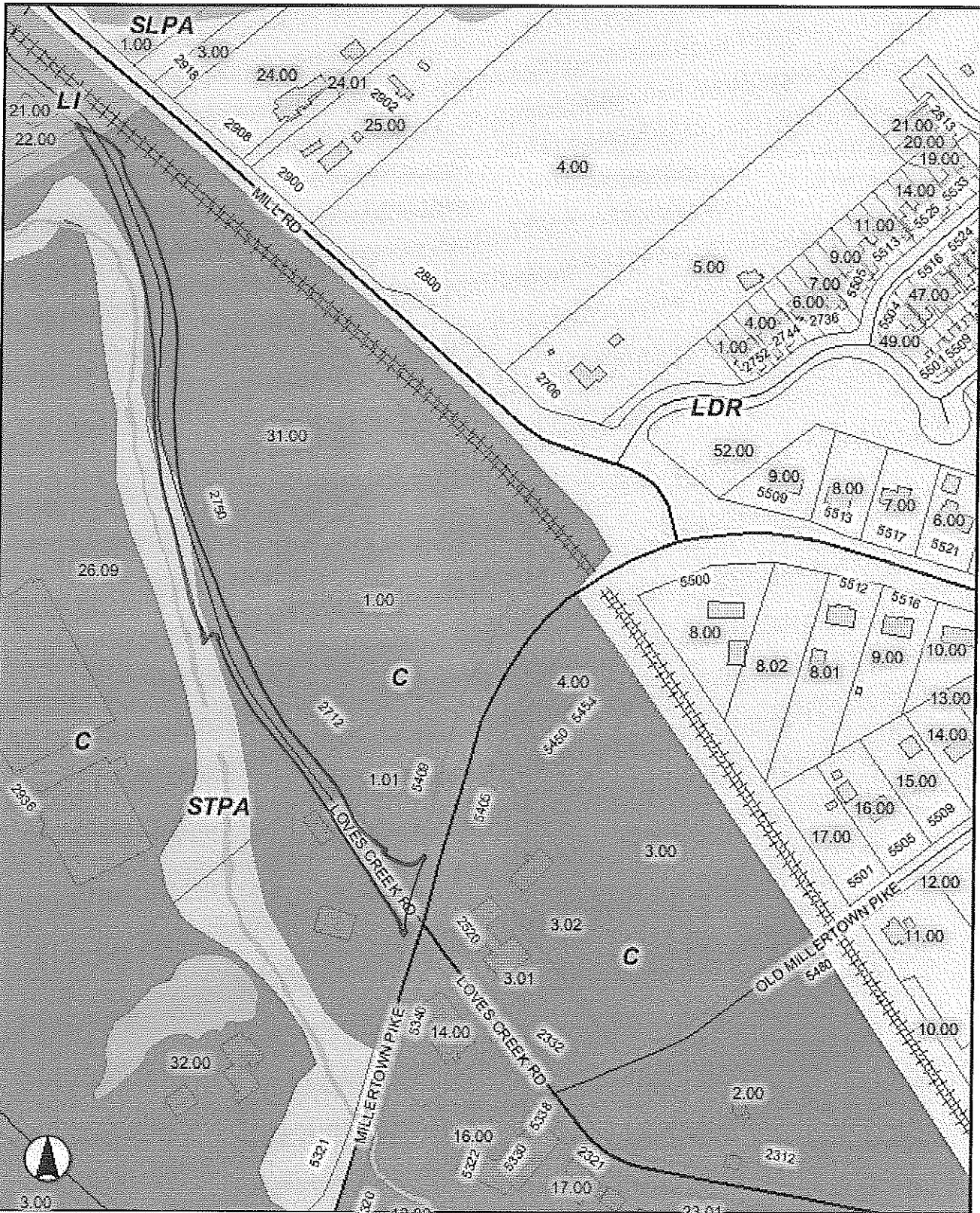

© KGIS 2008

KGIS Map

Printed: Tue Jul 1 2008

KGIS - 606 Main St - Suite 150 - Knoxville, TN 37902 - www.kgis.org

Disclaimer: KGIS makes no representation or warranty as to the accuracy of this map and its information nor to its fitness for use. Any user of this map product accepts the same AS IS, WITH ALL FAULTS, and assumes all responsibility for the use thereof, and further covenants and agrees to hold KGIS harmless from any and all damage, loss, or liability arising from any use of this map product. KGIS - Copyright © 2007