

▶ **FILE #:** 11-SW-07-F **AGENDA ITEM #:** 28
 POSTPONEMENT(S): 11/8/2007-7/10/2008 **AGENDA DATE:** 3/12/2009

▶ **SUBDIVISION:** DEWAYNE WHITT PROPERTY

▶ **APPLICANT/DEVELOPER:** DEWAYNE WHITT

OWNER(S): Dewayne Whitt

TAX IDENTIFICATION: 12 072

JURISDICTION: County Commission District 8

▶ **LOCATION:** North side of Wood Road, northeast of Majors Road

SECTOR PLAN: North County

GROWTH POLICY PLAN: Rural Area

▶ **APPROXIMATE ACREAGE:** 9.64 acres

▶ **NUMBER OF LOTS:** 2

▶ **ZONING:** A (Agricultural)

SURVEYOR/ENGINEER: Hinds Surveying

▶ **VARIANCES REQUIRED:**
 1. To reduce the width of the JPE from 40' to 25'.
 2. To leave parcels 72.01 and 71.01 without the benefit of a survey.

STAFF RECOMMENDATION:

▶ **DENY Final Plat**

COMMENTS:

This Final Plat was Tabled in May 2008 by the applicant. MPC staff removed it from the table at the February 2009 MPC meeting and requested it be acted on by the applicant. No corrected plat or request for other action was received by corrections deadline. Only a staff report and locator map is included since no corrected plat was received.

MPC's approval or denial of this request is final, unless the action is appealed to Knox County Chancery Court. The date of the Knox County Chancery Court appeal hearing will depend on when the appeal application is filed.

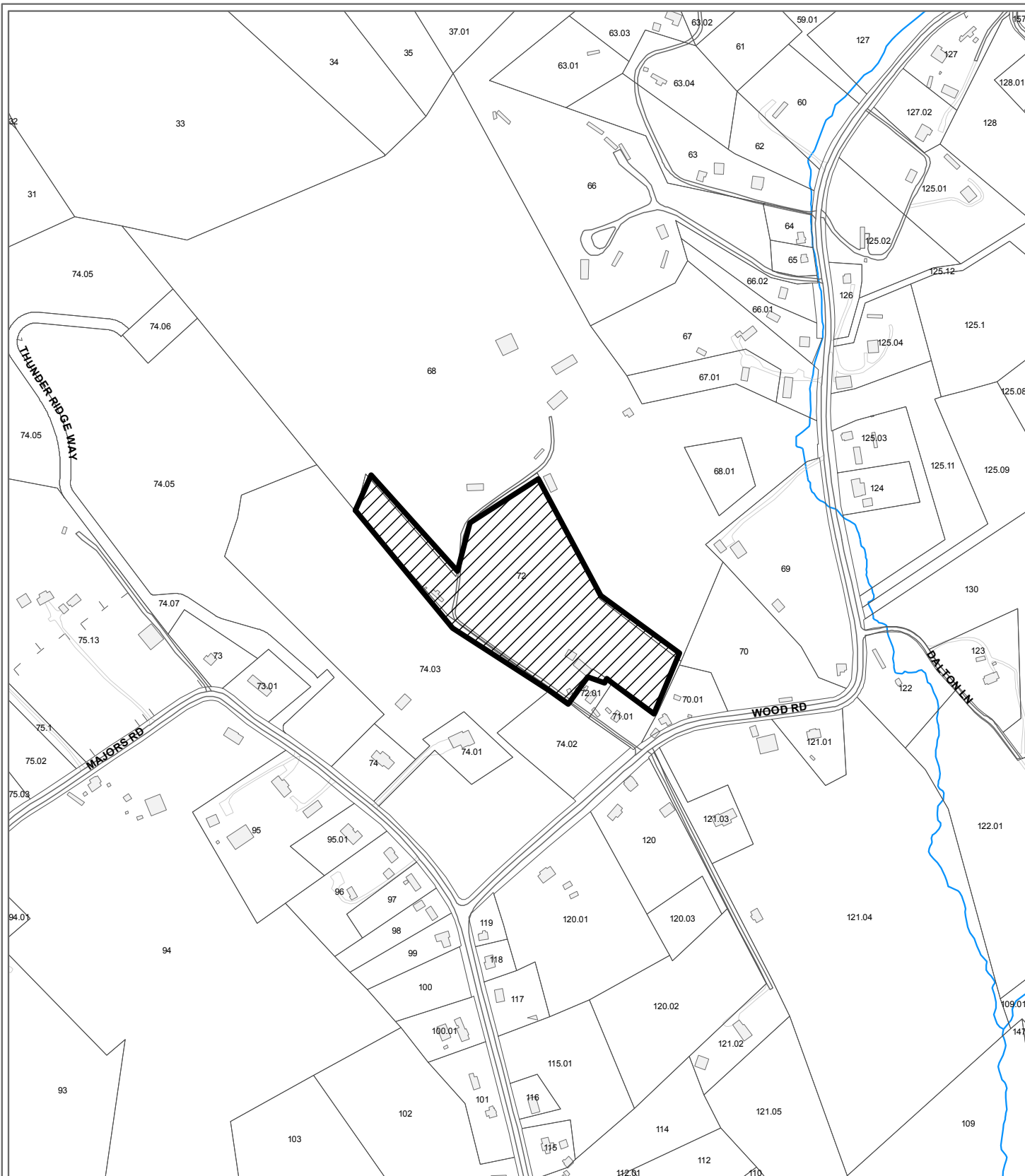

**11-SW-07-F
FINAL SUBDIVISION PLAT**

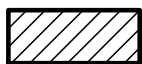

Final Plat For: Dewayne Whitt Property

Original Print Date: 3/2/2009
 Metropolitan Planning Commission * City / County Building * Knoxville, TN 37902

Revised:

Petitioner: Whitt, Dewayne

Map No: 12

Jurisdiction: County

