

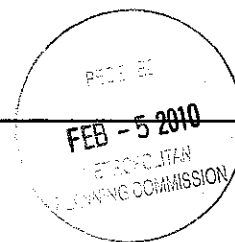

Knoxville Utilities Board



February 2, 2010

Mr. Ken Pruitt
Knoxville-Knox County
Metropolitan Planning Commission
Suite 403, City-County Building
Knoxville, Tennessee 37902

Dear Mr. Pruitt:

Re: Right-of-Way Closure Request 2-C-10-SC

We have reviewed our records and find that we have existing utility facilities located within the subject right-of-way. The approximate location of these facilities is indicated on the enclosed prints. However, KUB does not release and hereby retains all easements and rights for existing utility facilities, whether or not shown on these prints.

Should this right-of-way be closed, KUB will require the following permanent easement for its utility facility.

Electric – 10 feet on each side of the centerline of the electric line, 20 feet total width
Sewer – 7.5 feet on each side of the centerline of the wastewater line, 15 feet total width

So long as these conditions are met, KUB has no objection to the closure of this right-of-way. If you have any questions regarding this matter, please call me at (865) 558-2291.

Sincerely,

A handwritten signature in cursive script that reads 'Greg L. Patterson'.

Greg L. Patterson
Engineering

glp/ggt

Enclosure

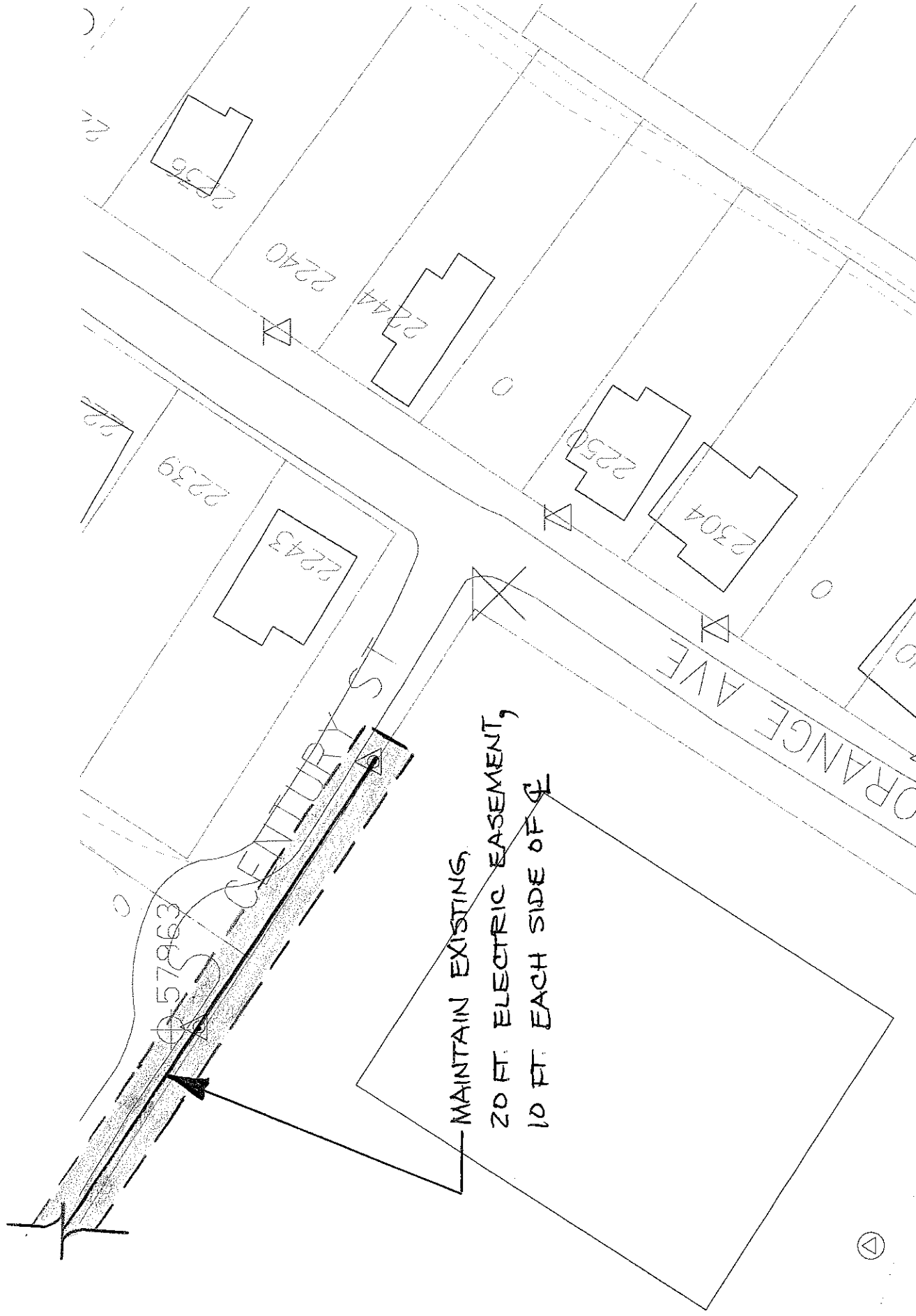

MAINTAIN EXISTING,
20 FT. ELECTRIC EASEMENT,
10 FT. EACH SIDE OF C

