

**KNOXVILLE/KNOX COUNTY METROPOLITAN PLANNING COMMISSION
 CITY OF KNOXVILLE CLOSURE OF PUBLIC RIGHT-OF-WAY**

▶ **FILE #:** 10-A-11-SC **AGENDA ITEM #:** 7

POSTPONEMENT(S): 10/13/11 **AGENDA DATE:** 12/8/2011

▶ **APPLICANT:** UNIVERSITY OF TENNESSEE

TAX ID NUMBER: 108 F C 006
 JURISDICTION: Council District 1
 SECTOR PLAN: Central City
 GROWTH POLICY PLAN: Urban Growth Area (Inside City Limits)
 ZONING: O-2 (Civic and Institutional)
 WATERSHED: Tennessee River

▶ **RIGHT-OF-WAY TO BE CLOSED:** Phillip Fulmer Way
 ▶ **LOCATION:** Between Cumberland Avenue and Lake Loudoun Boulevard

IS STREET:
 (1) IN USE?: Yes
 (2) IMPROVED (paved)?: Yes

▶ **APPLICANT'S REASON FOR CLOSURE:** This City street is completely contained within the boundaries of the UT campus. Two major capital projects shall commence within the next year, which will have a major impact on the utilization of this street. In addition, this street is within the security perimeter of Neyland Stadium. Future renovation projects at the stadium will also impact the utilization and potential design of the street. Based on these factors, it is the appropriate time for UT to assume operations of the street. Ultimately, in accordance with the UT Master Plan, the street will become a four lane boulevard connecting Cumberland Ave. with Lake Loudoun Blvd.

DEPARTMENT-UTILITY REPORTS: No objections have been received by staff as of 12/1/11.

STAFF RECOMMENDATION:

▶ **RECOMMEND** that City Council **APPROVE** the closure of Phillip Fulmer Way, subject to any required easements.

Staff has received no objections to this closure. The University of Tennessee owns all the property fronting along this right-of-way.

COMMENTS:

UT is requesting the closures of Phillip Fulmer Way (10-A-11-SC), Peyton Manning Pass (10-B-11-SC) and Tee Martin Dr. (11-A-11-SC). Closure of these streets as public rights-of-way will result in the streets becoming private streets to be maintained by the University of Tennessee.

If approved, this item will be forwarded to Knoxville City Council for action on 1/10/2012 and 1/24/2012. If denied, MPC's action is final, unless the action to deny is appealed to Knoxville City Council. The date of the

appeal hearing will depend on when the appeal application is filed. Appellants have 15 days to appeal an MPC decision in the City.

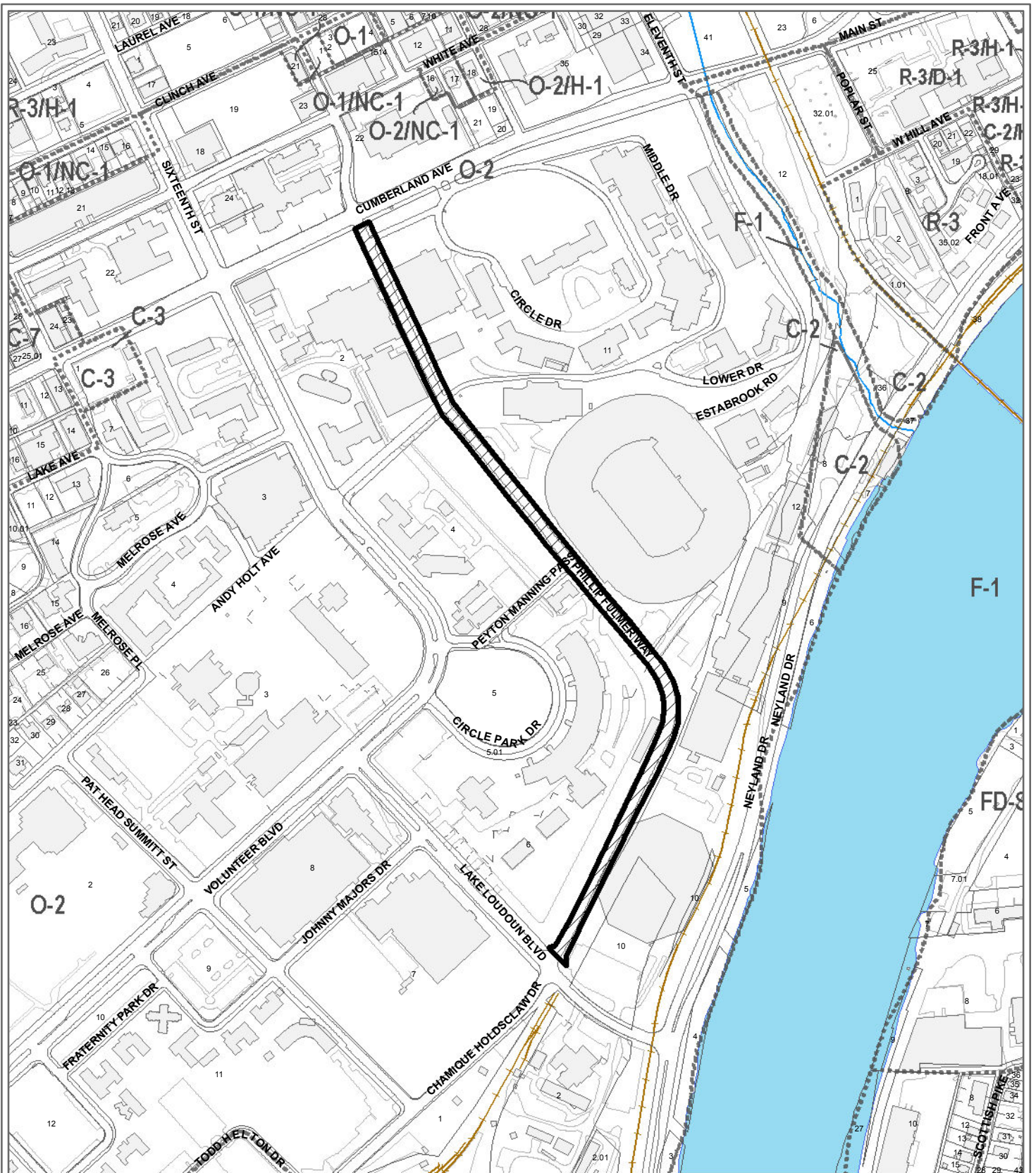

**10-A-11-SC
CLOSURE OF PUBLIC RIGHT OF WAY**

Name of Street or Alley: Phillip Fulmer Way
 To be closed from: Cumberland Avenue
 To be closed to: Lake Loudoun Boulevard

Original Print Date: 9/28/2011 Revised:
 Metropolitan Planning Commission * City / County Building * Knoxville, TN 37902

Petitioner: University of Tennessee

Map No: 108
 Jurisdiction: City

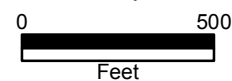



Knoxville Utilities Board

September 9, 2011



Mr. Mike Brusseau
Knoxville-Knox County
Metropolitan Planning Commission
Suite 403, City-County Building
Knoxville, Tennessee 37902

Dear Mr. Brusseau:

**Re: Right-of-Way Closure Request 10-A-11-SC
Block No. 10502 to 10790
CLT No. 108
Parcel No. 2 to 8**

We have reviewed our records and find that we have existing utility facilities located within the subject right-of-way. The approximate location of these facilities is indicated on the enclosed prints. However, KUB does not release and hereby retains all easements and rights for existing utility facilities, whether or not shown on these prints.

Should this right-of-way be closed, KUB will require the following permanent easement for its utility facility.

- Gas – 7.5 feet on each side of the centerline of the gas line, 15 feet total width
- Sewer – 7.5 feet on each side of the centerline of the wastewater line, 15 feet total width
- Water – 7.5 feet on each side of the centerline of the water line, 15 feet total width

So long as these conditions are met, KUB has no objection to the closure of this right-of-way. If you have any questions regarding this matter, please call me at (865) 558-2291.

Sincerely,

Greg L. Patterson, P.E.
Engineering

glt/ggt

Enclosure

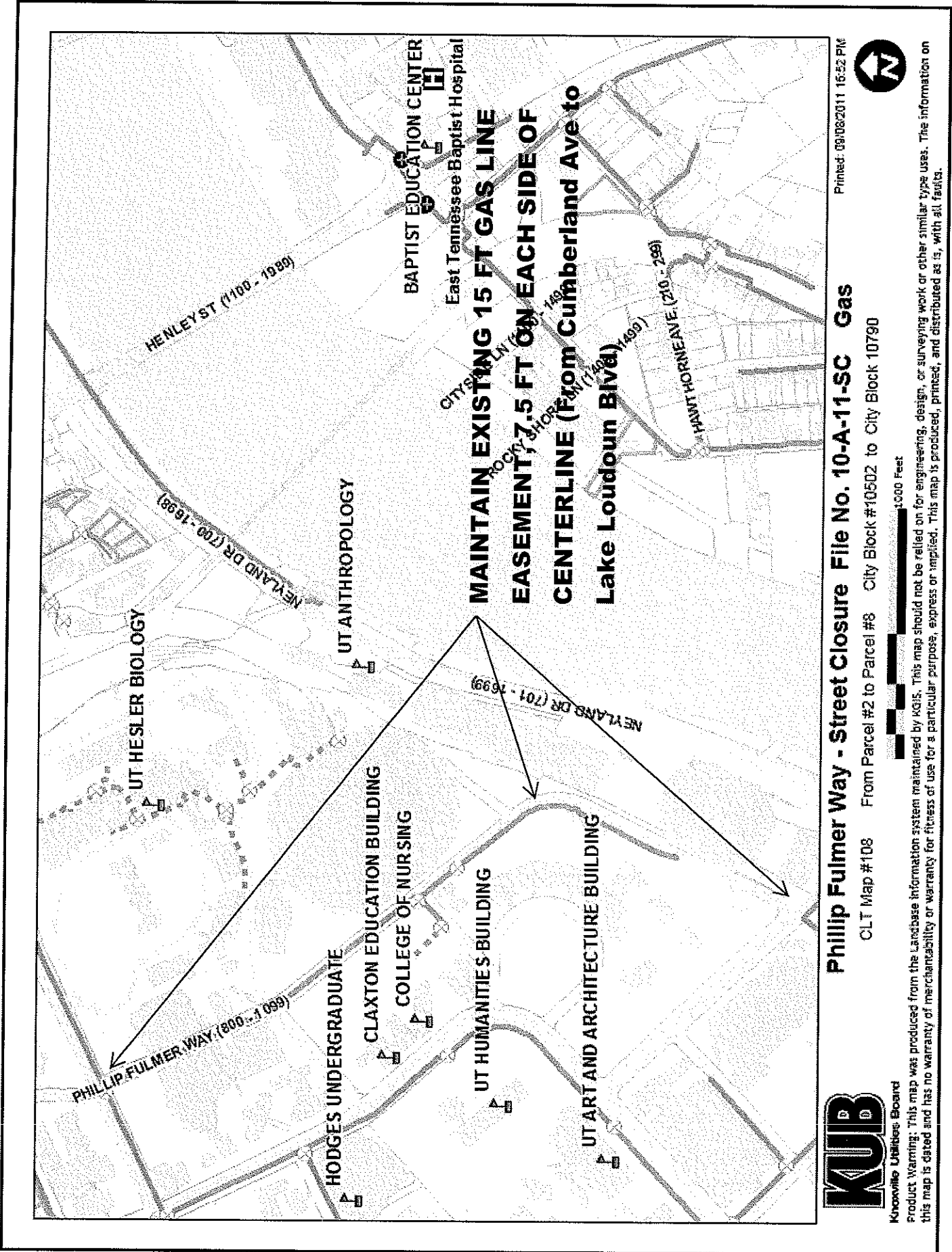

Printed: 09/08/2011 15:52 PM



Phillip Fulmer Way - Street Closure File No. 10-A-11-SC Gas

CLT Map #108 From Parcel #2 to Parcel #8 City Block #10502 to City Block 10790



KUB Knoxville Utilities Board

Product Warning: This map was produced from the Landbase information system maintained by KUBS. This map should not be relied on for engineering, design, or surveying work or other similar type uses. The information on this map is dated and has no warranty of merchantability or warranty for fitness for use for a particular purpose, express or implied. This map is produced, printed, and distributed as is, with all faults.

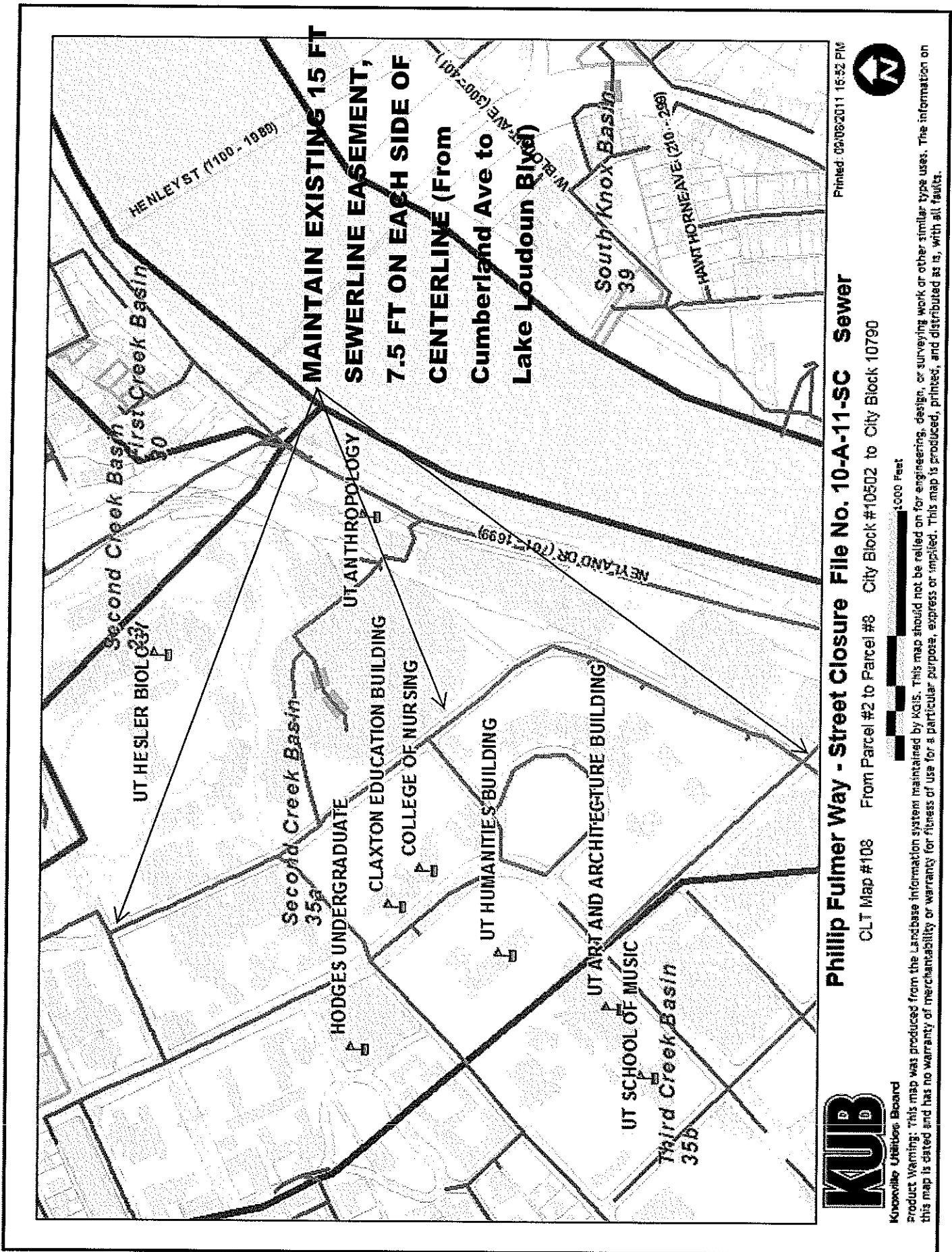

MAINTAIN EXISTING 15 FT SEWERLINE EASEMENT, 7.5 FT ON EACH SIDE OF CENTERLINE (From Cumberland Ave to Lake Loudoun Blvd)



Knoxville Utilities Board

Phillip Fulmer Way - Street Closure File No. 10-A-11-SC Sewer

CLT Map #108 From Parcel #2 to Parcel #8 City Block #10502 to City Block 10790

Printed: 02/08/2011 16:52 PM



Product Warning: This map was produced from the Landbase information system maintained by KUB. This map should not be relied on for engineering, design, or surveying work or other similar type uses. The information on this map is dated and has no warranty of merchantability or warranty for fitness of use for a particular purpose, express or implied. This map is produced, printed, and distributed as is, with all faults.

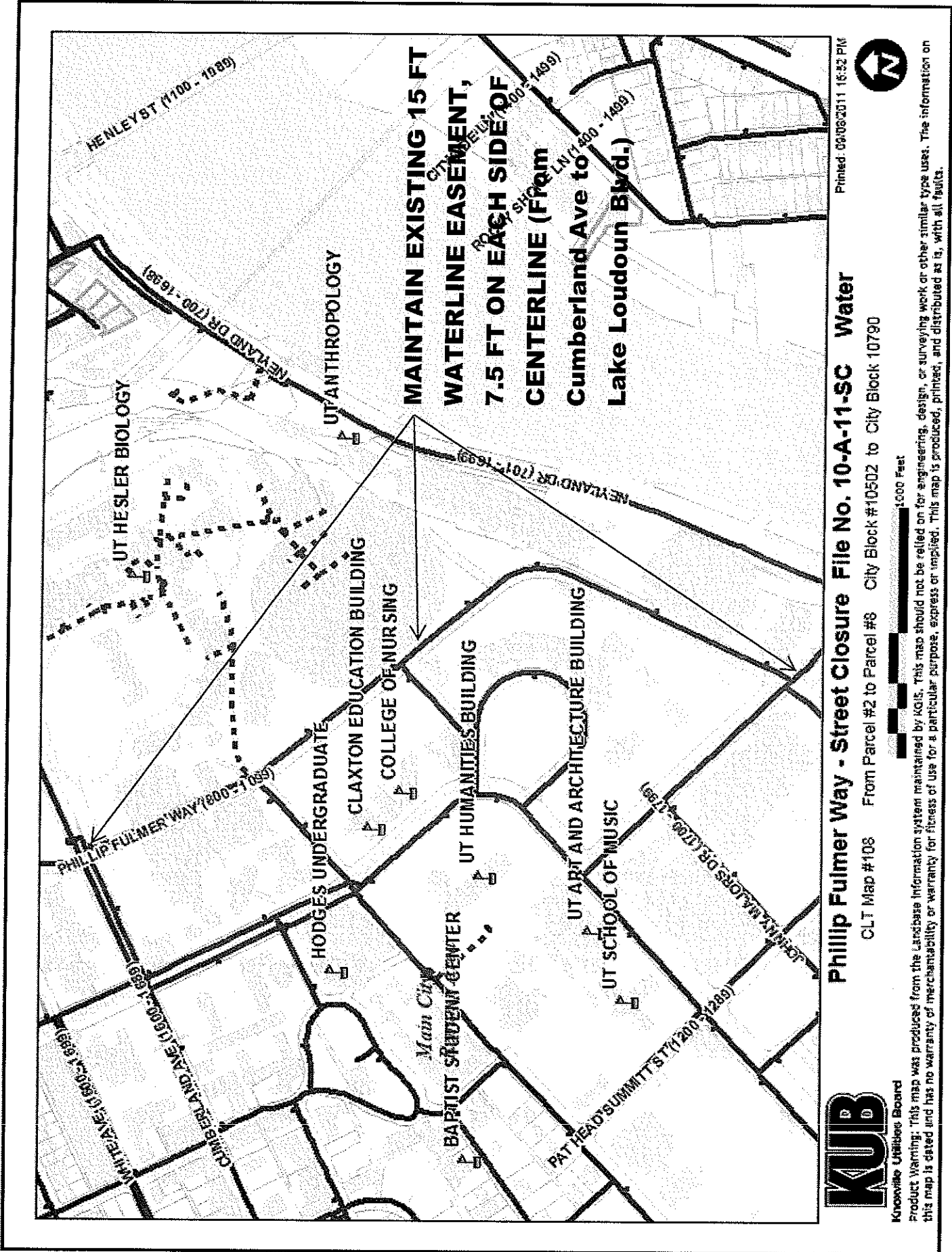

Printed: 09/08/2011 15:32 PM



Philip Fulmer Way - Street Closure File No. 10-A-11-SC Water

CLT Map #108 From Parcel #2 to Parcel #8 City Block #10502 to City Block 10790

1000 Feet



Knoxville Utilities Board

Product Warning: This map was produced from the Landbase information system maintained by KUB. This map should not be relied on for engineering, design, or surveying work or other similar type uses. The information on this map is stated and has no warranty of merchantability or warranty for fitness of use for a particular purpose, express or implied. This map is produced, printed, and distributed as is, with all faults.