

**KNOXVILLE/KNOX COUNTY METROPOLITAN PLANNING COMMISSION  
 CITY OF KNOXVILLE CLOSURE OF PUBLIC RIGHT-OF-WAY**

▶ **FILE #:** 2-A-11-SC

**AGENDA ITEM #:** 7

**AGENDA DATE:** 2/10/2011

▶ **APPLICANT:** EAST TENNESSEE AUTOMOBILE CLUB, INC.

TAX ID NUMBER: 94 E D 011  
 JURISDICTION: Council District 6  
 SECTOR PLAN: Central City  
 GROWTH POLICY PLAN: Urban Growth Area (Inside City Limits)  
 ZONING: C-3 (General Commercial)  
 WATERSHED: First Creek

▶ **RIGHT-OF-WAY TO BE CLOSED:** King St

▶ **LOCATION:** Between Ashe Avenue and southeast terminus at I-40 ROW

IS STREET:  
 (1) IN USE?: Yes  
 (2) IMPROVED (paved)?: Yes

▶ **APPLICANT'S REASON FOR CLOSURE:** To incorporate right-of-way into property that applicant owns on each side to make parking and other site improvements.

DEPARTMENT-UTILITY REPORTS: No objections have been received by staff as of 1/28/11.

**STAFF RECOMMENDATION:**

▶ **RECOMMEND** that City Council **APPROVE** the closure of this portion of King St., subject to any required easements.

Staff has received no objections to this closure. The applicant owns all the property adjacent to this right-of-way.

**COMMENTS:**

This street ends at the I-40 right-of-way. There is a black, wrought iron fence installed at the end of the street that blocks vehicular access to the adjacent area under the interstate, which is used for parking for businesses in the area. The applicant owns all of the property adjacent to this public street and, if closed, intends to incorporate the right-of-way into the rest of the property on either side to improve their parking and make other site improvements. The AAA East Tennessee facilities are currently under renovation, and this closure will assist in these improvements.

If approved, this item will be forwarded to Knoxville City Council for action on 3/8/2011 and 3/22/2011. If denied, MPC's action is final, unless the action to deny is appealed to Knoxville City Council. The date of the appeal hearing will depend on when the appeal application is filed. Appellants have 15 days to appeal an MPC decision in the City.



2-A-11-SC-cor\_KUB



Knoxville Utilities Board

JAN 12 2011

January 11, 2011



Mr. Ken Pruitt  
Knoxville-Knox County  
Metropolitan Planning Commission  
Suite 403, City-County Building  
Knoxville, Tennessee 37902

Dear Mr. Pruitt:

**Re: Right-of-Way Closure Request 2-A-11-SC**

We have reviewed our records and find that we have existing utility facilities located within the subject right-of-way. The approximate location of these facilities is indicated on the enclosed prints. However, KUB does not release and hereby retains all easements and rights for existing utility facilities, whether or not shown on these prints.

Should this right-of-way be closed, KUB will require the following permanent easement for its utility facility.

Electric – 10 feet on each side of the centerline of the electric line, 20 feet total width  
Gas – 7.5 feet on each side of the centerline of the gas line, 15 feet total width  
Sewer – 7.5 feet on each side of the centerline of the wastewater line, 15 feet total width  
Water – 7.5 feet on each side of the centerline of the water line, 15 feet total width

So long as these conditions are met, KUB has no objection to the closure of this right-of-way. If you have any questions regarding this matter, please call me at (865) 558-2291.

Sincerely,

A handwritten signature in cursive script that reads 'Greg Patterson'.

Greg L. Patterson, P.E.  
Engineering

glp/ggt

Enclosure

Electricity • Gas • Water • Wastewater

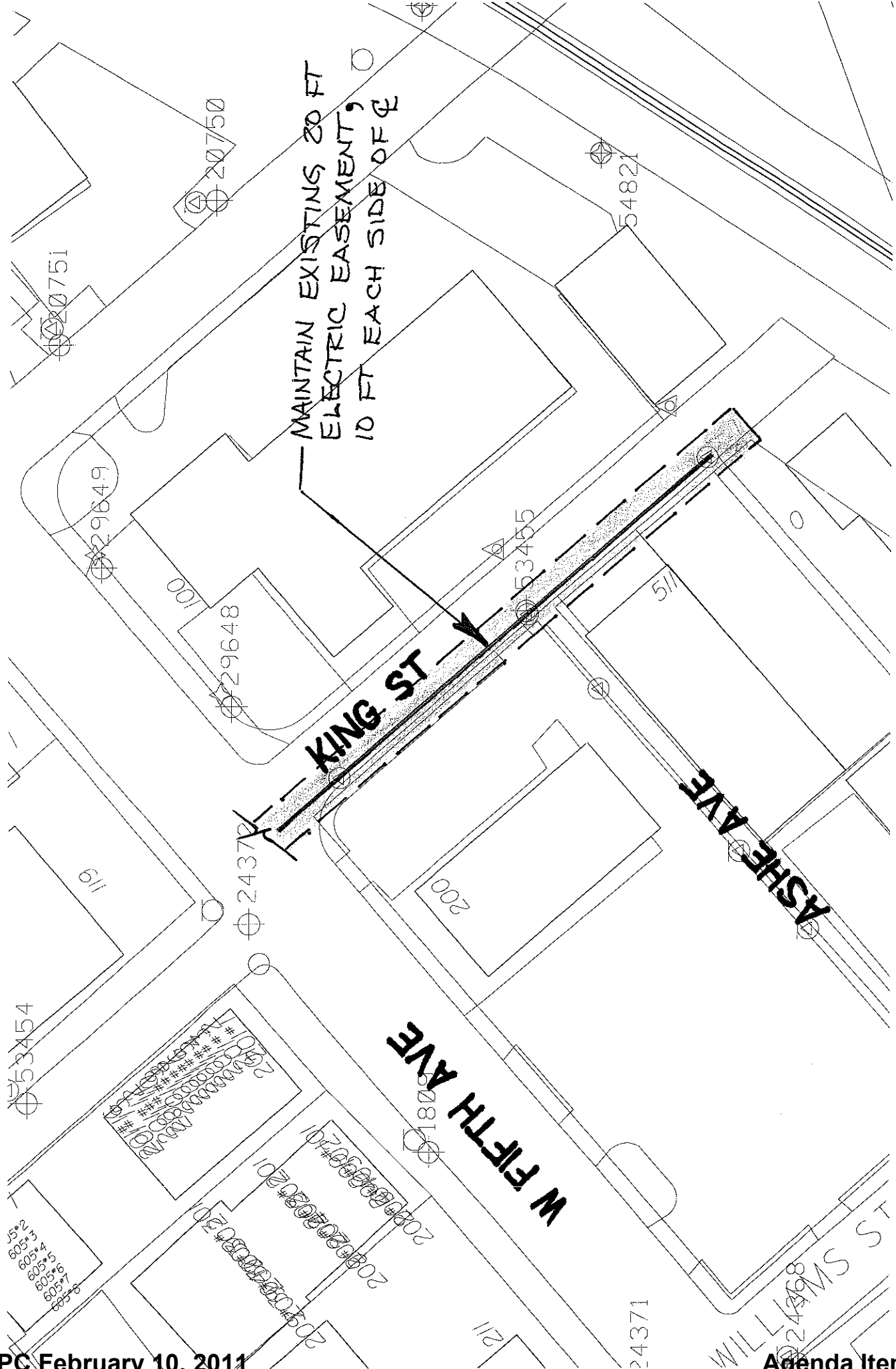







Closure of King Street (Ashe Ave to TDOT ROW) WATER 1" = 60'

