

Shop in Pond Gap
Save our pond

Pond Gap Area Neighborhood Association

"Thou shalt be
called the repairer
of the breach, the
restorer of paths
to dwell in."

Isaiah 58:12

Early settlers (1790's) drove their cattle to that pond gap pasture
(on Hollywood). That's how Pond Gap got its name.

Our Website is
www.pondgapcommunity.com

We're home to Sutherland Airfield (Knoxville's first airport), Knoxville Drive-In Theater, Ringling Bros. Circus (big top), Golf Range Field of Harmony, the paper mill on Papermill Road., and a bunch of great folks.

Concerning Mann St. closure request (file # 5--A-11-sc):

The Pond Gap Area Neighborhood Association opposes the closure based on historic, cultural, safety, and environmental reasons.

Attached documents include maps of the area and Mayor Burchett's letter of support with historic references.

A representative from the Association plans on attending the June 9 MPC meeting. Thank you.

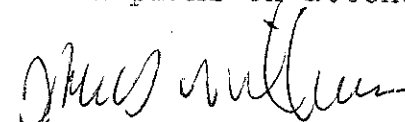

David Williams, president
ph. # 256-1828

Dated 12/3/1923
 Ben Priddy et al
 2nd Fl. c/o HOBBS

Manager
 of
 H. L. Mann's
 Company

JOHN L. MANN'S
 FIRST ADDITION.

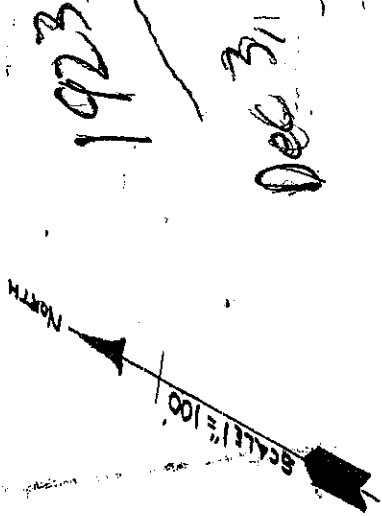

1923
 Dec 31 1923

JOHN L. MANN'S
 SECOND ADDITION.

S. 59° 42' W.

SOUTHERLAND AVE.										
21	30	"	"	"	"	"	"	"	30	
1815	34	35	36	37	38	39	40	41	42 43 44	
1815	30	NAME							AVE.	30
128	23	24	25	26	27	28	29	30	31 32 33	
128	12	13	14	15	16	17	18	19	20 21 22	
30	30	"	"	"	"	"	"	"	"	
GRIFFIN AVE.										
30	30	"	"	"	"	"	"	"	30	
125	21	2	3	4	5	6	7	8	9 10 11	
125	21	SOUTH LINE OF FIRST ADD.							11	12
125	21	NORTH LINE OF SECOND ADD.							11	12
30	21	2	3	4	5	6	7	8	9 10 11	
30	30	"	"	"	"	"	"	"	30	
SHARP AVE.										
125	12	13	14	15	16	17	18	19	20 21 22	
125	23	24	25	26	27	28	29	30	31 32 33	
30	30	"	"	"	"	"	"	"	30	
WALKER AVE.										
166.5	30	"	"	"	"	"	"	"	30	
166.5	34	35	36	37	38	39	40	41	42 43 44	
21	SOUTHERN RY. RIGHT OFWAY									

8TH DISTRICT KNOX COUNTY

3/4/201

G. Beal (MPC map)

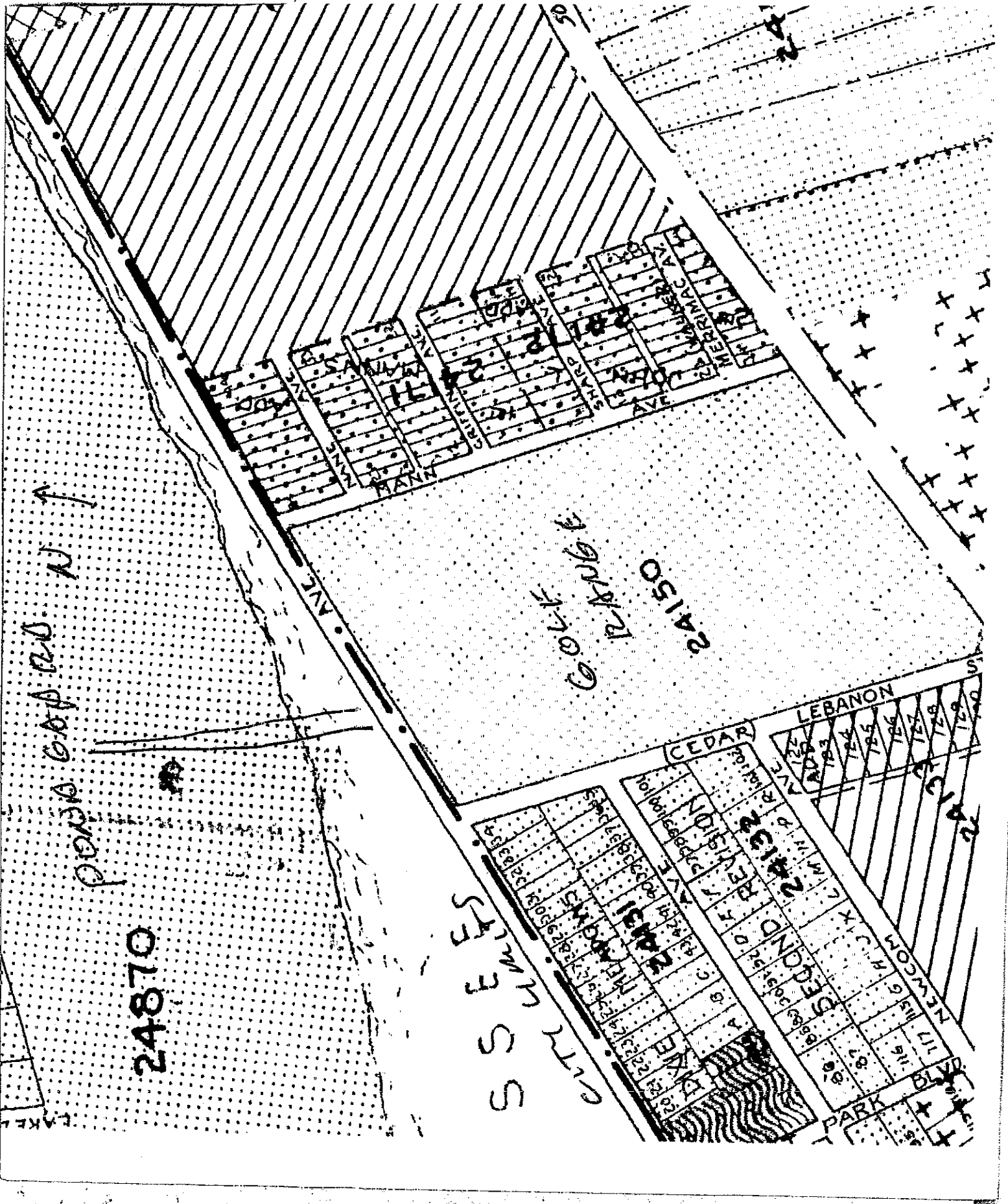



OFFICE OF COUNTY MAYOR TIM BURCHETT

400 Main Street, Suite 615, Knoxville, TN 37902

May 10, 2011

Dear Members of the Metropolitan Planning Commission,

As you consider proposals dealing with the University of Tennessee's Married Student Housing apartment complex on Sutherland Avenue, I hope you will carefully consider the historical and cultural significance of what happened along Mann Street in the Pond Gap neighborhood.

During the 1940s and 1950s, local residents took part in some of the earliest documented integrated sporting events I have heard of. The area's working class residents along Mann Street—both black and white—played countless baseball games together, fostering a sense of community that transcended race.

I would appreciate it very much if you would give careful consideration to the Pond Gap Area Neighborhood Association's wishes to maintain at least a portion of Mann Street as a reminder of its past. Unfortunately, that community was forever changed when the University of Tennessee built the apartment complex they now plan to tear down.

Despite the drastic changes UT's presence made on the area, now is an excellent time to commemorate and recognize the good faith efforts of the former residents of Mann Street.

Thank you in advance for your consideration.

Sincerely,

A handwritten signature in cursive script, appearing to read "Tim Burchett".

Tim Burchett
Knox County Mayor

jcg:TB