



**KNOXVILLE/KNOX COUNTY METROPOLITAN PLANNING COMMISSION  
CITY OF KNOXVILLE CLOSURE OF PUBLIC RIGHT-OF-WAY**

▶ **FILE #:** 8-D-13-SC

**AGENDA ITEM #:** 8

**AGENDA DATE:** 8/8/2013

▶ **APPLICANT:** UNIVERSITY OF TENNESSEE

---

TAX ID NUMBER: 108 F C 009  
 JURISDICTION: Council District 2  
 SECTOR PLAN: Central City  
 GROWTH POLICY PLAN: Urban Growth Area (Inside City Limits)  
 ZONING: O-2 (Civic and Institutional)  
 WATERSHED: Tennessee River

---

▶ **RIGHT-OF-WAY TO BE CLOSED:** Pat Head Summitt St

▶ **LOCATION:** Between Chamique Holdsclaw Drive and Andy Holt Avenue

---

IS STREET:  
 (1) IN USE?: Yes  
 (2) IMPROVED (paved)?: Yes

▶ **APPLICANT'S REASON FOR CLOSURE:** This City street is completely contained within the existing institutional zone of the University of Tennessee campus. Implementation of the overall Campus Master Plan and Landscape Master Plan provides an opportunity to implement several projects which may also impact street and sidewalk improvements. The University assuming ownership of the street affords the campus an opportunity to expedite these projects and also comply with design guidelines.

---

DEPARTMENT-UTILITY REPORTS: No objections from any departments or utilities have been received by staff as of the date of this report.

---

**STAFF RECOMMENDATION:**

▶ **RECOMMEND** that City Council **APPROVE** the closure of Pat Head Summitt Street, as requested, subject to any required easements and subject to the following condition:

1. The 8 conditions included in the attached letter from City of Knoxville Engineering (dated July 22, 2013) must be addressed to the satisfaction of that department.

With the above condition included, staff has received no objections from reviewing departments to this closure

**COMMENTS:**

The result of UT's proposed closure of this and eight other streets within the campus will be that the University will take over ownership and maintenance of the streets from the City of Knoxville. It does not necessarily mean that the streets would be closed to traffic or that the street names would be changed, but those decisions would become the responsibility of UT. UT owns all of the properties adjacent to the subject street. Staff has not heard from any opposition to this closure as of the date of this report.

If approved, this item will be forwarded to Knoxville City Council for action on 9/3/2013 and 9/17/2013. If denied, MPC's action is final, unless the action to deny is appealed to Knoxville City Council. The date of the appeal hearing will depend on when the appeal application is filed. Appellants have 15 days to appeal an MPC decision in the City.

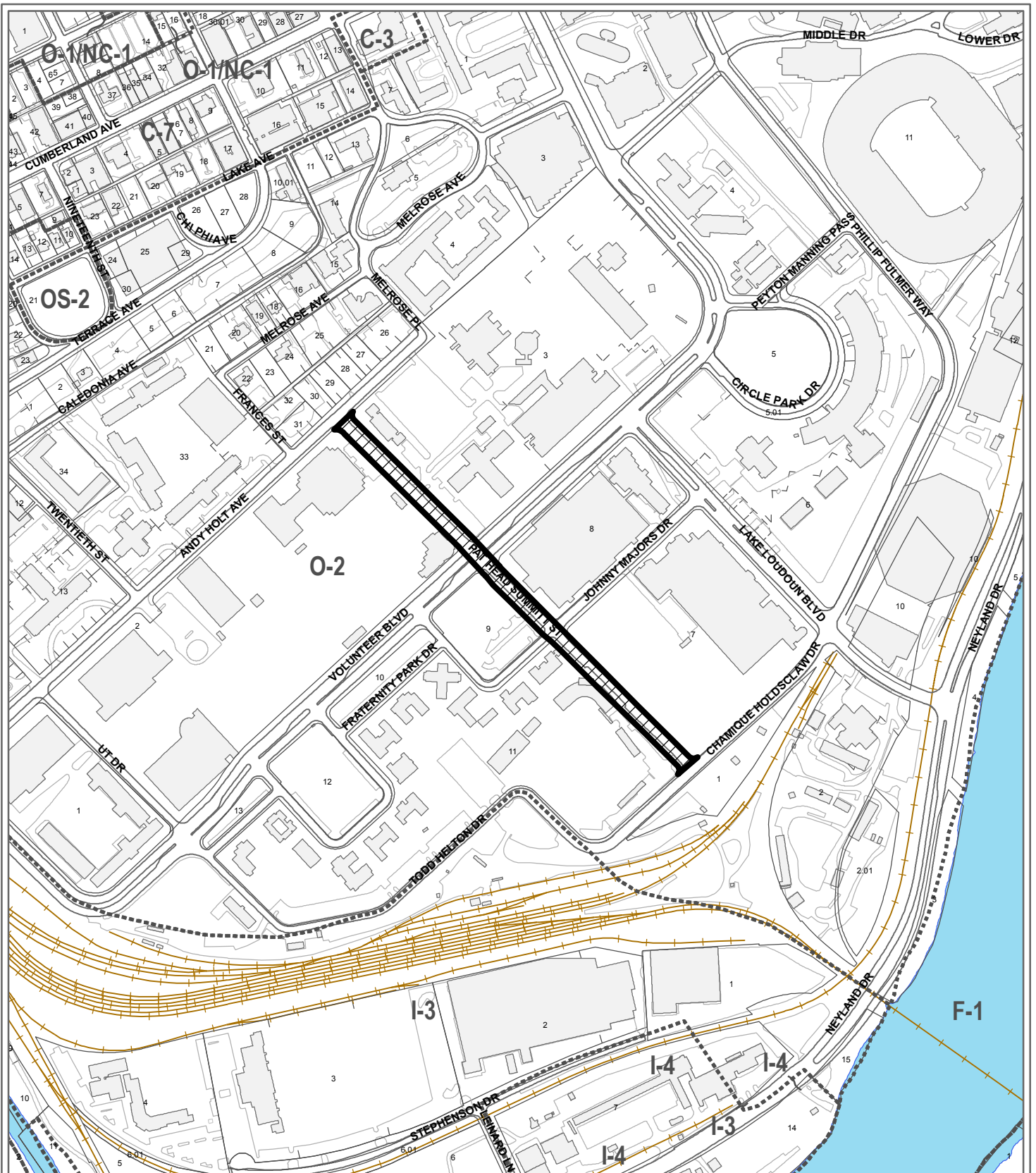

**8-D-13-SC  
CLOSURE OF PUBLIC RIGHT OF WAY**

Name of Street or Alley: Pat Head Summitt St  
 To be closed from: Chamique Holdsclaw Drive  
 To be closed to: Andy Holt Avenue

Original Print Date: 7/19/2013      Revised:  
 Metropolitan Planning Commission \* City / County Building \* Knoxville, TN 37902

Petitioner: University of Tennessee

Map No: 108  
 Jurisdiction: City

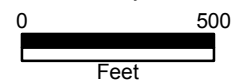



# CITY OF KNOXVILLE

**Engineering**  
James R. Hagerman, P.E.  
Director of Engineering

July 22, 2013

Mr. Mike Brusseau, AICP, Senior Planner  
Knoxville-Knox County Metropolitan Planning Commission  
City-County Building, Suite 403  
Knoxville, Tennessee 37902

**SUBJECT:** MPC File # 8-D-13-SC, closure of Pat Head Summitt St between Chamique Holdsclaw Dr & Andy Holt Ave (City Blocks 10770, 10790, 10730, & 10800)

Mr. Brusseau:

The City Engineering Department has no objections to close the above described right-of-way area provided the following conditions, subject to City Engineering approval, are met:

1. Should this right-of-way be closed, the applicant assumes maintenance responsibility for all stormwater systems previously maintained by the City, within the closure area. The applicant will maintain the approved stormwater facilities in good working order acceptable to the City Department of Engineering. Minimum maintenance of the said facilities shall include sediment, debris, oil, hydrocarbons, and foreign materials removal so that the operation and capacity of the stormwater facilities continue to meet acceptable standards.
2. If the applicant subsequently conveys property abutting any closed areas, the applicant shall provide legal access to a public street for ingress/egress, utilities, etc. necessary to support conveyed property.
3. The University of Tennessee shall dedicate easements over portions of the proposed closure areas of Chamique Holdsclaw Dr and Pat Head Summitt St (MPC File # 8-D-13-SC) to accommodate a public turnaround for the resulting dead-end on Todd Helton Dr.
4. The dedicated easements in item no. 3 shall be abandoned and extinguished if Todd Helton Dr is ever closed or other approvable means is provided to prevent a dead-end situation on Todd Helton Dr.
5. The University of Tennessee shall dedicate easements for all control devices located within the closure area of Pat Head Summitt St at the intersection of Volunteer Blvd.
6. The easements stated in item no. 5 shall be abandoned and extinguished if the intersecting open public right-of-way areas, on which the traffic control devices are located, are ever closed.
7. All conditions must be met within one (1) year upon the final approval by City Council. Otherwise, this process will be deemed to be null and void and of no effect.
8. The closing ordinance shall state that the closure shall become effective only after the Department of Engineering has provided written verification to the City Recorder that all conditions have been met.

Sincerely,

Benjamin D. Davidson, PLS, Technical Services Administrator, Department of Engineering  
Ph: 865-215-2148

C: Brently J. Johnson, P.E., R.L.S., Engineering Planning Chief  
Christopher S. Howley, P.E., Plans Review and Development Inspections



Knoxville Utilities Board



July 16, 2013

Mr. Mike Brusseau  
Knoxville-Knox County  
Metropolitan Planning Commission  
Suite 403, City-County Building  
Knoxville, Tennessee 37902

Dear Mr. Brusseau:

Re: Right-of-Way Closure Request 8-D-13-SC  
Block No. 10770/10790  
CLT No. 108  
Parcel No. 9

We have reviewed our records and find that we have existing utility facilities located within the subject right-of-way. The approximate location of these facilities is indicated on the enclosed prints. However, KUB does not release and hereby retains all easements and rights for existing utility facilities, whether or not shown on these prints.

Should this right-of-way be closed, KUB will require the following permanent easement for its utility facility.

Electric – 10 feet on each side of the centerline of the electric line, 20 feet total width  
Gas – 7.5 feet on each side of the centerline of the gas line, 15 feet total width  
Sewer – 7.5 feet on each side of the centerline of the wastewater line, 15 feet total width  
Water – 7.5 feet on each side of the centerline of the water line, 15 feet total width

So long as these conditions are met, KUB has no objection to the closure of this right-of-way. If you have any questions regarding this matter, please call me at (865) 558-2291.

Sincerely,

Greg L. Patterson, P.E.  
Engineering

glp/ggt

Enclosure

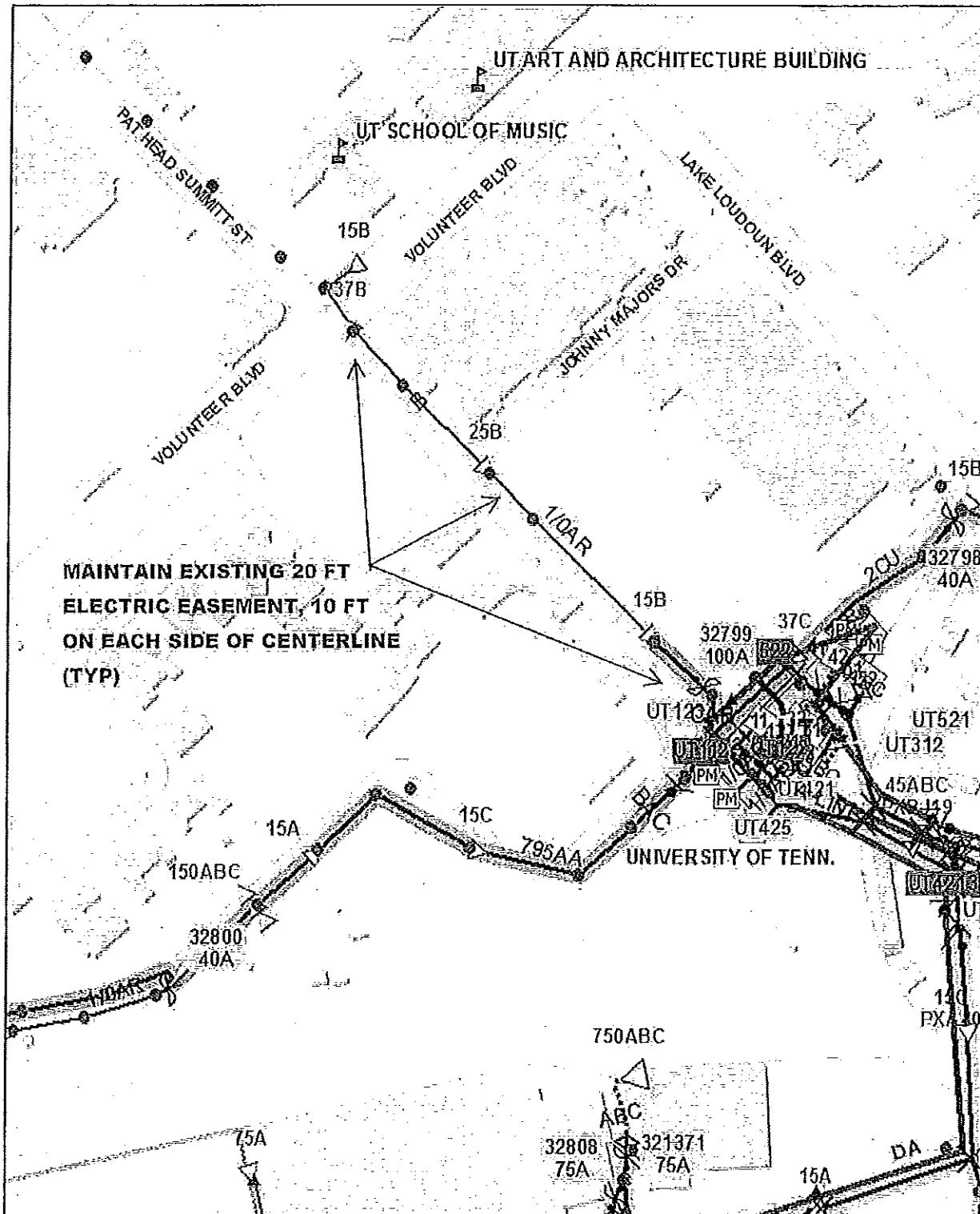

Knoxville Utilities Board

**File No. 8-D-13-SC Pat Head Summitt St (Electric)**

led: 07/16/2013 11:21 AM

Street Closure (Andy Holt Dr to Chamique Holdsclaw Dr) CLT Map#108 Parcel#9  
City Blocks 10770/10790



555 Feet

Product Warning: This map was produced from the Landbase Information system maintained by KGIS. This map should not be relied on for engineering, design, or surveying work or other similar type uses. The information on this map is dated and has no warranty of merchantability or warranty for fitness of use for a particular purpose, express or implied. This map is produced, printed, and distributed as is, with all faults.

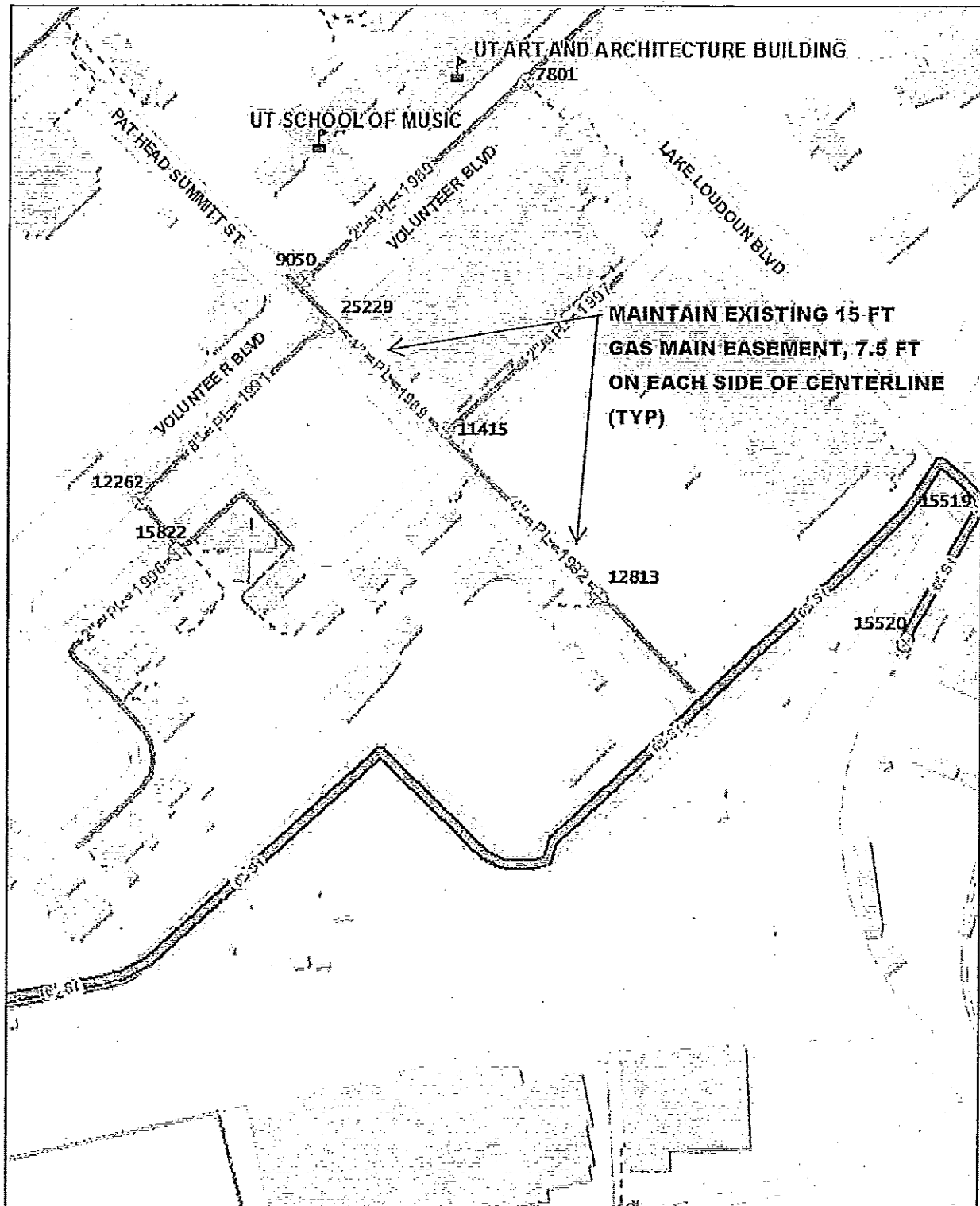

**File No. 8-D-13-SC Pat Head Summitt St (Gas)**

led: 07/18/2013 11:21 AM

Street Closure (Andy Holt Dr to Chamique Holdsclaw Dr) CLT Map#108 Parcel#9  
City Blocks 10770/10790



558 Feet

Product Warning: This map was produced from the Landbase Information system maintained by KGIS. This map should not be relied on for engineering, design, or surveying work or other similar type uses. The information on this map is dated and has no warranty of merchantability or warranty for fitness of use for a particular purpose, express or implied. This map is produced, printed, and distributed as is, with all faults.

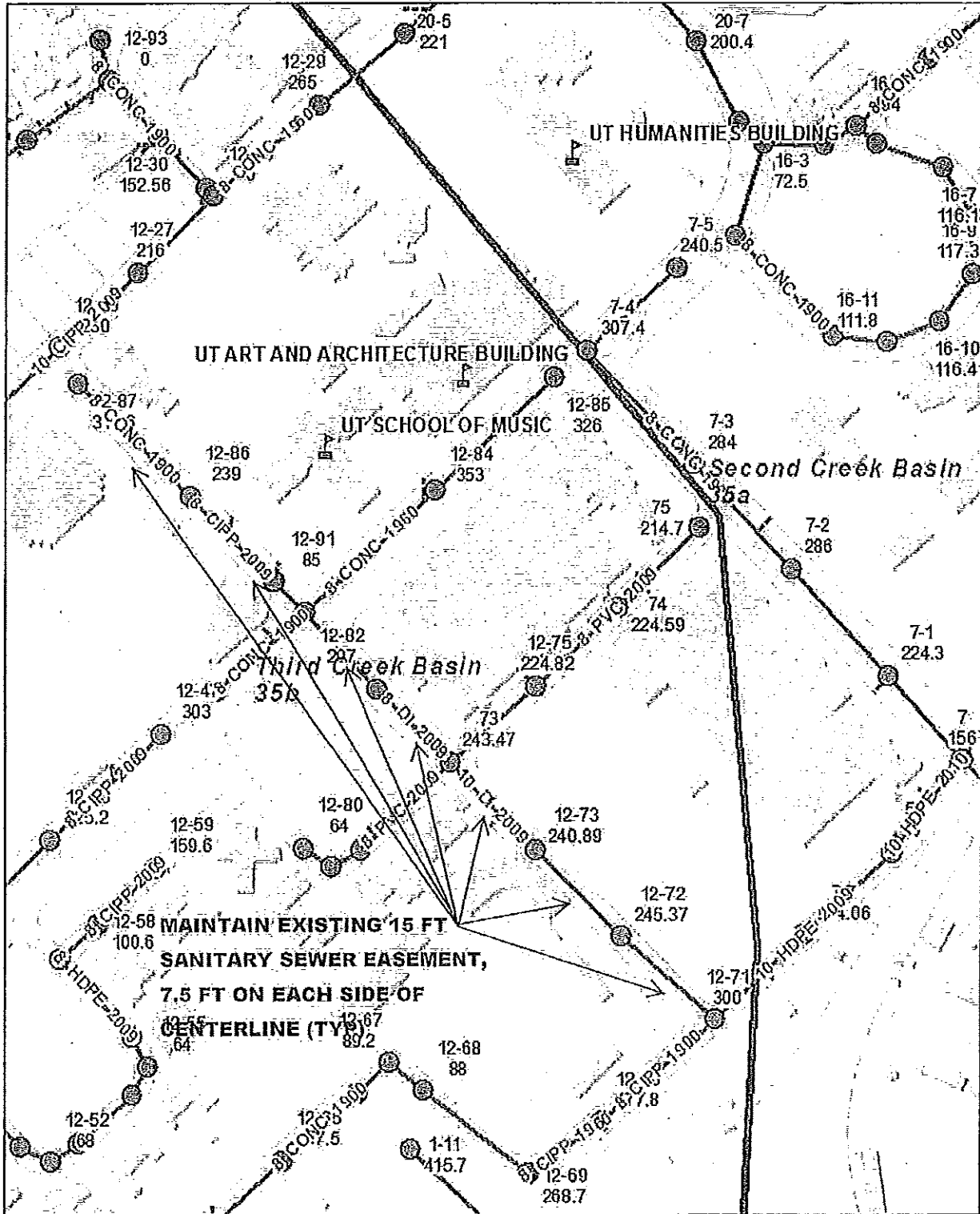

**File No. 8-D-13-SC Pat Head Summitt St (Sewer)**

led: 07/10/2013 11:05 AM

Street Closure (Andy Holt Dr to Chamique Holdclaw Dr) CLT Map#108 Parcel#9  
CityBlocks 10770/10790



Product Warning: This map was produced from the Landbase Information system maintained by KOIS. This map should not be relied on for engineering, design, or surveying work or other similar type uses. The information on this map is dated and has no warranty of merchantability or warranty for fitness of use for a particular purpose, express or implied. This map is produced, printed, and distributed as is, with all faults.



