

8-E-13-SC - ac - city of K



CITY OF KNOXVILLE

Engineering
James R. Hagerman, P.E.
Director of Engineering

July 22, 2013

Mr. Mike Brusseau, AICP, Senior Planner
Knoxville-Knox County Metropolitan Planning Commission
City-County Building, Suite 403
Knoxville, Tennessee 37902

SUBJECT: MPC File # 8-E-13-SC, closure of Fraternity Park Dr between Pat Head Summitt St & Todd Helton Dr (City Blocks 10770, 10730, 10760, 10750, & 10740)

Mr. Brusseau:

The City Engineering Department has no objections to close the above described right-of-way area provided the following conditions, subject to City Engineering approval, are met:

1. Should this right-of-way be closed, the applicant assumes maintenance responsibility for all stormwater systems previously maintained by the City, within the closure area. The applicant will maintain the approved stormwater facilities in good working order acceptable to the City Department of Engineering. Minimum maintenance of the said facilities shall include sediment, debris, oil, hydrocarbons, and foreign materials removal so that the operation and capacity of the stormwater facilities continue to meet acceptable standards.
2. If the applicant subsequently conveys property abutting any closed areas, the applicant shall provide legal access to a public street for ingress/egress, utilities, etc. necessary to support conveyed property.
3. All conditions must be met within one (1) year upon the final approval by City Council. Otherwise, this process will be deemed to be null and void and of no effect.
4. The closing ordinance shall state that the closure shall become effective only after the Department of Engineering has provided written verification to the City Recorder that all conditions have been met.

Sincerely,

Benjamin D. Davidson

Benjamin D. Davidson, PLS, Technical Services Administrator, Department of Engineering
Ph: 865-215-2148

C: Brently J. Johnson, P.E., R.L.S., Engineering Planning Chief
Christopher S. Howley, P.E., Plans Review and Development Inspections



Knoxville Utilities Board



July 9, 2013

Mr. Mike Brusseau
Knoxville-Knox County
Metropolitan Planning Commission
Suite 403, City-County Building
Knoxville, Tennessee 37902

Dear Mr. Brusseau:

**Re: Right-of-Way Closure Request 8-E-13-SC
Block No. 10760 & 10730
CLT No. 108
Parcel No. 10**

We have reviewed our records and find that we have existing utility facilities located within the subject right-of-way. The approximate location of these facilities is indicated on the enclosed prints. However, KUB does not release and hereby retains all easements and rights for existing utility facilities, whether or not shown on these prints.

Should this right-of-way be closed, KUB will require the following permanent easement for its utility facility.

- Gas – 7.5 feet on each side of the centerline of the gas line, 15 feet total width
- Sewer – 7.5 feet on each side of the centerline of the wastewater line, 15 feet total width
- Water – 7.5 feet on each side of the centerline of the water line, 15 feet total width

So long as these conditions are met, KUB has no objection to the closure of this right-of-way. If you have any questions regarding this matter, please call me at (865) 558-2291.

Sincerely,

Greg L. Patterson, P.E.
Engineering

glp/ggt

Enclosure

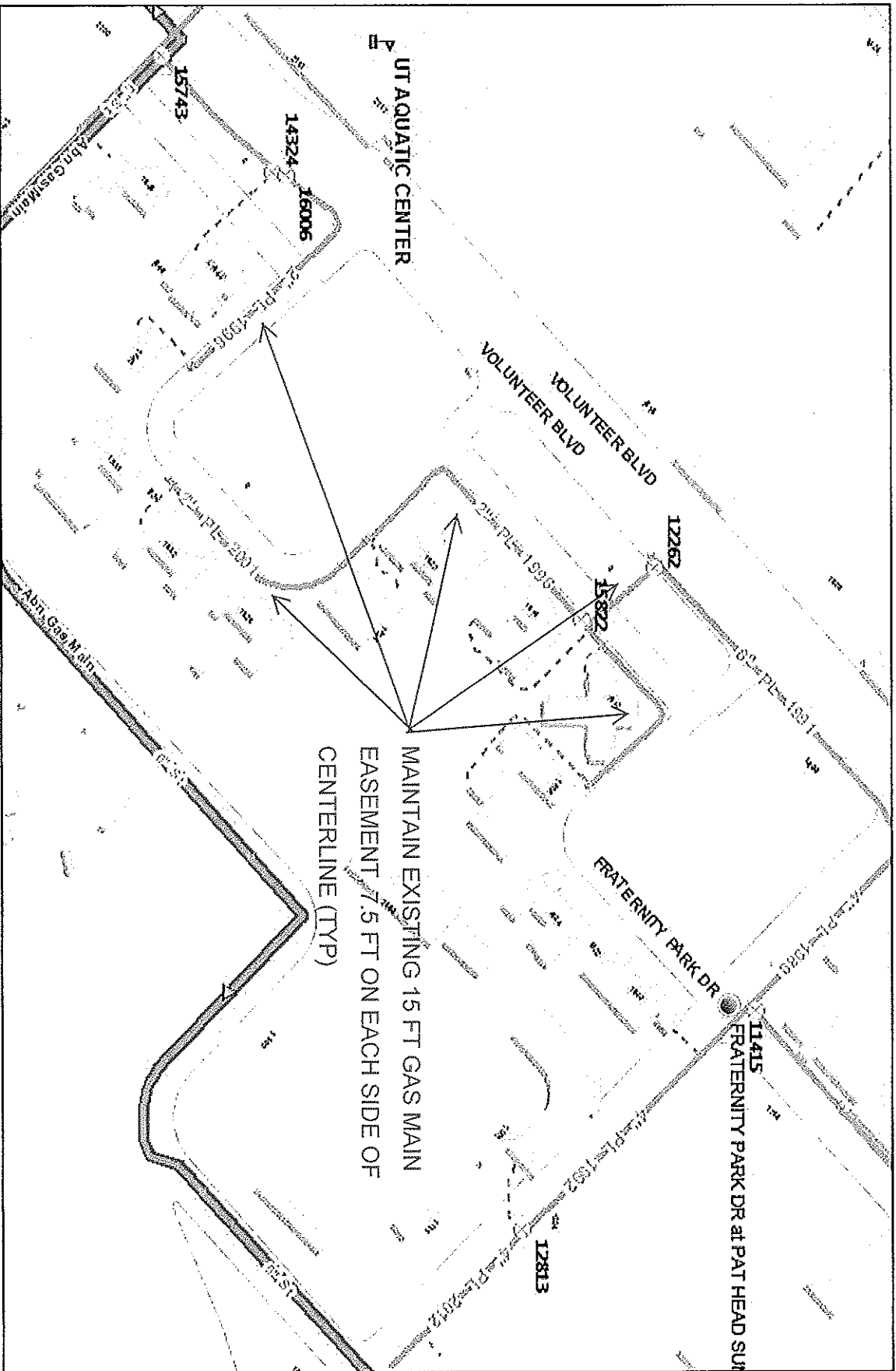

File No. 8-E-13-SC CLOSURE OF Fraternity Park Dr (Gas)

Pat Head Summit St to Todd Helton Drive CLT Map #108 Parcel #10 City Block(s) 10760 & 10730



Knoxville Utilities Board

Product Warning: This map was produced from the Landscape Information system maintained by KUB. This map should not be relied on for engineering, design, or surveying work or other similar type uses. The information on this map is cased and has no warranty of merchantability or warranty for fitness of use for a particular purpose, express or implied. This map is produced, printed, and distributed as is, with all faults.



Printed: 07/08/2013 10:07 PM

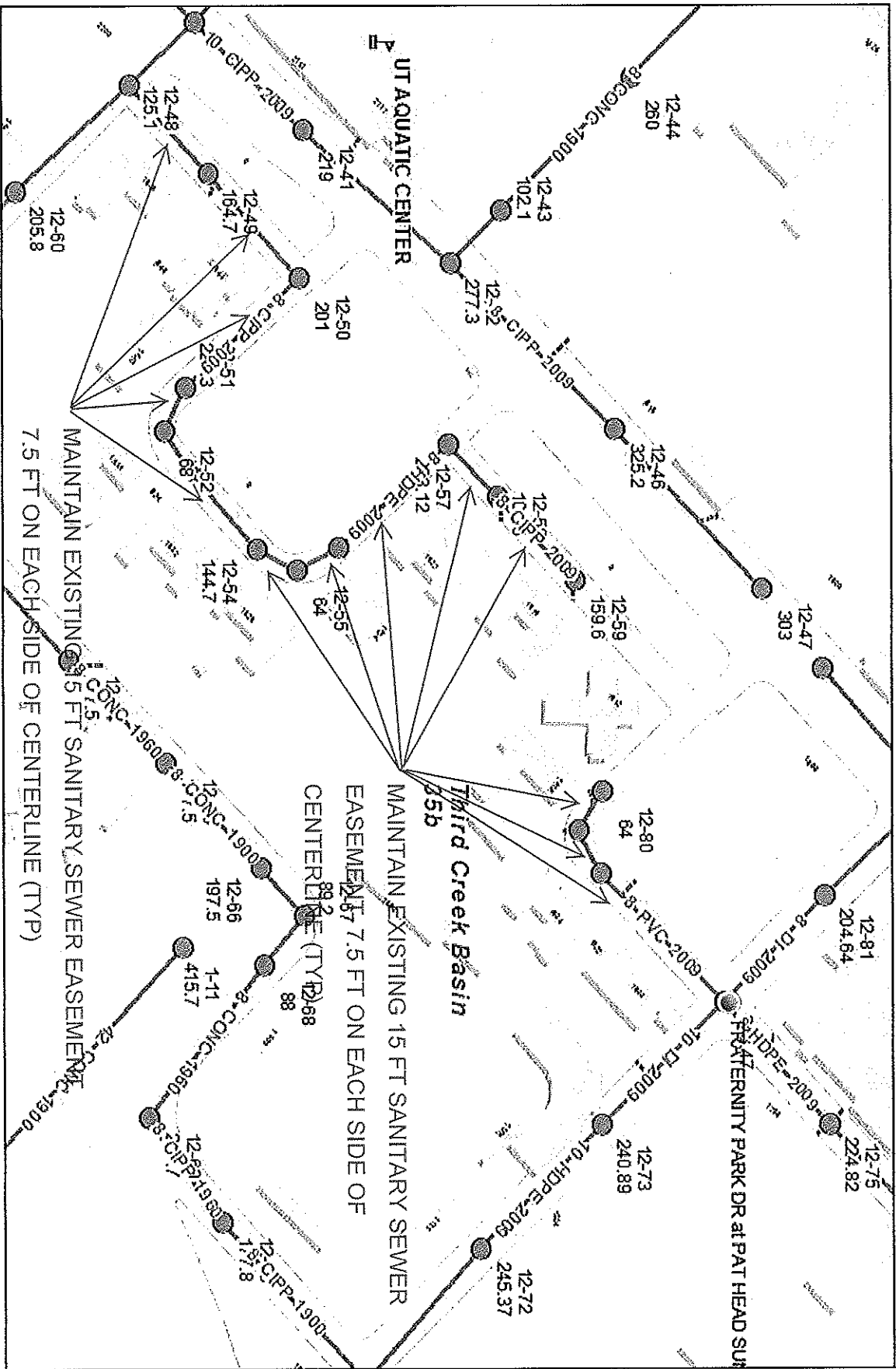

File No. 8-E-13-SC CLOSURE OF Fraternity Park Dr (Sewer)

Pat Head Summit St to Todd Helton Drive CLT Map #108 Parcel #10 City Block(s) 10760 & 10730



Known as Utilities Board

400 Feet



Printed: 07/08/2013 15:57 PM

Product Warning: This map was produced from the Landscape Information System maintained by KUB. This map should not be relied on for engineering, design, or surveying work or other similar type uses. The information on this map is dated and has no warranty of merchantability or warranty for fitness for use for a particular purpose, express or implied. This map is produced, printed, and distributed as is, with all faults.

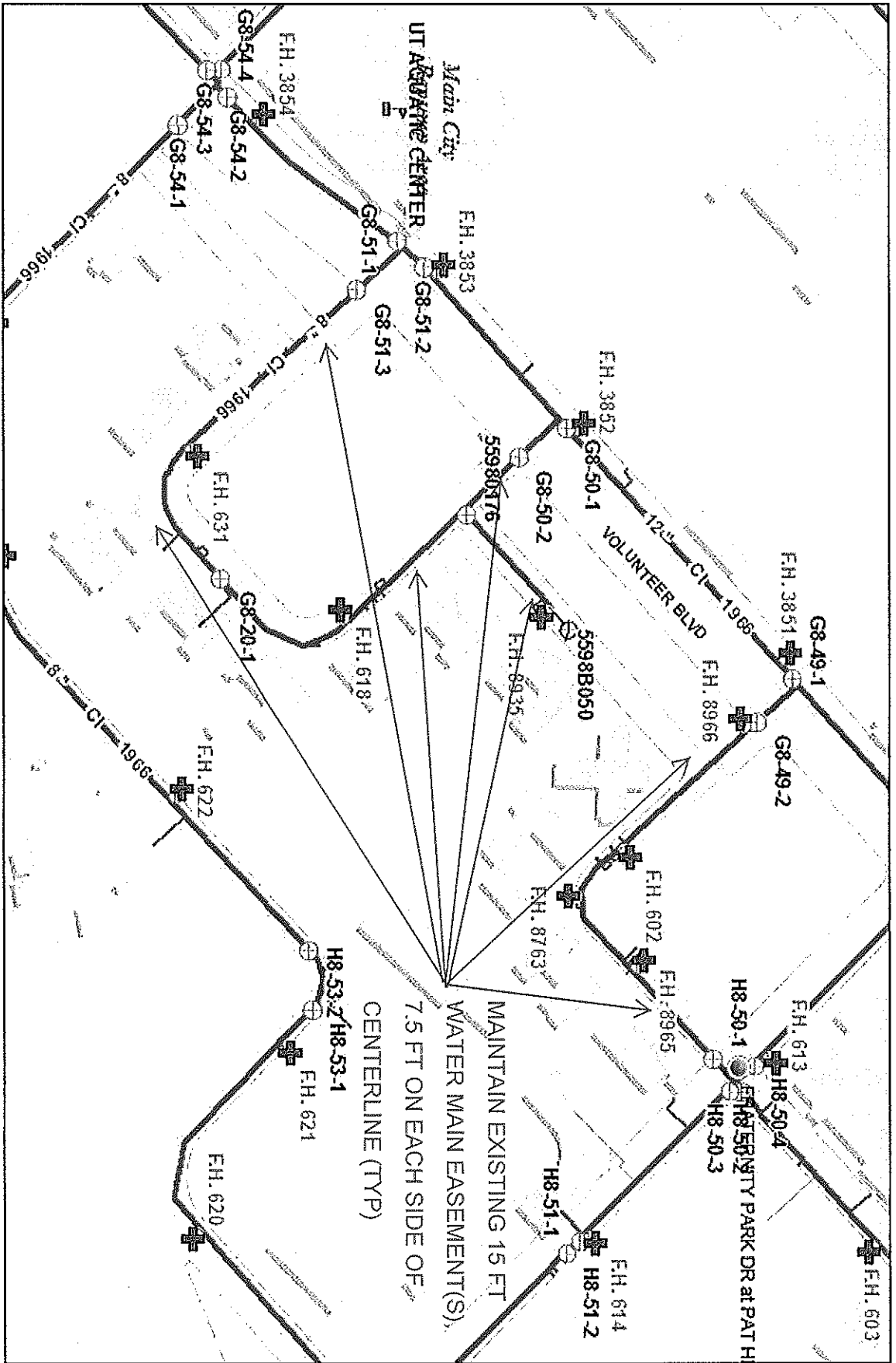

File No. 8-E-13-SC CLOSURE OF Fraternity Park Dr (Water)

Pat Head Summit St to Todd Helton Drive CLT Map #108 Parcel #10 City Block(s) 10760 & 10730



Knowlton Utilities Board



400 Feet

Printed: 07/03/2013 15:07 PM



Product Warning: This map was produced from the Landbase information system maintained by KUB. This map should not be relied on for engineering, design, or surveying work or other similar type uses. The information on this map is dated and has no warranty of merchantability or warranty for fitness of use for a particular purpose, express or implied. This map is produced, printed, and distributed as is, with all faults.