



# CITY OF KNOXVILLE

Engineering  
James R. Hagerman, P.E.  
Director of Engineering

July 22, 2013

Mr. Mike Brusseau, AICP, Senior Planner  
Knoxville-Knox County Metropolitan Planning Commission  
City-County Building, Suite 403  
Knoxville, Tennessee 37902

SUBJECT: MPC File # 8-G-13-SC, closure of Andy Holt Ave between Volunteer Blvd & Melrose Place  
City Blocks 10580, 10582, 10600, 10622, 10680, 10690, 10700, & 10710

Mr. Brusseau:

The City Engineering Department has no objections to close the above described right-of-way area provided the following conditions, subject to City Engineering approval, are met:

1. Should this right-of-way be closed, the applicant assumes maintenance responsibility for all stormwater systems previously maintained by the City, within the closure area. The applicant will maintain the approved stormwater facilities in good working order acceptable to the City Department of Engineering. Minimum maintenance of the said facilities shall include sediment, debris, oil, hydrocarbons, and foreign materials removal so that the operation and capacity of the stormwater facilities continue to meet acceptable standards.
2. If the applicant subsequently conveys property abutting any closed areas, the applicant shall provide legal access to a public street for ingress/egress, utilities, etc. necessary to support conveyed property.
3. The applicant shall dedicate easements over portions of the proposed closure area of Andy Holt Ave to accommodate a public turnaround for the resulting dead-end on Melrose Place. This dedication will be unnecessary provided that Melrose Place is closed as proposed per MPC File No. 8-I-13-SC.
4. The dedicated easements in item no. 3 shall be abandoned and extinguished if Melrose Place is ever closed or other approvable means is provided to prevent a dead-end situation on Melrose Place.
5. The proposed closure area of Andy Holt Ave will prevent ingress/egress to Twenty Second St, which is a public right-of-way. Twenty Second St must be closed by the applicant before the closure of Andy Holt Ave can become effective, or other approvable means must be created to allow for ingress/egress and turnarounds for Twenty Second St.
6. The applicant shall dedicate easements for all control devices located within the proposed closure area of Andy Holt Ave near the intersection of Volunteer Blvd.
7. The easements stated in item no. 6 shall be abandoned and extinguished if the intersecting open public right-of-way areas, on which the traffic control devices are located, are ever closed.
8. All conditions must be met within one (1) year upon the final approval by City Council. Otherwise, this process will be deemed to be null and void and of no effect.
9. The closing ordinance shall state that the closure shall become effective only after the Department of Engineering has provided written verification to the City Recorder that all conditions have been met.

Sincerely,

*Benjamin D. Davidson*

Benjamin D. Davidson, PLS, Technical Services Administrator, Department of Engineering  
Ph: 865-215-2148

8-G-13-SC-con KUB



Knoxville Utilities Board



July 9, 2013

Mr. Mike Brusseau  
Knoxville-Knox County  
Metropolitan Planning Commission  
Suite 403, City-County Building  
Knoxville, Tennessee 37902

Dear Mr. Brusseau:

**Re: Right-of-Way Closure Request 8-G-13-SC  
Block No. 10700 & 10600  
CLT No. 108  
Parcel No. 002**

We have reviewed our records and find that we have existing utility facilities located within the subject right-of-way. The approximate location of these facilities is indicated on the enclosed prints. However, KUB does not release and hereby retains all easements and rights for existing utility facilities, whether or not shown on these prints.

Should this right-of-way be closed, KUB will require the following permanent easement for its utility facility.

Gas – 7.5 feet on each side of the centerline of the gas line, 15 feet total width  
Sewer – 7.5 feet on each side of the centerline of the wastewater line, 15 feet total width  
Water – 7.5 feet on each side of the centerline of the water line, 15 feet total width

So long as these conditions are met, KUB has no objection to the closure of this right-of-way. If you have any questions regarding this matter, please call me at (865) 558-2291.

Sincerely,

A handwritten signature in cursive script that reads 'Greg Patterson'.

Greg L. Patterson, P.E.  
Engineering

glp/ggt

Enclosure



Known as Unknown Board  
 Product Warning: This map was produced from the Landmark Information System maintained by KUB. This map should not be relied on for engineering, design, or surveying work or other similar type work. The information on this map is dated and has no warranty of interchangeability or warranty for fitness of use for a particular purpose, source or method. The map is provided, printed, and distributed as is, with all faults.

**File No. 8-G-13-SC Closure of Andy Holt Avenue (Gas)**  
 Volunteer Blvd to Melrose Place

CLT Map #108

Parcel #302

City Block(s) 10790 & 10800

228 Feet

Printed: 07/06/2019 0:27 AM

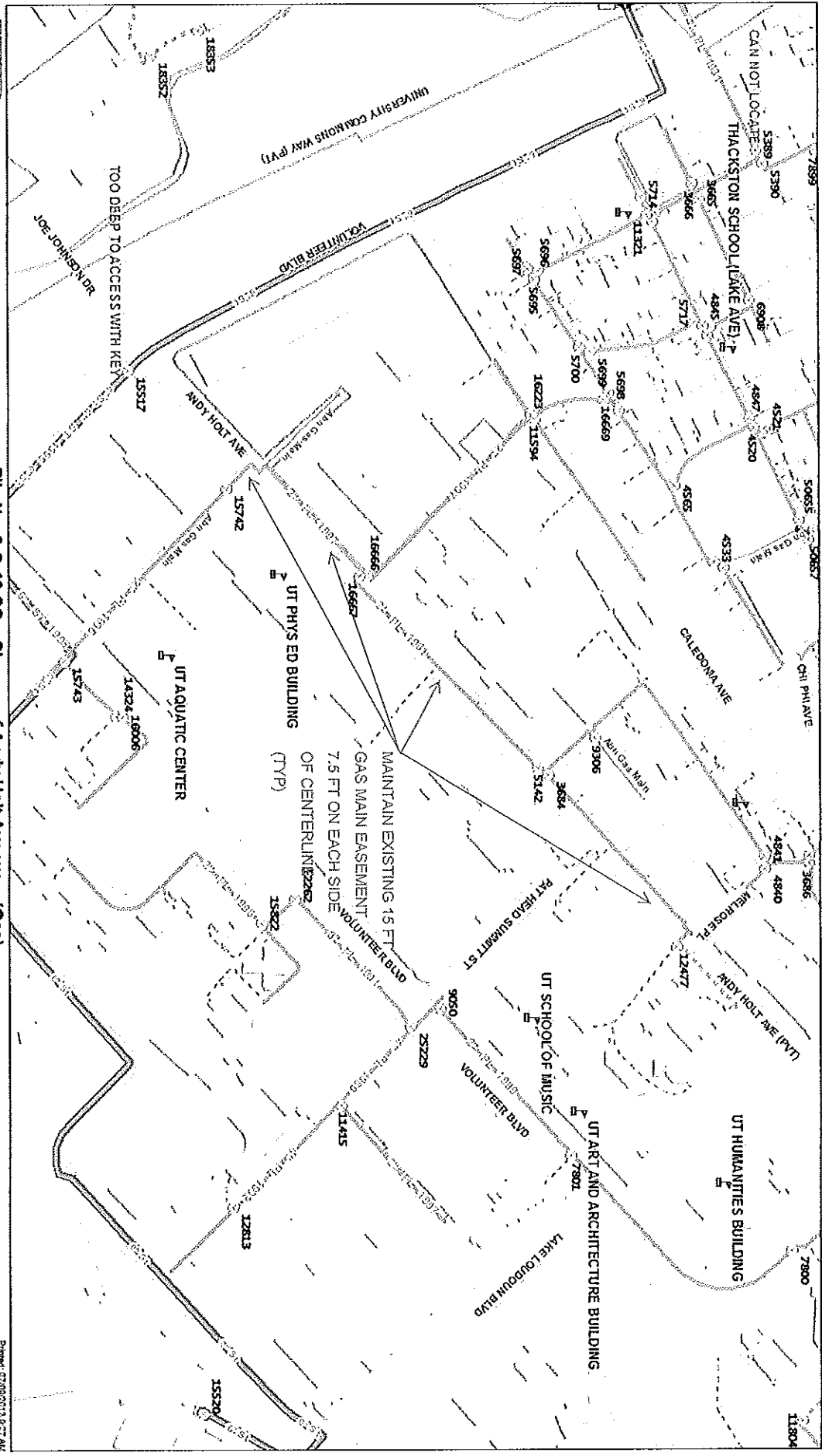



Known as Uniform Board  
 Product Warning: This map was produced from the Landbase Information System maintained by KUB. This map should not be relied on for engineering, design, or surveying work or other similar type uses. The information on this map is created and has no warranty of inaccuracy or warranty for fitness of use for a particular purpose, source or method. The map is provided, printed, and distributed as is, with all faults.

Volunteer Blvd to Melrose Place

CLT Map #108

Parcel #002

City Block(s) 1079D & 1089D

**File No. 8-G-13-SC Closure of Andy Holt Avenue (Sewer)**



Printed 07/06/2013 9:27 AM

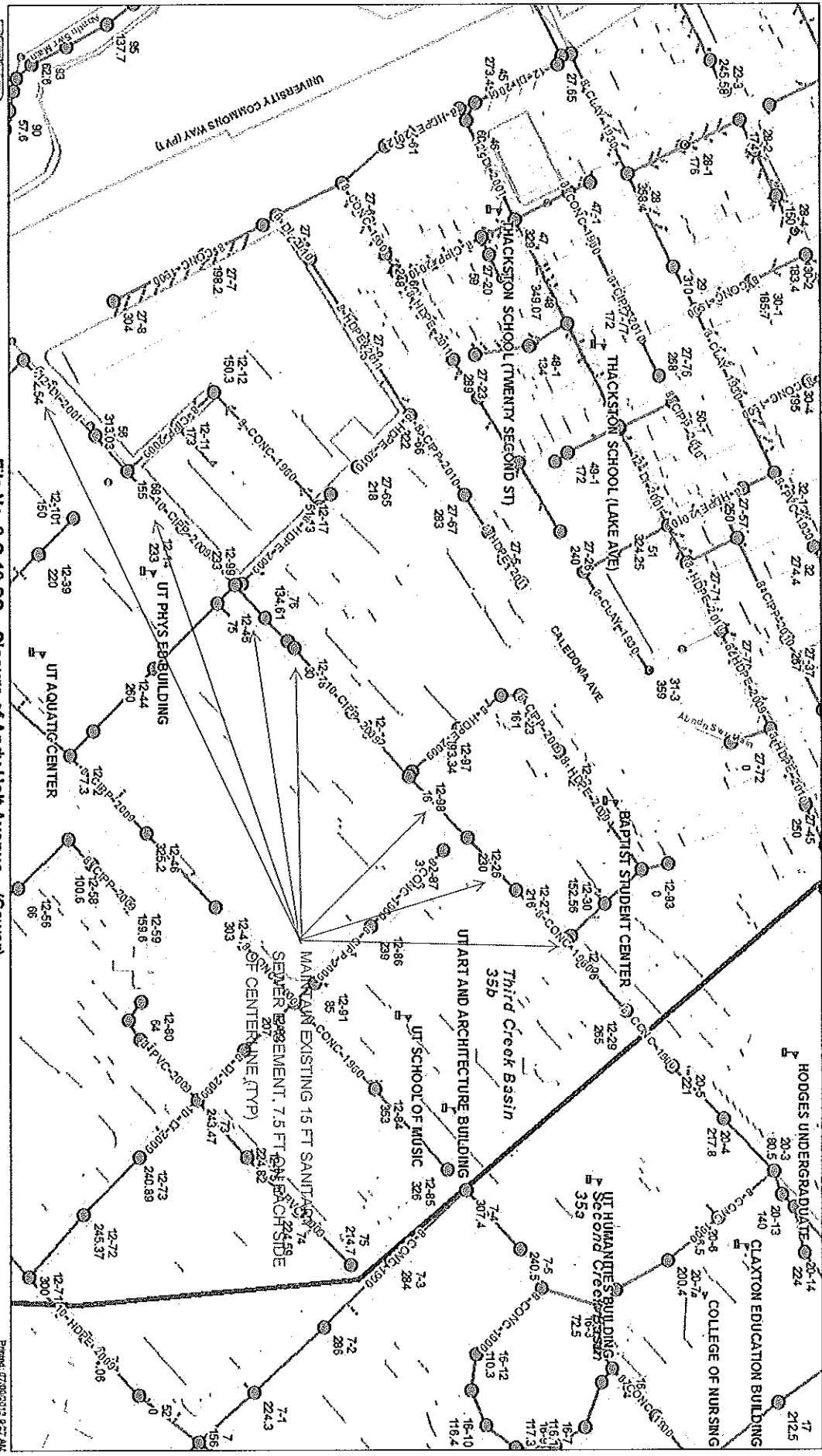

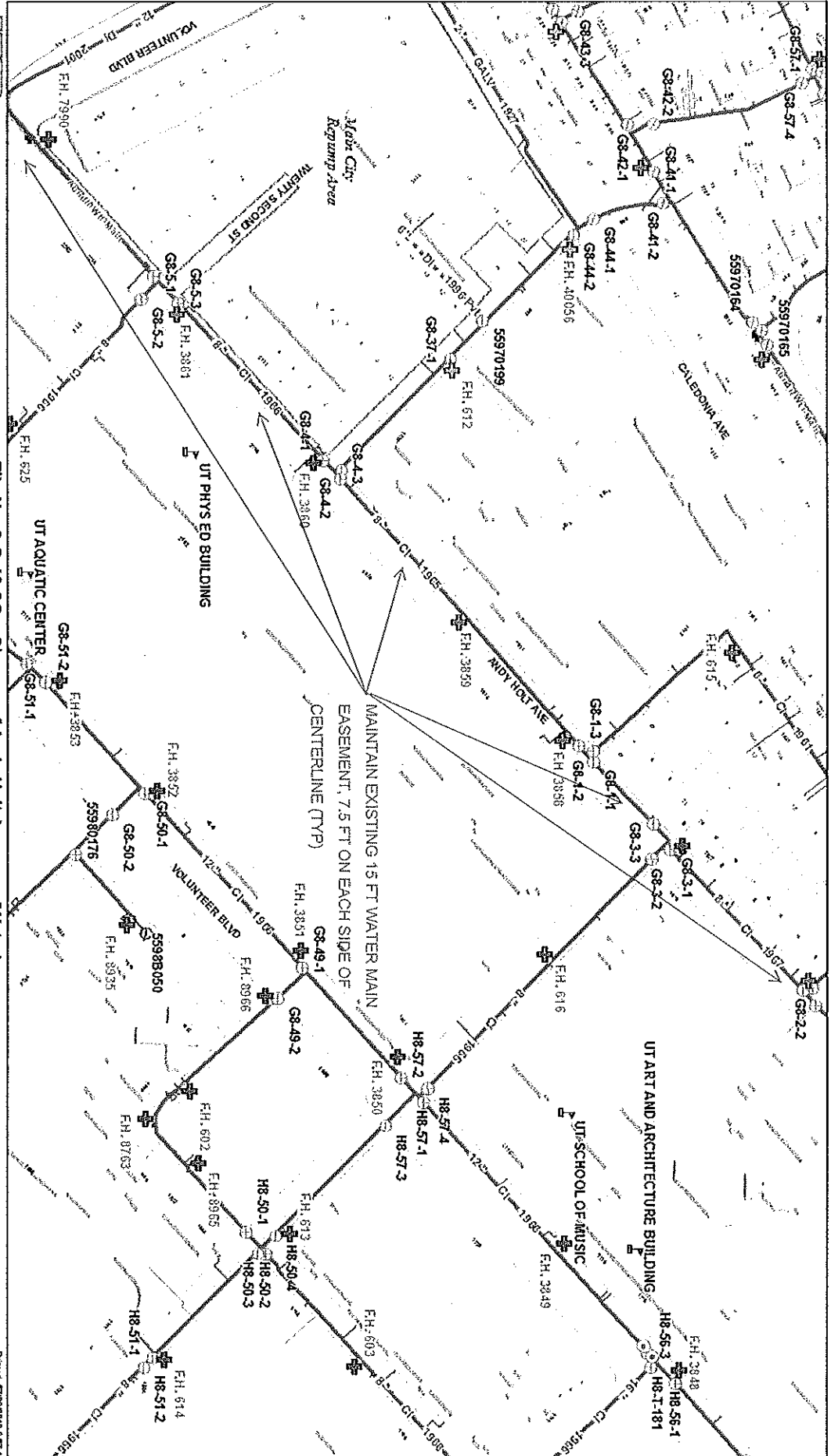

Known as Utah State Board  
 Product Warning: This map was produced from the licensee information system maintained by KUB. This map should not be relied on for engineering, design, or surveying work or other similar uses. The information on this map is stated and has no warranty or merchantability or warranty for fitness of use for a particular purpose, express or implied.  
 The map is produced, printed, and distributed as is, with all faults.

File No. 8-G-13-SC Closure of Andy Holt Avenue (Water)  
 Volunteer Blvd to Melissa Place  
 Parcel #002  
 City Block(s) 10700 & 10600

CLT Map #108  
 300 Feet



Printed: 07/03/2013 0:27 AM