

**NEW WORSHIP CENTER**

ARLINGTON BAPTIST CHURCH  
LIFESPING LANE  
KNOXVILLE, TN 37918

**PROPOSED SITE PLAN**

AS INSTRUMENTS OF SERVICE, THESE DRAWINGS AND THE DESIGN REPRESENTED BY THEM ARE THE PROPERTY OF DAWN A. FALCONNIER AND AS SUCH ARE PROTECTED BY STATE AND FEDERAL COPYRIGHT LAWS. REPRODUCTION OR USE OF THESE DRAWINGS OTHER THAN FOR THE PROJECT INTENDED WITHOUT WRITTEN CONSENT FROM DAWN A. FALCONNIER IS PROHIBITED. UNAUTHORIZED USE WILL BE SUBJECT TO LEGAL ACTION.

DRAWN BY:	GHF/JR
CHECKED BY:	DAF
ISSUED:	~
REVISION(S):	~
FILE#:	2010-020

**GRAPHIC LEGEND**

- INDICATES PROPERTY LINES
- INDICATES BUILDING SETBACK LINE
- INDICATES STORM WATER DETENTION BASIN
- PHASE 1 - 13,334 S.F. INTERIM AUDITORIUM - 210 SEATS NURSERY/TODDLER AREAS YOUTH & CHILDREN AREAS ADULT CLASSROOMS
- PHASE 1a - 4,652 S.F. MODULAR BUILDING OFFICES AND CLASS ROOMS
- PHASE 1b - 17,060 S.F. MAIN AUDITORIUM - 400 SEATS SUNDAY SCHOOL CLASSROOMS FELLOWSHIP AREA, CONVERT Ph 1 AUDITORIUM TO YOUTH MULTI-PURPOSE SPACE
- PHASE 2 - 8,000 S.F. CHRISTIAN EDUCATION MINISTRY
- PHASE 3 - 8,100 S.F. MULTI-LINGUAL MINISTRY
- INDICATES PHASE 1 CHURCH PARKING - 107 SPACES
- INDICATES FUTURE PARKING
- INDICATES 3/4 MILE WALKING TRAIL
- INDICATES APPROXIMATE EXISTING CONTOUR LINES. NUMBER INDICATES HEIGHT ABOVE SEA LEVEL. TOPO TRACED FROM KGIS TOPOGRAPHICAL DATA OBTAINED FROM THE SURVEYOR.
- FH INDICATES NEW FIRE HYDRANT(S) TO MEET 600-FOOT HOSE LAY, 100-FOOT FIRE DEPARTMENT CONNECTION REQUIREMENTS, AND FIRE FLOW REQUIREMENTS. NUMBER SHOWN IS NOT TO BE CONSIDERED THE MINIMUM REQUIRED.

**PARKING**

**PARKING REQUIREMENTS:**  
CITY CODE APPENDIX B, ARTICLE V, SECTION 7, §A.(3)(a)

CHURCH: GREATER OF 1 PER 3 AUDITORIUM SEATS OR 1 PER 25 SQ.FT. OF AUDITORIUM

**PARKING PROVIDED:**

CHURCH: PHASE 1:  
REQU. REQD: 2,675 SQ.FT. + 25= 107  
PROVIDED: 107

CHURCH TOTAL (ALL PHASES): 330 SPACES  
330 SPACES MEETS ZONING ORDINANCE REQUIREMENTS FOR 890 SEATS. PERMANENT AUDITORIUM WILL REPLACE INTERIM AUDITORIUM FOR WORSHIP SERVICES.  
REQUIRED ACCESSIBLE SPACES FOR CHURCH: 8

**PLANTING LEGEND**

- NOTE:**  
LANDSCAPING SHOWN IS FOR PHASE 1 DEVELOPMENT ONLY. DUE TO SCALE OF DRAWING, DETAIL LAYOUT OF INDIVIDUAL PLANTED BEDS IS CONJECTURAL.
- INDICATES EVERGREEN TREES, 20 FT. MATURE HEIGHT (8 FT INSTALLED HEIGHT) MPC TYPE "B" CONTINUOUS SCREEN, 10'-0" O.C.
  - INDICATES WILLOW OAK TREE
  - SWEETSAY MAGNOLIA
  - DOGWOOD
  - BUILDING WALL AND PARKING ISLAND PLANTING: MIX OF SEASONAL COLOR, OTTO LUYKEN LAUREL, OAKLEAF HYDRAGEA, LEATHER LEAF VERNUM

**SITE DATA**

SITE ZONE: RP-1(PLANNED RESIDENTIAL), 1-5 DWELLINGS/ACRE  
MAP & PARCEL No.: 049 093  
SITE AREA: (AS SHOWN) 22.70 ACRES (INCLUDING "SIGN AREA" AND "PROPOSED ACCESS EASEMENTS")  
PLAT: "ARLINGTON PLACE" LOT 2  
MUNICIPAL JURISDICTION: CITY OF KNOXVILLE, TN

CHURCH USE IS SUBJECT TO "USE ON REVIEW" PER CITY CODE APPENDIX B, ARTICLE IV, SECTION 3.1, §(C), (4) AND (6). "USE ON REVIEW" APPLICATIONS ARE MADE TO THE KNOXVILLE-KNOX COUNTY METROPOLITAN PLANNING COMMISSION.

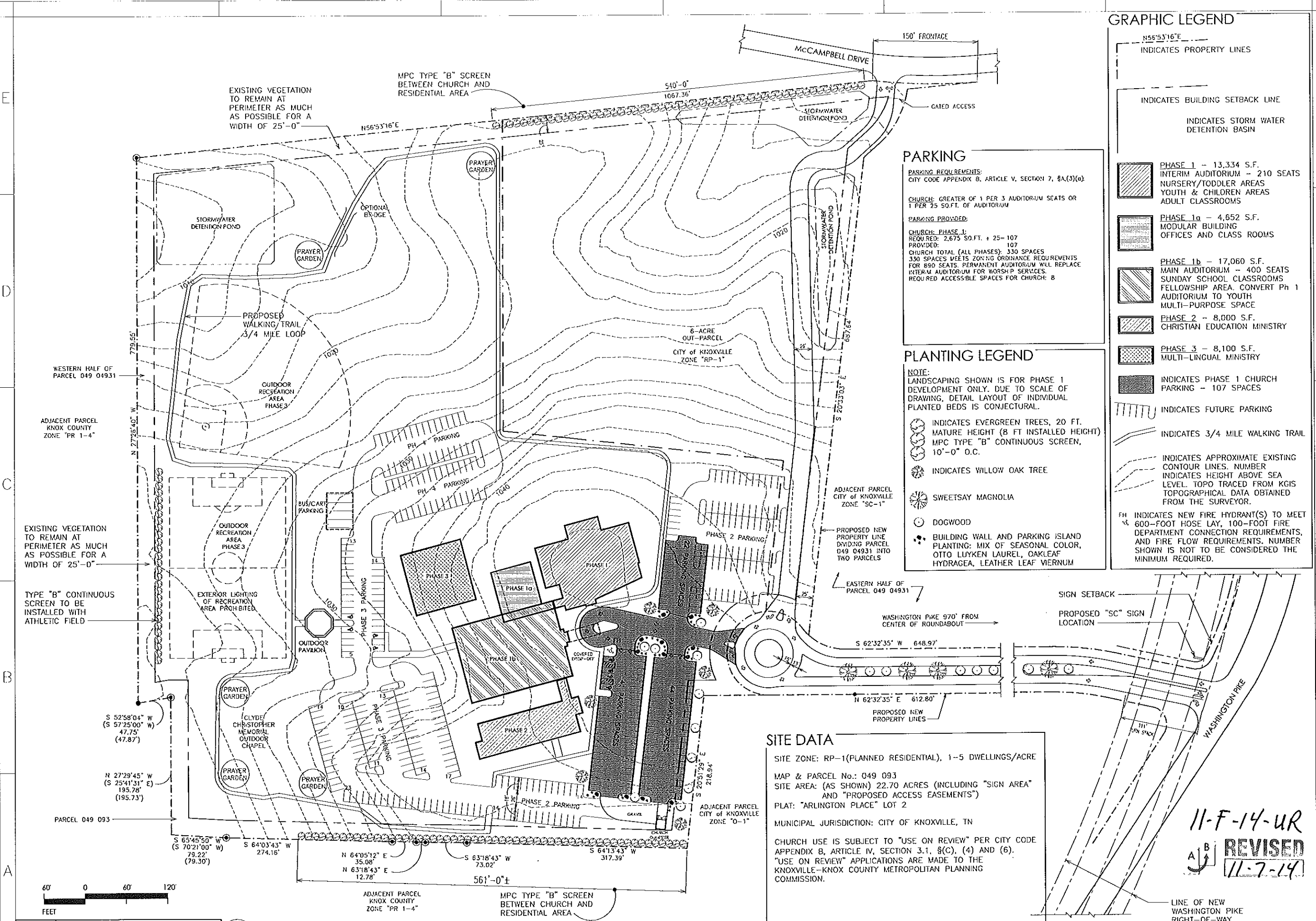

**A1 PROPOSED SITE PLAN**  
1" = 60'-0"

11-F-14-UR  
REVISED  
11-7-14