

From: [Anne Wallace](#)
To: [Ben Davidson](#)
Cc: [Bob Whetzel](#)
Subject: RE: U.T. road closure requests
Date: Thursday, July 23, 2015 2:24:13 PM
Attachments: [image001.gif](#)

Good afternoon Ben,

In follow up to our meeting yesterday regarding UT road closure requests, you asked that I provide a brief statement about the requested closure of W. Volunteer Blvd (the section from Joe Johnson to Cumberland Avenue). Please see below and let me know if you need anything else. I'll be in touch later on the Chi Phi request.

Thank you!

Anne

Anne Wallace, AICP, Associate ASLA
Project Manager
Office of Redevelopment
400 Main Street, Ste. 655, Knoxville, TN 37902
865.215.2644 (o) 865.215.3035 (f)
email: awallace@knoxvilletn.gov *
web: www.knoxvilletn.gov/cumberland *



*Please note the city has launched a new website and email addresses have changed.

The Office of Redevelopment has concerns about the requested closure of ROW along W. Volunteer Blvd. from Cumberland Avenue to Joe Johnson bridge. In the short term, the route has been designated as a key detour for the Phase I Cumberland Avenue construction. In Phase II, it is anticipated that W. Volunteer Blvd. will be utilized as an alternate route from campus to avoid construction in the road diet portion of the project which is scheduled to be completed August 2017. Additionally, beyond the reconstruction of Cumberland Avenue, W. Volunteer Blvd. has more than 50 on street parking spaces that could be utilized to support the businesses as well as university use. The city is currently working to improve on street parking enforcement in the district and long term revenue is an important component of being able to fund this enforcement.

8-F-15-SC, with Long Eng



CITY OF KNOXVILLE

Engineering
James R. Hagerman, P.E.
Director of Engineering

August 10, 2015

Mr. Mike Brusseau, AICP, Senior Planner
Knoxville-Knox County Metropolitan Planning Commission
City-County Building, Suite 403
Knoxville, Tennessee 37902

SUBJECT: Proposed Closure of Volunteer Blvd between Todd Helton Dr and Cumberland Ave
MPC File # 8-F-15-SC; City Blocks 10482, 10582, 10600, 10640, 10720, 10750, 10790, 10820.

Mr. Brusseau:

The City Engineering Department has no objection to the proposed closure area of Volunteer Blvd between Todd Helton Drive and Cumberland Ave.

However, should this area of Volunteer Blvd be closed, the applicant assumes maintenance responsibility for all stormwater systems previously maintained by the City, within or near the closure area. The applicant will maintain the approved stormwater facilities in good working order acceptable to the City Department of Engineering. Minimum maintenance of the said facilities shall include sediment, debris, oil, hydrocarbons, and foreign materials removal so that the operation and capacity of the stormwater facilities continue to meet acceptable standards.

Easements will be reserved by the City for traffic control devices that are currently maintained by the City, if any, located within or near the closure area that serve any adjacent *open public right-of-ways*. It is understood that the easements shall include traversable access and area to perform maintenance on the devices. These easements may be extinguished if the streets in which they serve are closed or if other acceptable maintenance plans are implemented, subject to City Engineering approval.

Sincerely,

Benjamin D. Davidson, PLS, Technical Services Administrator, Department of Engineering
Ph: 865-215-2148

8-F-15-SC, Vol. Long Eng



CITY OF KNOXVILLE

Engineering
James R. Hagerman, P.E.
Director of Engineering

August 10, 2015

Mr. Mike Brusseau, AICP, Senior Planner
Knoxville-Knox County Metropolitan Planning Commission
City-County Building, Suite 403
Knoxville, Tennessee 37902

SUBJECT: Proposed Closure of Volunteer Blvd between Todd Helton Dr and Cumberland Ave
MPC File # 8-F-15-SC; City Blocks 10482, 10582, 10600, 10640, 10720, 10750, 10790, 10820.

Mr. Brusseau:

The City Engineering Department has no objection to the proposed closure area of Volunteer Blvd between Todd Helton Drive and Cumberland Ave.

However, should this area of Volunteer Blvd be closed, the applicant assumes maintenance responsibility for all stormwater systems previously maintained by the City, within or near the closure area. The applicant will maintain the approved stormwater facilities in good working order acceptable to the City Department of Engineering. Minimum maintenance of the said facilities shall include sediment, debris, oil, hydrocarbons, and foreign materials removal so that the operation and capacity of the stormwater facilities continue to meet acceptable standards.

Easements will be reserved by the City for traffic control devices that are currently maintained by the City, if any, located within or near the closure area that serve any adjacent *open public right-of-ways*. It is understood that the easements shall include traversable access and area to perform maintenance on the devices. These easements may be extinguished if the streets in which they serve are closed or if other acceptable maintenance plans are implemented, subject to City Engineering approval.

Sincerely,

Benjamin D. Davidson, PLS, Technical Services Administrator, Department of Engineering
Ph: 865-215-2148

8-F-15-SC-cor-CityFire



Fire Prevention Bureau

City of Knoxville
400 Main Street, Suite 539
Knoxville, TN 37902



Memorandum

Date: July 30, 2015
To: Mike Brusseau
From: Sonny Partin, Deputy Fire Marshal
Subject: Request for Information on Right of Way Closures, Fire Department Review

Road Name	Review Status	Comments
1. Alley between W. Caldwell and W. Quincy	Approved	None 8-A-15-AC
2. Alley- Geyland Hgts.	Disapproved	Provide more detail on map 8-B-15-AC
3. Alley between White and Cumberland	Approved	None 8-C-15-AC
4. Alley between Thirteenth and western terminus	Approved	None 8-D-15-AC
5. Log Haven Dr.	Disapproved	Provide more detail on map 8-A-15-SC
6. Cherokee Cove Rd.	Disapproved	Provide more detail on map 8-B-15-SC
7. Chi Phi Ave.	Approved	None 8-C-15-SC
8. Melrose Ave.	Approved	Road width cannot be reduced 8-D-15-SC
9. Melrose Pl.	Approved	Road width cannot be reduced 8-E-15-SC
10. Volunteer	Approved	Road width cannot be reduced 8-F-15-SC ✓
11. Horizon	Approved	None 8-G-15-SC



Knoxville Utilities Board



July 21, 2015

Mr. Mike Brusseau
Knoxville-Knox County
Metropolitan Planning Commission
Suite 403, City-County Building
Knoxville, Tennessee 37902

Dear Mr. Brusseau:

**Re: Right-of-Way Closure Request 8-F-15-SC
Block No. 10482, 10582, 10600, 10640, 10720 and 10750
CLT No. 108
Parcel No. 11**

We have reviewed our records and find that we have existing utility facilities located within the subject right-of-way. The approximate location of these facilities is indicated on the enclosed prints. However, KUB does not release and hereby retains all easements and rights for existing utility facilities, whether or not shown on these prints.

Should this right-of-way be closed, KUB will require the following permanent easement for its utility facility.

- Gas – 7.5 feet on each side of the centerline of the gas line, 15 feet total width
- Sewer – 7.5 feet on each side of the centerline of the wastewater line, 15 feet total width
- Water – 7.5 feet on each side of the centerline of the water line, 15 feet total width

So long as these conditions are met, KUB has no objection to the closure of this right-of-way. If you have any questions regarding this matter, please call me at (865) 558-2291.

Sincerely,

Greg L. Patterson, P.E.
Engineering

GLP/ggt

Enclosure

**MAINTAIN EXISTING 15 FT GAS
LINE EASEMENTS, 7.5 FT ON
EACH SIDE OF CENTERLINE
(TYP)**

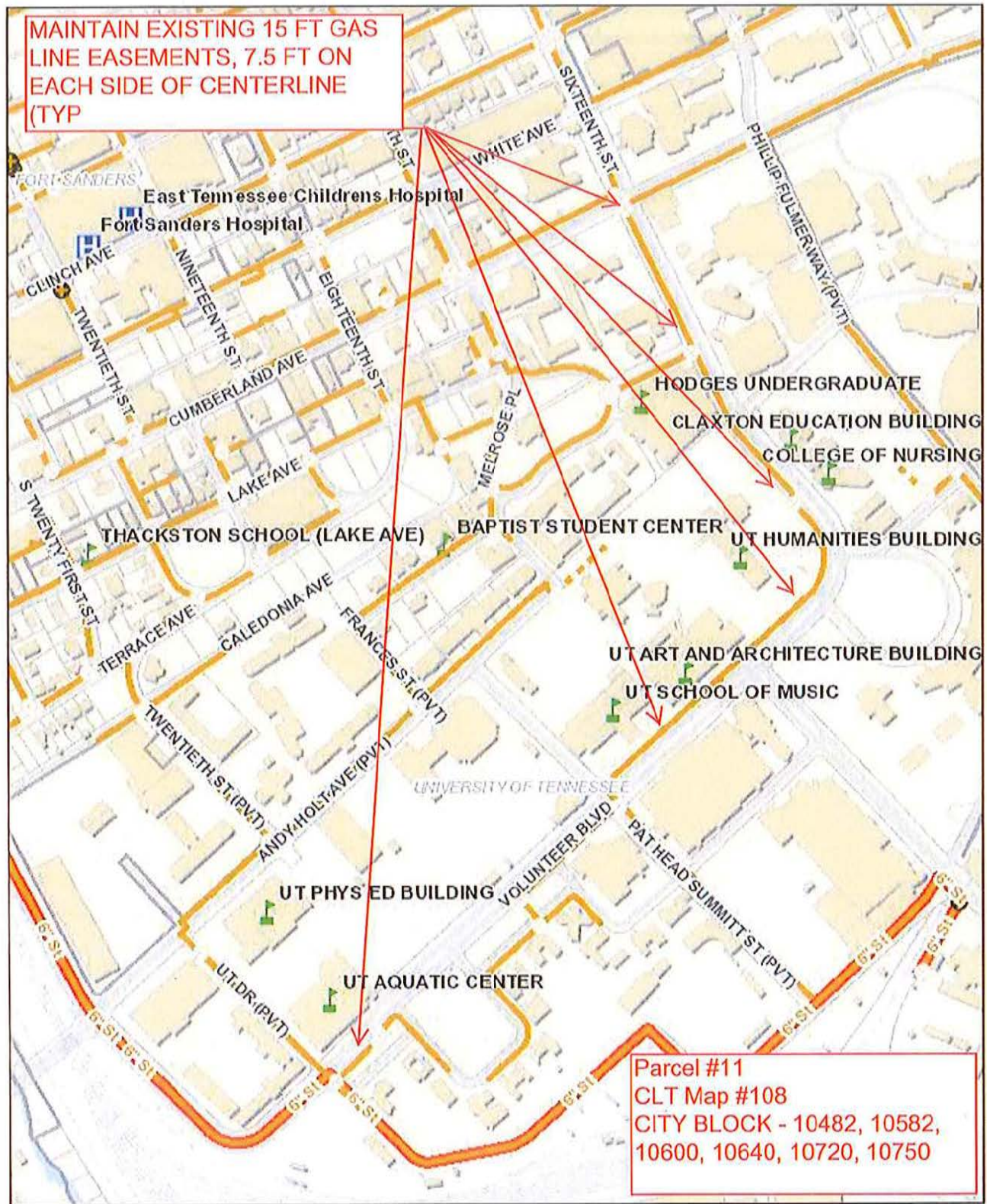

**Parcel #11
CLT Map #108
CITY BLOCK - 10482, 10582,
10600, 10640, 10720, 10750**



Knoxville Utilities Board

File No. 8-F-15-SC Volunteer Blvd (Gas)

Street Closure Between Todd Helton Dr & Volunteer Blvd



ted: 07/20/2015 13:34 PM



Product Warning: This map was produced from the Landbase information system maintained by GIS. This map should not be relied on for engineering, design, or surveying work or other similar type uses. The information on this map is dated and has no warranty of merchantability or warranty for fitness of use for a particular purpose, express or implied. This map is produced, printed, and distributed as is, with all faults.

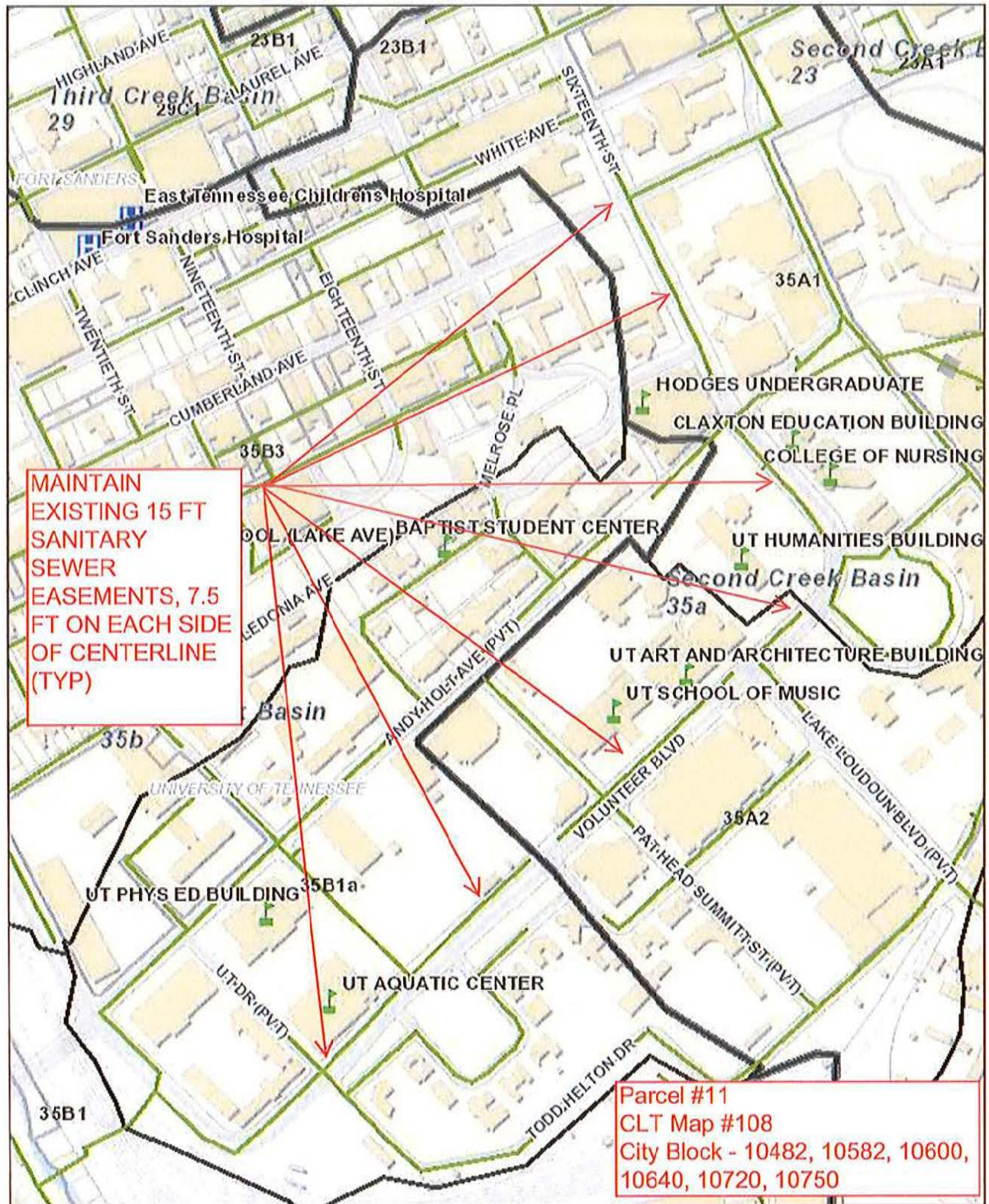

**MAINTAIN
EXISTING 15 FT
SANITARY
SEWER
EASEMENTS, 7.5
FT ON EACH SIDE
OF CENTERLINE
(TYP)**

**Parcel #11
CLT Map #108
City Block - 10482, 10582, 10600,
10640, 10720, 10750**



File No. 8-F-15-SC Volunteer Blvd (Sewer)

ted: 07/20/2015 13:34 PM

Street Closure Between Todd Helton Dr & Volunteer Blvd



Product Warning: This map was produced from the Landbase Information system maintained by KUIS. This map should not be relied on for engineering, design, or surveying work or other similar type uses. The information on this map is dated and has no warranty of merchantability or warranty of fitness for use for a particular purpose, express or implied. This map is produced, printed, and distributed as is, with all faults.

**MAINTAIN
EXISTING 15 FT
WATERLINE
EASEMENTS, 7.5
FT ON EACH SIDE
OF CENTERLINE
(TYP)**

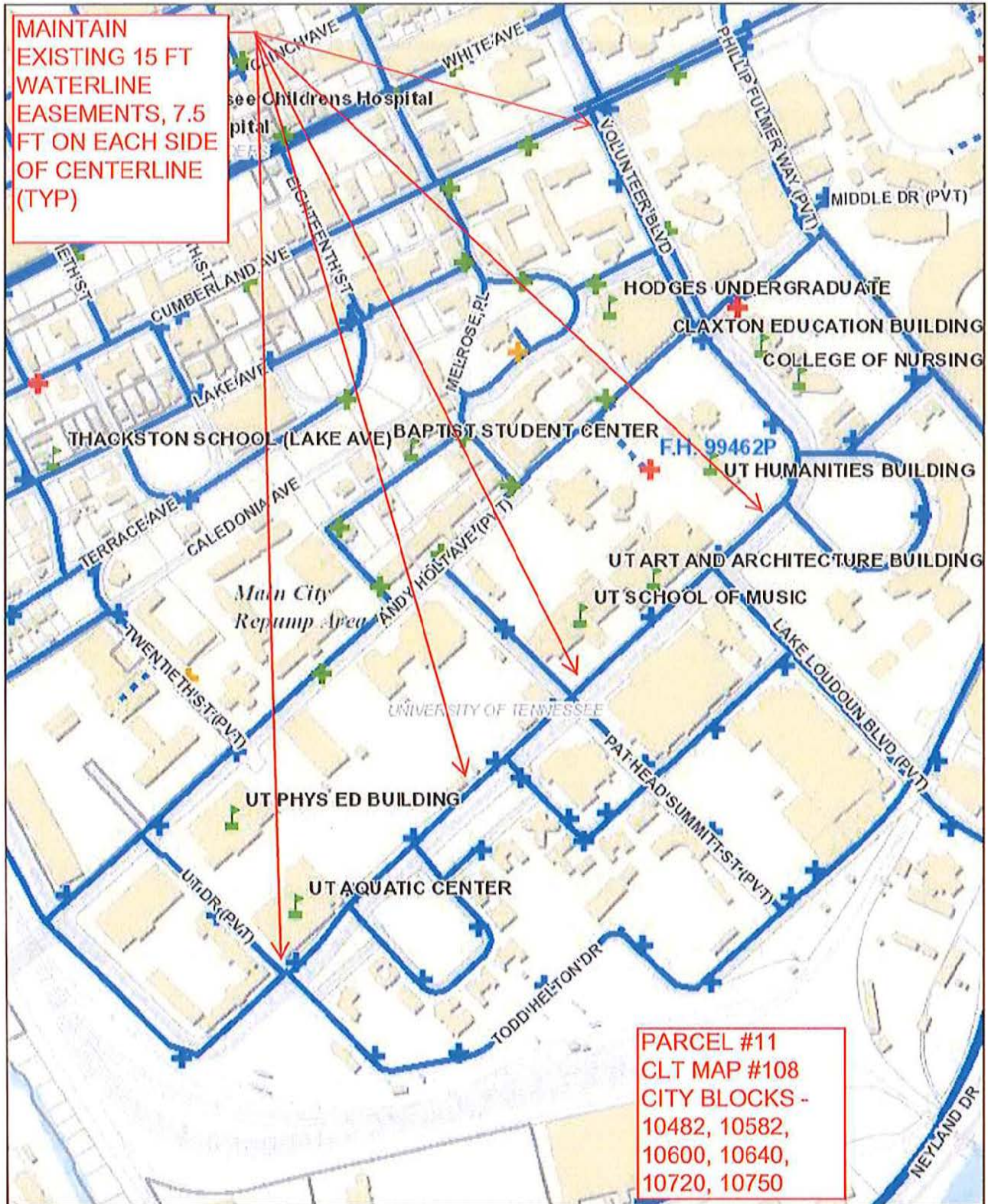

**PARCEL #11
CLT MAP #108
CITY BLOCKS -
10482, 10582,
10600, 10640,
10720, 10750**



Knoxville Utilities Board

File No. 8-F-15-SC Volunteer Blvd (Water)

dated: 07/20/2015 13:34 PM

Street Closure Between Todd Helton Dr & Volunteer Blvd



1065 Feet

Product Warning: This map was produced from the Landbase information system maintained by KGIS. This map should not be relied on for engineering, design, or surveying work or other similar type uses. The information on this map is dated and has no warranty of merchantability or warranty for fitness of use for a particular purpose, express or implied. This map is produced, printed, and distributed as is, with all faults.