

11-A-15-AC Cox City Eng



CITY OF KNOXVILLE

Engineering
James R. Hagerman, P.E.
Director of Engineering



October 29, 2015

Mr. Mike Brusseau, AICP, Senior Planner
Knoxville-Knox County Metropolitan Planning Commission
City-County Building, Suite 403
Knoxville, Tennessee 37902

SUBJECT: Closure of an unnamed alley off Forest Ave
MPC File # 11-A-15-AC; City Block 10146; Tax I.D. 094J.J.001

Mr. Brusseau:

The City Engineering Department has no objections to close the above reference right-of-way area.

However, should this right-of-way be closed, the City will reserve easements for all drainage facilities and utilities, if any, located in or within five (5) feet of the property described herein.

Sincerely,

Benjamin D. Davidson

Benjamin D. Davidson, PLS, Technical Services Administrator, Department of Engineering
Ph: 865-215-2148

11-A-15-AC - cor - KUB



Knoxville Utilities Board



October 19, 2015

Mr. Mike Brusseau
Knoxville-Knox County
Metropolitan Planning Commission
Suite 403, City-County Building
Knoxville, Tennessee 37902

Dear Mr. Brusseau:

**Re: Right-of-Way Closure Request 11-A-15-AC
Block No. 10146
CLT No. 94
Parcel No. 4,6,7,8**

We have reviewed our records and find that we have existing utility facilities located within the subject right-of-way. The approximate location of these facilities is indicated on the enclosed prints. However, KUB does not release and hereby retains all easements and rights for existing utility facilities, whether or not shown on these prints.

Should this right-of-way be closed, KUB will require the following permanent easement for its utility facility.

Gas – 7.5 feet on each side of the centerline of the gas line, 15 feet total width
Sewer – 7.5 feet on each side of the centerline of the wastewater line, 15 feet total width

So long as these conditions are met, KUB has no objection to the closure of this right-of-way. If you have any questions regarding this matter, please call me at (865) 558-2291.

Sincerely,

A handwritten signature in cursive script that reads 'Greg L. Patterson'.

Greg L. Patterson, P.E.
Engineering

GLP/ggt

Enclosure

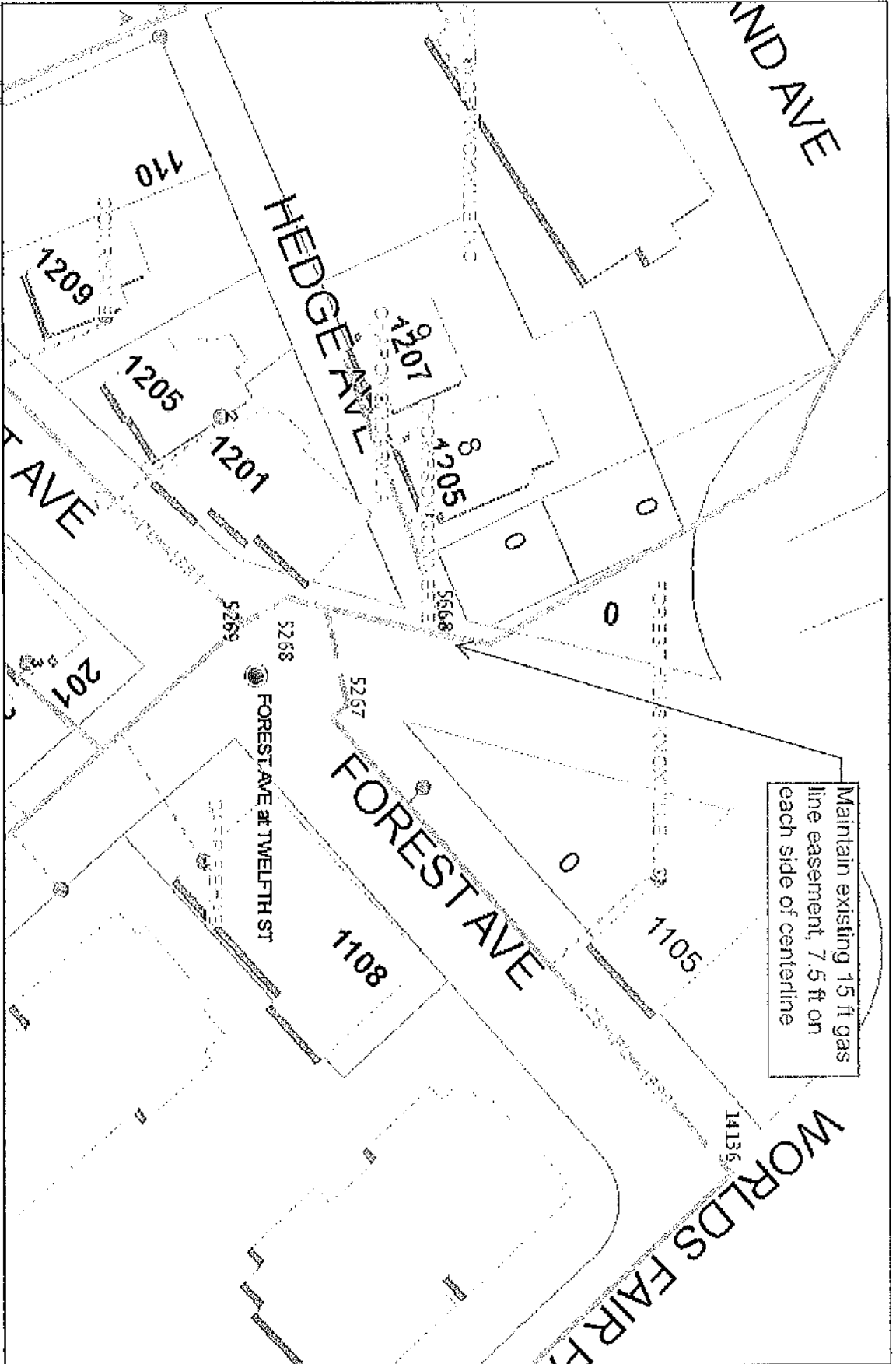

Maintain existing 15 ft gas line easement, 7.5 ft on each side of centerline



Knowlton Utilities Board

File No. 11-A-15-AC Unnamed Alley (gas)

CITY MAP #94

CITY BLOCK #10148

PARCELS #4, 6, 7, 8



Printed: 10/18/2015 15:25 PM



Product Warning: This map was produced from the Landbase information system maintained by KUB. This map should not be relied on for engineering, design, or surveying work or other similar type uses. The information on this map is dated and has no warranty of merchantability or warranty for fitness of use for a particular purpose, express or implied. This map is produced, printed, and distributed as is, with all faults.

Maintain existing 15 ft sanitary sewer easement, 7.5 ft on each of centerline (typ)

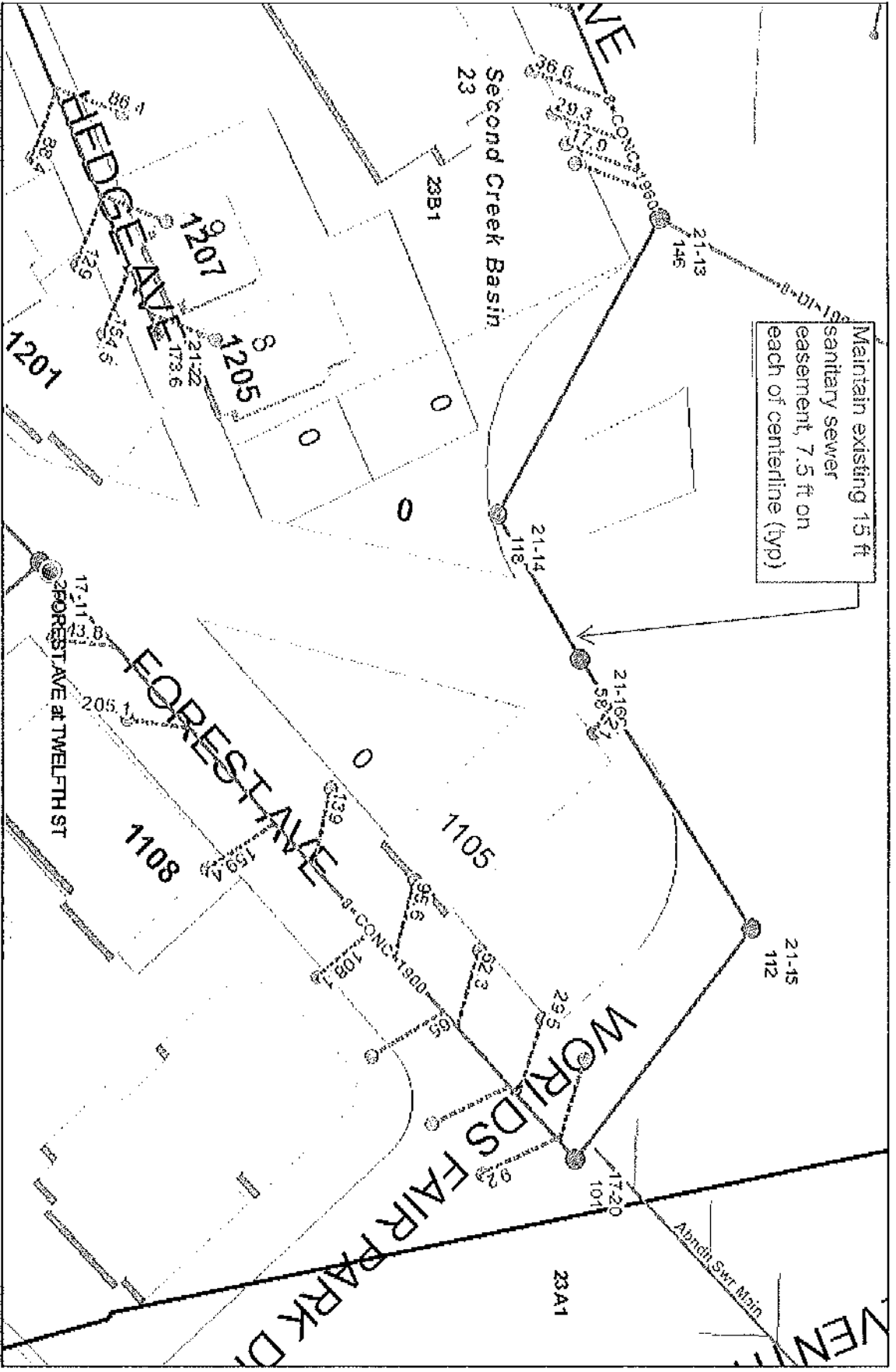

File No. 11-A-15-AC Unnamed Alley (Sewer)

CLT MAP #94 CITY BLOCK #10146 PARCEL(S) #4, 6, 7, 8



Knowlton Utilities Board



100 Feet

Printed: 10/18/2015 14:22 PM



Product Warning: This map was produced from the easement information system maintained by KUB. This map should not be relied on for engineering, design, or surveying work or other similar type uses. The information on this map is called and has no warranty of merchantability or warranty for fitness for a particular purpose, express or implied. This map is produced, printed, and distributed as is, with all faults.