



CITY OF KNOXVILLE

Engineering  
James R. Hagerman, P.E.  
Director of Engineering

August 24, 2015

Mr. Mike Brusseau, AICP, Senior Planner  
Knoxville-Knox County Metropolitan Planning Commission  
City-County Building, Suite 403  
Knoxville, Tennessee 37902

SUBJECT: Closure of Old Callahan Drive from NW corner of 067EA012 to SE corner of 067EA012  
MPC File # 9-A-15-SC; City Block 40867

Mr. Brusseau:

The City Engineering Department has no objections to close the above reference right-of-way area.

However, should this right-of-way be closed, the City will reserve easements for all drainage facilities and utilities, if any, located in or within five (5) feet of the property described herein.

Sincerely,

*Benjamin D. Davidson*

Benjamin D. Davidson, P.L.S., Technical Services Administrator, Department of Engineering  
Ph: 865-215-2148

C: Christopher S. Howley, P.E., Plans Review and Development Inspections



Knoxville Utilities Board



August 14, 2015

Mr. Mike Brusseau  
Knoxville-Knox County  
Metropolitan Planning Commission  
Suite 403, City-County Building  
Knoxville, Tennessee 37902

Dear Mr. Brusseau:

**Re: Right-of-Way Closure Request 9-A-15-SC  
Block No. 40867  
CLT No. 67  
Parcel No. 12**

We have reviewed our records and find that we have existing utility facilities located within the subject right-of-way. The approximate location of these facilities is indicated on the enclosed prints. However, KUB does not release and hereby retains all easements and rights for existing utility facilities, whether or not shown on these prints.

Should this right-of-way be closed, KUB will require the following permanent easement for its utility facility.

- Electric – 10 feet on each side of the centerline of the electric line, 20 feet total width
- Gas – 12.5 feet on each side of the centerline of the gas line, 25 feet total width
- Gas – 7.5 feet on each side of the centerline of the gas line, 15 feet total width

So long as these conditions are met, KUB has no objection to the closure of this right-of-way. If you have any questions regarding this matter, please call me at (865) 558-2291.

Sincerely,

Greg L. Patterson, P.E.  
Engineering

GLP/ggt

Enclosure

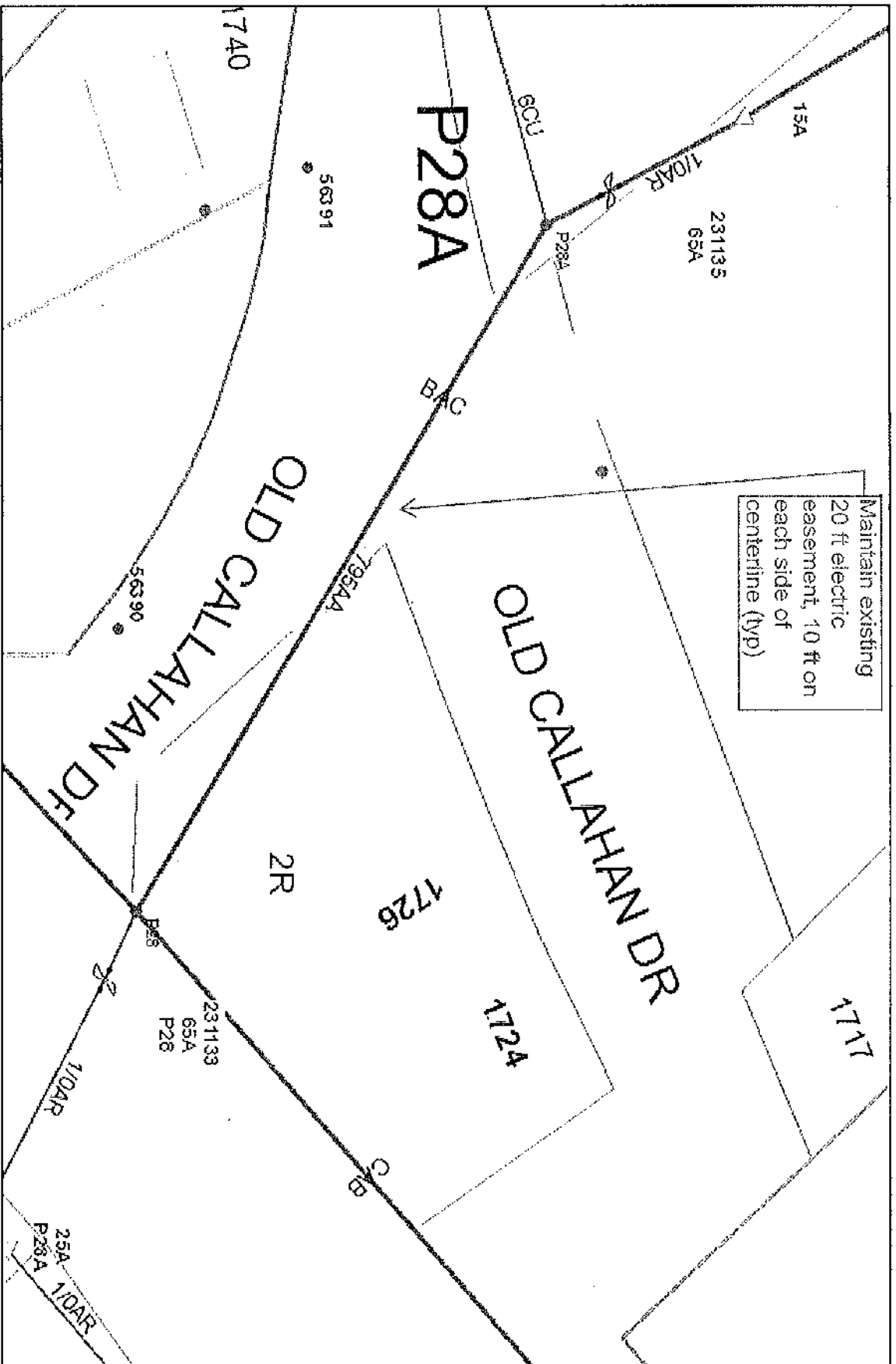

**File No. 9-A-15-AC Closure of Old Callahan Drive (Electric)**

City Block #40867 Parcel #12 CLT Map #67



Knowlton Utilities Board



Planned: 08/13/2015 10:27 PM



Product Warning: This map was produced from the LARcase information system maintained by KUB. This map should not be relied on for engineering, design, or surveying work or other similar type uses. The information on this map is dated and has no warranty of merchantability or warranty for fitness of use for a particular purpose, express or implied. This map is produced, printed, and distributed as is, with all faults.

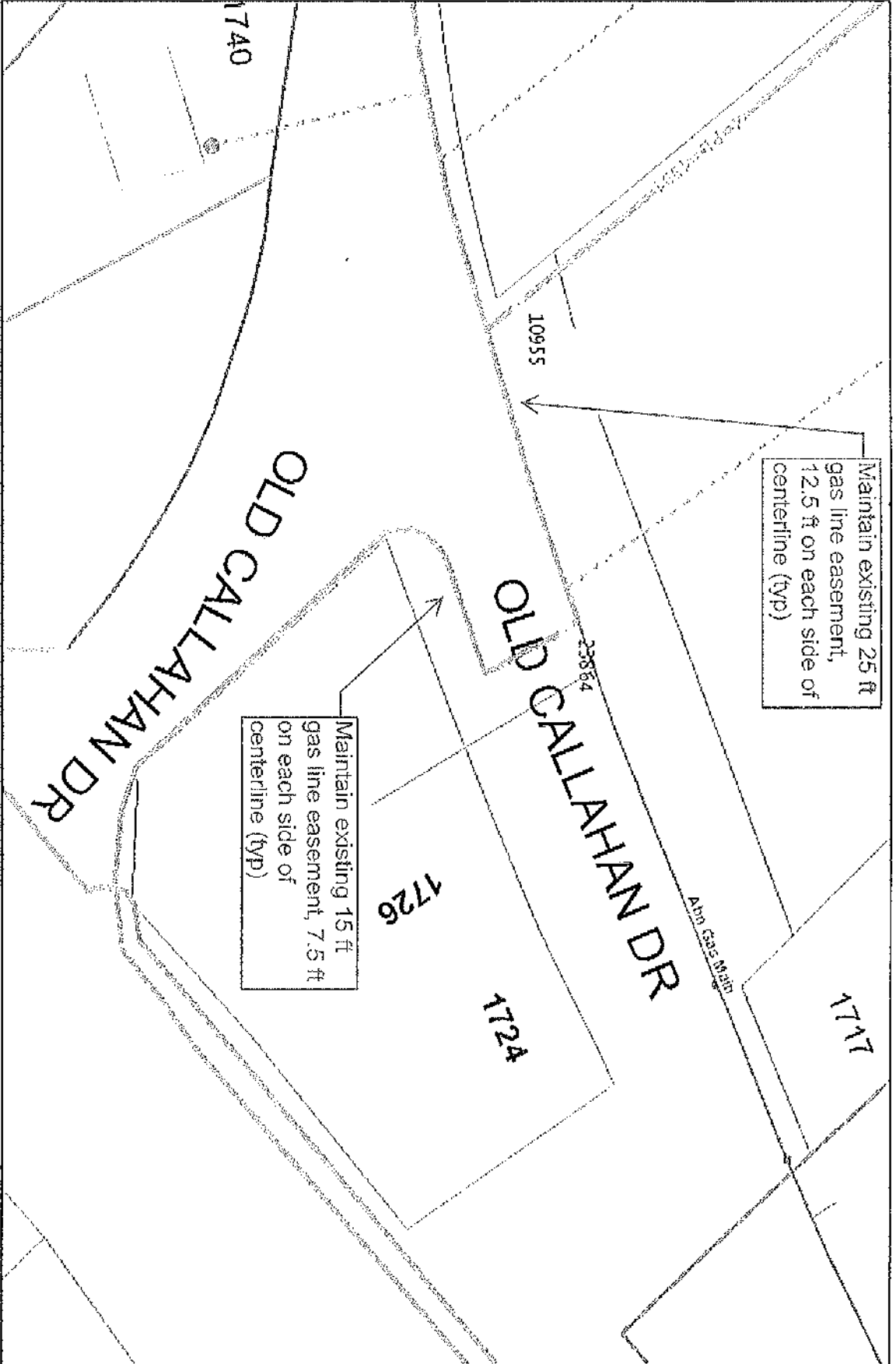

**File No. 9-A-15-AC Closure of Old Callahan Drive (Gas)**

City Block #40867 Parcel #12 CLT Map #87



Knowledge Utilities Board



100 Feet

Printed: 02/18/2015 12:27 PM



Product Warning: This map was produced from the landscape information system maintained by KUB. This map should not be relied on for engineering, design, or surveying work or other similar type uses. The information on this map is dated and has no warranty of merchantability or warranty for fitness of use for a particular purpose, express or implied. This map is produced, printed, and distributed as is, with all faults.