

7-B-16-SP Revised
NORTH CITY SECTOR PLAN AMENDMENT

From: LDR (Low Density Residential)
 To: O (Office)

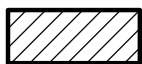

Original Print Date: 6/15/2016 Revised: 7/11/2016
 Metropolitan Planning Commission * City / County Building * Knoxville, TN 37902

Petitioner: Ed Smith - Pratt Partners LLC

Map No: 68
 Jurisdiction: City

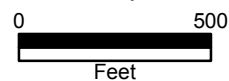

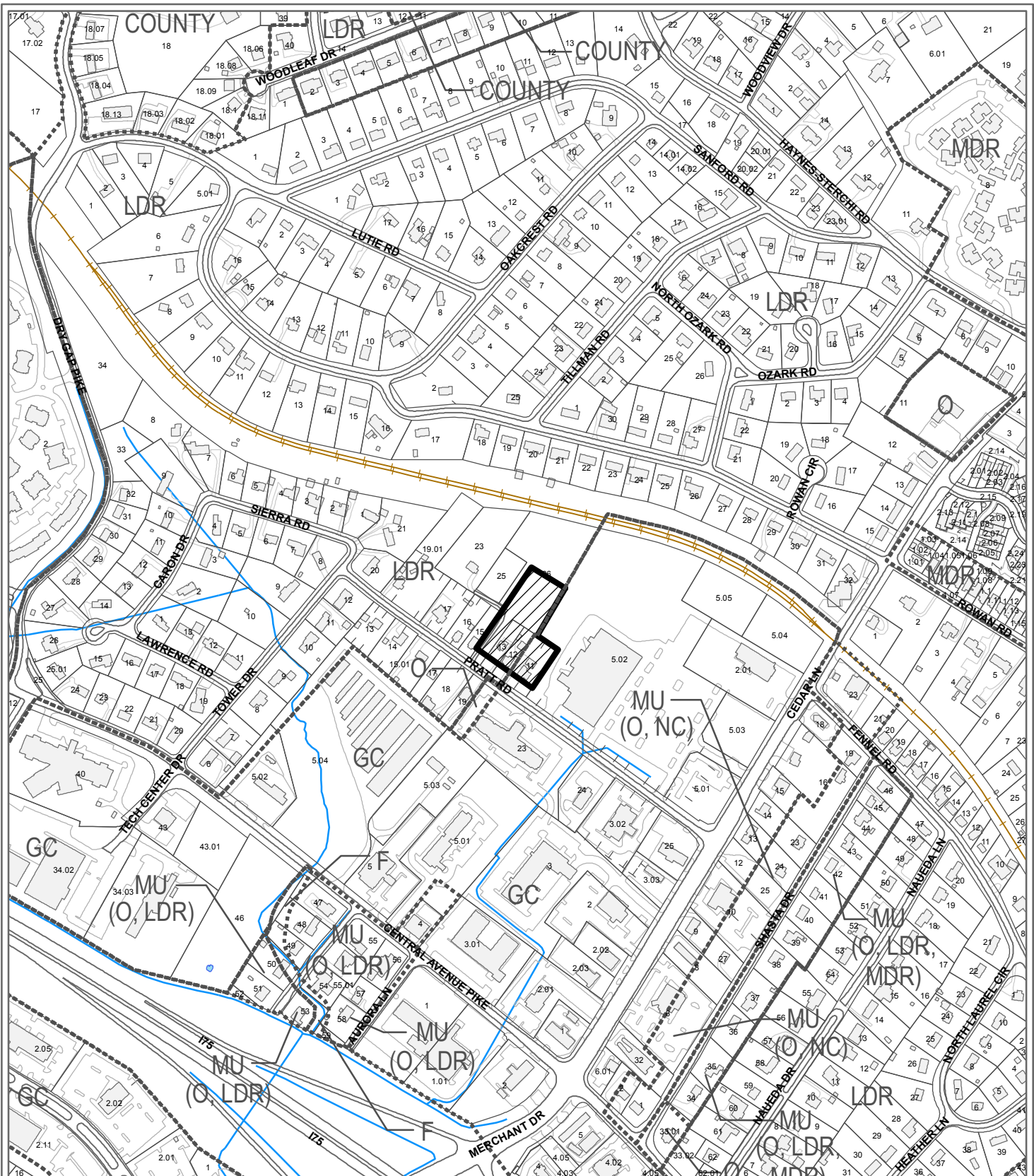

**7-B-16-PA / 7-B-16-RZ Revised
PLAN AMENDMENT**

From: LDR (Low Density Residential)
To: O (Office)



Petitioner: Ed Smith - Pratt Partners LLC

Map No: 68
Jurisdiction: City

Original Print Date: 6/15/2016 Revised: 7/11/2016
Metropolitan Planning Commission * City / County Building * Knoxville, TN 37902

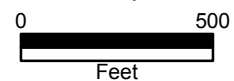

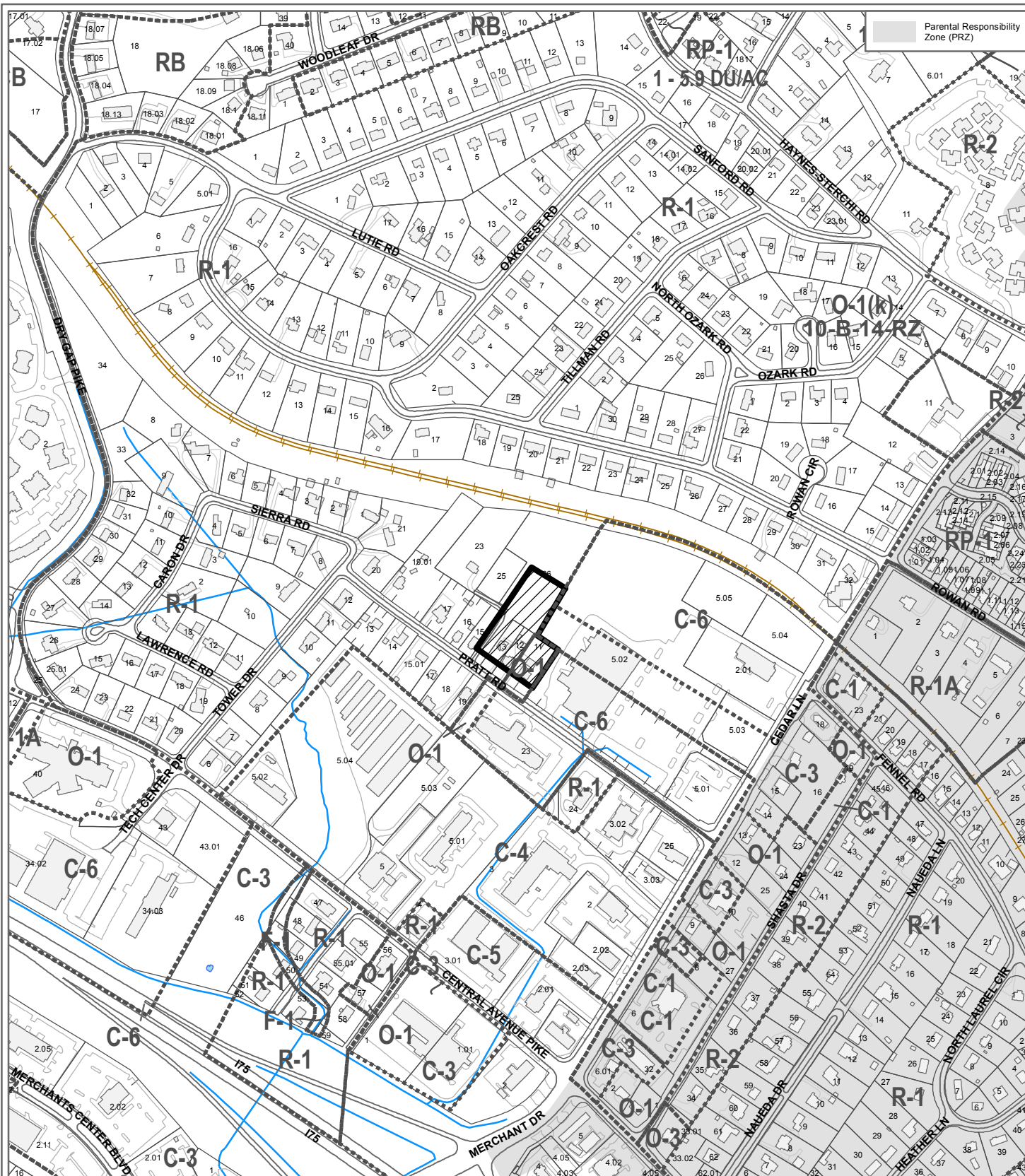

**7-B-16-RZ Revised
REZONING**

From: R-1 (Low Density Residential)

To: O-1 (Office, Medical and Related Services)

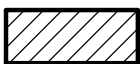

Original Print Date: 6/15/2016
 Metropolitan Planning Commission * City / County Building * Knoxville, TN 37902

Revised: 7/11/2016

Petitioner: Ed Smith - Pratt Partners, LLC

Map No: 68

Jurisdiction: City

