



CITY OF KNOXVILLE



Engineering
James R. Hagerman, P.E.
Director of Engineering

April 21, 2016

Mr. Mike Brusseau, AICP, Senior Planner
Knoxville-Knox County Metropolitan Planning Commission
City-County Building, Suite 403
Knoxville, Tennessee 37902

SUBJECT: Closure of an unnamed alley between Camp Avenue and TDOT Interstate Right-of-Way
MPC File # 5-A-16-AC; City Block 11462

Mr. Brusseau:

The City Engineering Department has no objections to close the above reference unnamed alley area.

However, should this right-of-way be closed, the City will reserve easements for all drainage facilities and utilities, if any, located in or within five (5) feet of the property described herein. If facilities or utilities are found not feasible to the site development or use, they may be removed and relocated, subject to City Engineering and/or other applicable easement holder review and approval.

Sincerely,

Benjamin D. Davidson, PLS, Technical Services Administrator, Department of Engineering
Ph: 865-215-2148

5-A-16-AC cor- KUB



Knoxville Utilities Board



April 22, 2016

Mr. Mike Brusseau
Knoxville-Knox County
Metropolitan Planning Commission
Suite 403, City-County Building
Knoxville, Tennessee 37902

Dear Mr. Brusseau:

**Re: Right-of-Way Closure Request 5-A-16-AC
Block No. 11462
CLT No. 81
Parcel No. 14**

We have reviewed our records and find that we have existing utility facilities located within the subject right-of-way. The approximate location of these facilities is indicated on the enclosed prints. However, KUB does not release and hereby retains all easements and rights for existing utility facilities, whether or not shown on these prints.

Should this right-of-way be closed, KUB will require the following permanent easement for its utility facility.

- Electric – 10 feet on each side of the centerline of the electric line, 20 feet total width
- Sewer – 7.5 feet on each side of the centerline of the wastewater line, 15 feet total width

So long as these conditions are met, KUB has no objection to the closure of this right-of-way. If you have any questions regarding this matter, please call me at (865) 558-2291.

Sincerely,

Greg L. Patterson, P.E.
Engineering

GLP/ggt

Enclosure

N-HALL OF FA

58826

59511

MAINTAIN EXISTING 20 FT
ELECTRIC EASEMENT,
10 FT ON EACH SIDE OF
CENTERLINE (TYP)

601
53

0

0

0

31

32

33

1302

910

3

CAMP AVE

6CU

37C

1224#1

2

1226

LUTTRELL

795AA

BAC

27984

37A

1231

1227

1221

33A#CAVE at LUTTRELL ST

40A

KGIS Copyright - YYYY

kub,kgis, KUB, KUB, KGIS

Printed: 4/18/2016 at 3:37:50 PM



File No. 5-A-16-AC Unnamed Alley ROW Closure (Electric)

CLT MAP #81 PARCEL #14 CITY BLOCK #11462
BETWEEN CAMP AVE AND TDOT INTERSTATE ROW

Knoxville - Knox County - KUB Geographic Information System

KGIS makes no representation or warranty as to the accuracy of his map and its information nor to its fitness for use. Any user of this map product accepts the same AS IS ,WITH ALL FAULTS, and assumes all responsibility for the use thereof, and further covenants and agrees to hold KGIS harmless from any and all damage, loss, or liability arising from any use of this map product.

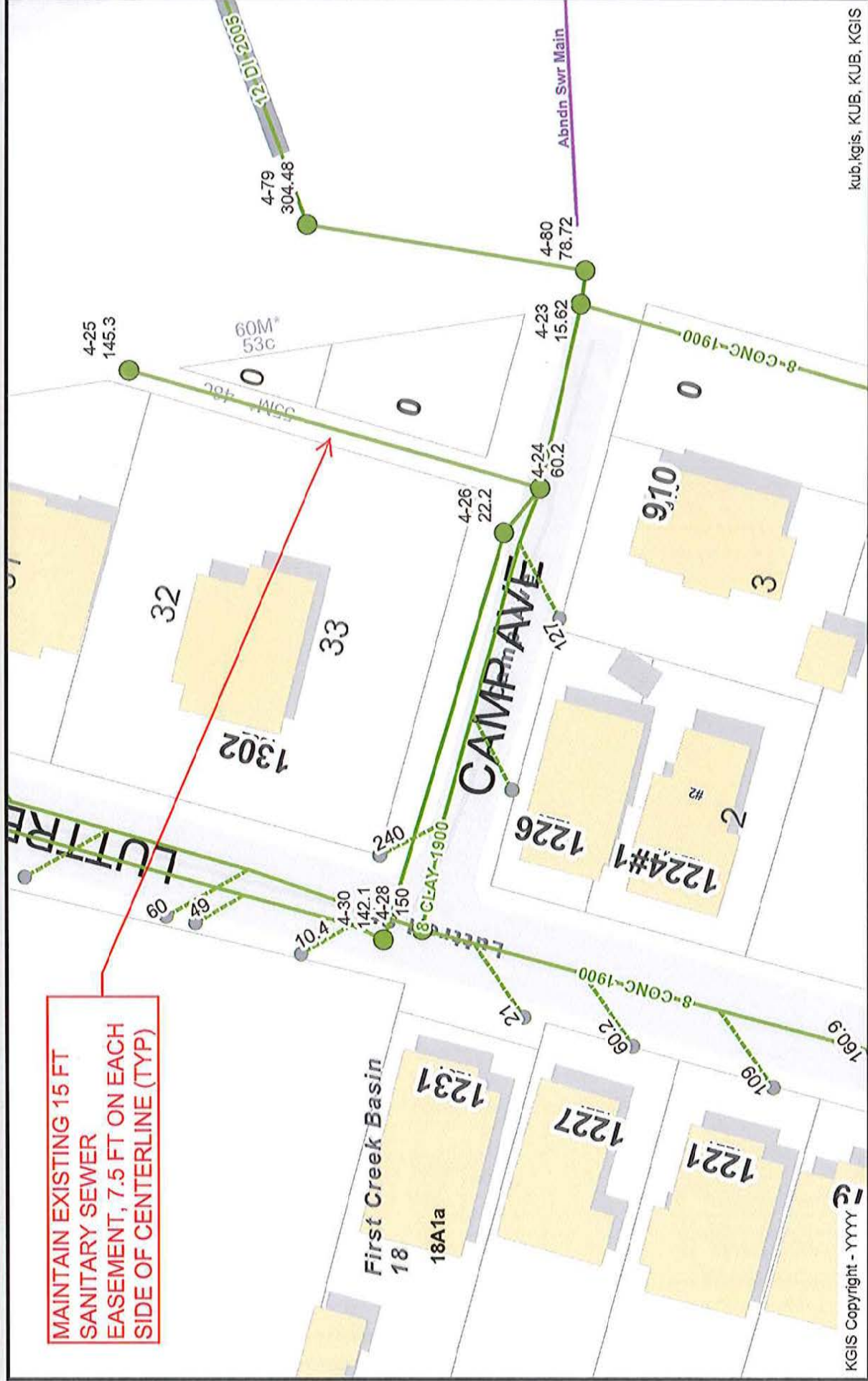

kub,kgis, KUB, KUB, KGIS

MAINTAIN EXISTING 15 FT
 SANITARY SEWER
 EASEMENT, 7.5 FT ON EACH
 SIDE OF CENTERLINE (TYP)

Printed: 4/18/2016 at 10:06:46 AM

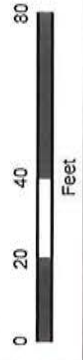

File No. 5-A-16-AC Unnamed Alley Row Closure (Sewer)

CLT MAP #81 PARCEL #14 CITY BLOCK #11462
 (BETWEEN CAMP AVE AND TDOT INTERSTATE ROW)

Knoxville - Knox County - KUB Geographic Information System

KGIS makes no representation or warranty as to the accuracy of this map and its information nor to its fitness for use. Any user of this map product accepts the same AS IS, WITH ALL FAULTS, and assumes all responsibility for the use thereof, and further covenants and agrees to hold KGIS harmless from any and all damage, loss, or liability arising from any use of this map product.