

KGIS Copyright - 2017

3.7 Acres Adjacent to Existing RB Zoning

Not Spot Zoning if Requesting RB Zoning

Knoxville - Knox County - KUB Geographic Information System

Printed: 7/10/2017 at 10:23:24 PM

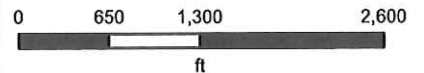

KGIS makes no representation or warranty as to the accuracy of his map and its information nor to its fitness for use. Any user of this map product accepts the same AS IS, WITH ALL FAULTS, and assumes all responsibility for the use thereof, and futher covenants and agrees to hold KGIS harmless from any and all damage, loss, or liability arising from any use of this map product.

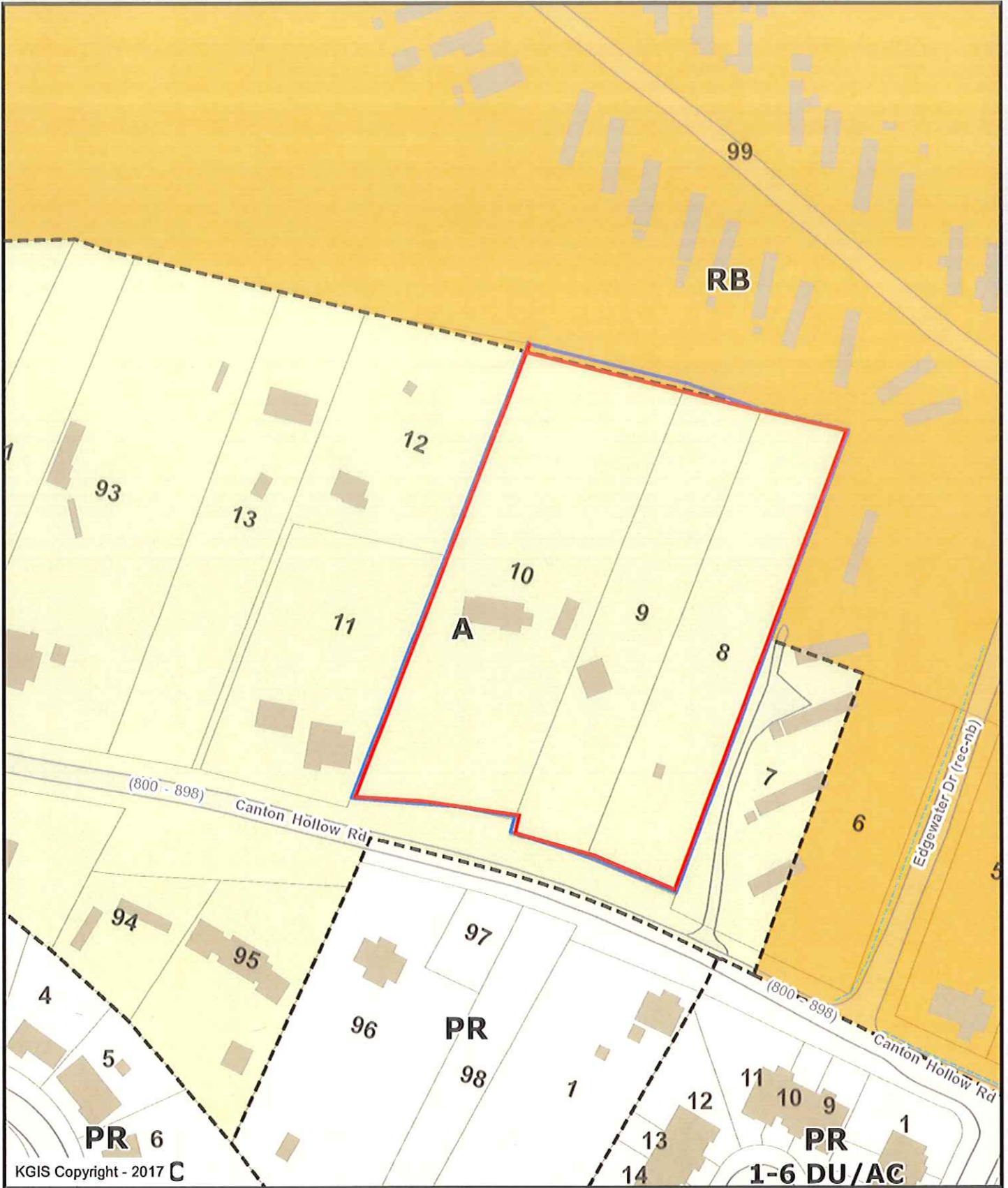

KGIS Copyright - 2017 C

3.7 Acres Adjacent to Existing RB Zoning

Not Spot Zoning if Requesting Extension of RB Zoning
 East Part of Land Now Zoned RB

Knoxville - Knox County - KUB Geographic Information System

Printed: 7/11/2017 at 12:50:49 AM

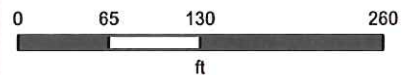

KGIS makes no representation or warranty as to the accuracy of his map and its information nor to its fitness for use. Any user of this map product accepts the same AS IS, WITH ALL FAULTS, and assumes all responsibility for the use thereof, and further covenants and agrees to hold KGIS harmless from any and all damage, loss, or liability arising from any use of this map product.



KGIS Copyright - 2017

3.7 Acres Adjacent to Existing RB Zoning

Not Spot Zoning if Requesting Extension of RB Zoning

Natural Buffer and Topography Protect View

Knoxville - Knox County - KUB Geographic Information System

Printed: 7/10/2017 at 10:46:18 PM

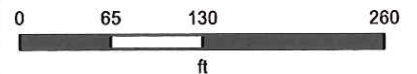

KGIS makes no representation or warranty as to the accuracy of his map and its information nor to its fitness for use. Any user of this map product accepts the same AS IS, WITH ALL FAULTS, and assumes all responsibility for the use thereof, and further covenants and agrees to hold KGIS harmless from any and all damage, loss, or liability arising from any use of this map product.