

**ARTICLE 12. LANDSCAPE**

- 12.1 PURPOSE**
- 12.2 LANDSCAPE PLAN**
- 12.3 SELECTION, INSTALLATION AND MAINTENANCE**
- 12.4 LANDSCAPE DESIGN STANDARDS**
- 12.5 PARKING LOT PERIMETER LANDSCAPE YARD**
- 12.6 INTERIOR PARKING LOT LANDSCAPE**
- 12.7 SITE LANDSCAPE**
- 12.8 BUFFER YARDS**
- 12.9 TREE PRESERVATION**

**12.1 PURPOSE**

The landscape standards of this Article are intended to:

- A.** Create a desirable and functional open space environment for all site users, including pedestrians, bicyclists, and motorists.
- B.** Preserve unique natural resources, including measures to preserve and protect existing healthy plantings.
- C.** Design drainage facilities to promote the use and preservation of natural watercourses and patterns of drainage.
- D.** Establish a natural environment within the City that provides a variety of benefits, including absorbing carbon dioxide and producing oxygen; intercepting stormwater, reducing surface runoff, curtailing erosion, and improving water quality; providing critical wildlife habitat to promote urban biodiversity; and providing shade to aid in passive cooling and the reduction of urban heat island effect.
- E.** Utilize plant materials suitable to withstand the climatic conditions of the City and microclimate of the site. The use of species native and naturalized to Tennessee is encouraged.
- F.** Use of screening to minimize the impact of the development on adjacent uses and impact of incompatible uses and certain site elements, and creating a logical transition to adjoining lots and developments.

**12.2 LANDSCAPE PLAN****A. Landscape Plan Required**

A landscape plan is required as part of a site plan review application for multi-family and townhouse development, nonresidential (including mixed-use) development, parking lots, and planned developments. The landscape plan must be approved prior to the issuance of a building permit.

**B. Content of Landscape Plan**

- 1.** North arrow and graphic scale, the location and dimensions of all existing and proposed structures, property lines, easements, parking lots and drives, rights-of-way, refuse disposal and recycling areas, pedestrian and bicycle paths, fences, mechanical equipment, overhead utility wires, underground utilities, retention/detention facilities, and other drainage facilities, such as drainage swales.
- 2.** The location, quantity, size, name, and condition, both botanical and common, of all existing plant materials on-site, indicating plant material to be retained and to be removed.
- 3.** The location, quantity, size, and name, both botanical and common, of all proposed plant material. This includes lawn and turf applications.
- 4.** The existing and proposed grading of the site indicating contours at one foot intervals. Any proposed berming, earthwork, or stormwater management basins must also be indicated using one foot contour intervals.
- 5.** Elevations of all proposed fences, stairs, and retaining walls.
- 6.** Existing and proposed plantings in the right-of-way.
- 7.** Any proposed irrigation plan, if irrigation is provided.

8. Any other details as determined necessary by the review body.

## **C. Minor Changes to Approved Landscape Plans**

Minor changes to the landscape plan that do not result in a reduction in the net amount of plant material as specified on the approved landscape plan may be approved by the Zoning Administrator. Changes that reduce the amount of plant materials contained within an approved landscape plan are a major change and must be approved by the body granting approval of the landscape plan initially.

## **D. Alternative Landscape Design**

1. These landscape requirements are intended to set minimum standards for quality development and environmental protection. Site conditions or other reasons may justify the need to request an alternate method of compliance. Alternative landscape plans may be considered when an applicant cannot meet one or more of the specific requirements of this Article because:

- a. Strict application of the landscaping requirements would require unreasonable or unnecessary compliance. Such situations could include water features, topography, lot configurations, utility maintenance zones, or unusual site conditions.
- b. The applicant envisions a more creative means to meet the spirit and intent of these requirements.
- c. A comprehensive landscaping plan involving several properties is proposed.

2. The applicant must submit an alternative landscape plan indicating proposed landscaping, that includes a list of landscaping requirements not met, a description of the alternatives proposed, and a written explanation of how the proposed plan fulfills the spirit and intent of the landscape requirements. The Alternative Landscape Plan must be submitted to and approved by the Administrative Review Committee. In approving the alternative landscape plan, the Administrative Review Committee must find that:

- a. The proposed alternative will not present a safety hazard.
- b. That proposed alternative will, upon maturity, provide landscaping that is equal to or better than the standards requirements.
- c. The proposed alternative is designed to address plant health and vigor.
- d. The proposed alternative is reasonably compatible with the natural and topographic features of the site.

**12.3 SELECTION, INSTALLATION AND MAINTENANCE****A. Selection**

1. All plant materials must be of good quality and meet American Horticulture Industry Association (AmericanHort) or its ANSI accredited successor's standards for minimum acceptable form, quality, and size for species selected.
2. Species must be selected based on those that will survive and thrive in East Tennessee. Trees should be selected from the City of Knoxville's Tree List maintained by the City.
3. The use of species native or naturalized is required. Drought tolerant species are encouraged.
4. Invasive species are prohibited.

**B. Installation**

1. All landscape materials must be installed in accordance with current nursery industry standards, and must be properly supported to ensure survival. Support devices such as guy wires or stakes must not interfere with pedestrian or vehicular movement.
2. No plantings may be installed to impede water flow.
3. All plant materials must be free of disease and installed so that soil of sufficient volume, composition, and nutrient balance are available to sustain healthy growth. Installation of plant materials during the appropriate growing season is encouraged.
4. Landscape should not conflict with existing overhead and underground utility infrastructure and maintenance zones. Landscape plans should reference the City of Knoxville's Tree List for appropriate species and their respective planting distances from adjacent utility infrastructure. Landscaping should not be selected that at maturity would grow into conflict with the utility maintenance zone. Alternative landscape plans (Section 12.1.D) may be considered when an applicant demonstrates that requirements may conflict with the utility maintenance zones.
  - a. Overhead utilities: At maturity, landscaping should not grow within ten feet of primary distribution lines and 25 feet within 69kv sub-transmission lines.
  - b. Utility poles: Trees should not be planted within ten feet of primary distribution poles and 25 feet within 69kV sub-transmission poles.
  - c. Support wires: Trees should not be planted within five feet of supporting guy wires.
  - d. Underground utility lines: The minimum distance of tree planting from the utility center line should be a minimum of ten feet. Shrubs and other landscaping vegetation are permitted in this area.
  - e. Pad mount transformers: Landscaping should be planted a minimum of six feet away from the side with doors and three feet away from the other sides.
5. No landscape should be located within any utility easement, with the exception of lawn grass or other resilient groundcover. If landscape material is located within a utility easement and repair or replacement of the utility is needed, the City or utility is not responsible for the replacement of any landscape that may be damaged.

**C. Curbing**

1. Landscaped areas may be recessed if flush curbs are utilized. If recessed, the landscaped areas must be designed for stormwater management and to prevent erosion and tracking.
2. Landscaped areas must be protected from encroachment of vehicles through use of curbs or wheel stops where necessary.

**D. Maintenance**

1. Landscape materials depicted on approved landscape plans are considered a required site element in the same manner as structures, required parking, lighting, and other improvements. As such, the owner of record or the business or homeowner's association is responsible for the maintenance, repair, and replacement of all landscape materials, fences, steps, retaining walls, and similar landscape elements.
2. All landscape materials must be maintained in good condition, present a healthy appearance, and be kept free of refuse and debris. Any dead, unhealthy, or missing plants must be replaced within 30 days of notification, unless an extension is approved by the City.

**12.4 LANDSCAPE DESIGN STANDARDS****A. Minimum Planting Sizes**

Minimum planting sizes are as follows. For the purposes of determining trunk size, the diameter/caliper is measured at six inches above ground level, unless otherwise specified in current ANSI accredited Horticultural Standards.

1. Evergreen trees must have a minimum height of eight feet.
2. Shade trees must have a minimum two inch caliper.
3. Single stem ornamental trees must have a minimum trunk size of 2.5 inches in caliper. Multiple stem ornamental trees must have a minimum height of eight feet.
4. Evergreen or deciduous shrubs of 18 inches in height.

**B. Species Diversity**

Diversity among required plant material is required for visual interest and to reduce the risk of losing a large population of plants due to disease. Table 12-1: Plant Diversity Requirements indicates the percentage of diversity required based on the total quantity of species being used. (For example, if a development requires 45 shade trees, no more than 18 trees (40%) can be of one species, and there must be a minimum of five different species within the 45 trees.) When the calculation of plant diversity requirements results in a fraction, the fraction is rounded up.

Table 12-1: Plant Diversity Requirements		
Total Number of Plants per Plant Type	Maximum Number of One Species	Minimum Number of Species
1-4	100%	1
5-10	60%	2
12-15	45%	3
16-75	40%	5
76-500	25%	8
500-1,000	30%	10
1,000+	15%	15

**12.5 PARKING LOT PERIMETER LANDSCAPE YARD**

A perimeter landscape yard is required for all parking lots, including vehicular use areas, of 10,000 square feet or more in area. The perimeter landscape yard must be established along the edge of the parking lot to screen vehicle parking from the right-of-way. When an existing parking area is expanded, only the area of expansion shall be required to comply with these landscaping standards. The landscaped area must be improved as follows:

- A. A perimeter yard must be at least ten feet wide, measured from the edge of the parking lot to the right-of-way or, if utilities exist, to the utility maintenance zone, between the parking area and the right-of-way of adjoining streets.
- B. The perimeter yard must be planted with a minimum of three shade and/or evergreen trees and ten shrubs for every 100 linear feet. A minimum of 50% of the shrubs must be evergreen. For parking lots, including vehicular use areas, of less than 20,000 square feet in area, the width of the perimeter screening area may be reduced to six feet.
- C. 60% of the landscape area outside of shrub and tree masses must be planted in live groundcover, perennials, or ornamental grasses. Stone, mulch, or other permeable landscape materials may be used for any remaining area.

D. Parking lots located on properties developed under a common or unified development plan and/or which have a shared access agreement are not required to provide the perimeter screening area along common property lines where parking areas abut.

## PARKING LOT PERIMETER LANDSCAPE YARD

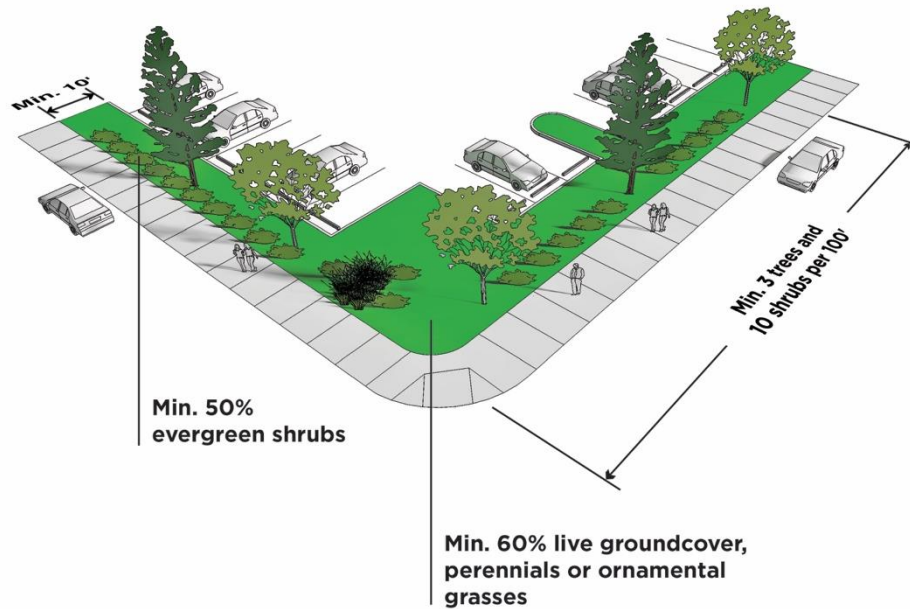

## 12.6 INTERIOR PARKING LOT LANDSCAPE

Interior parking lot landscape is required for all parking lots and vehicular use areas of 20,000 square feet or more in area. The landscaped required is as follows:

- A.** Where more than 15 parking stalls are provided in a row, one parking lot island must be provided between every 15 parking spaces. As part of the landscape plan approval, parking lot island locations may be varied based on specific site requirements or design scheme, but the total number of islands must be no less than the amount required of one island for every 15 spaces.
- B.** Parking lot islands must be the same dimension as the parking stall. Double rows of parking must provide parking lot islands that are the same dimension as the double row.
- C.** A minimum of one shade tree must be provided in every parking lot island or landscape area. In addition to the required shade trees, a minimum of 60% of the area of every parking lot island must be planted in shrubs, live groundcover, perennials, or ornamental grasses, unless the parking lot island or landscape area is designed to facilitate pedestrian access through the parking lot as approved in landscape plan review. Stone, mulch, or other permeable landscape materials may be used for any remaining area.

## INTERIOR PARKING LOT LANDSCAPE

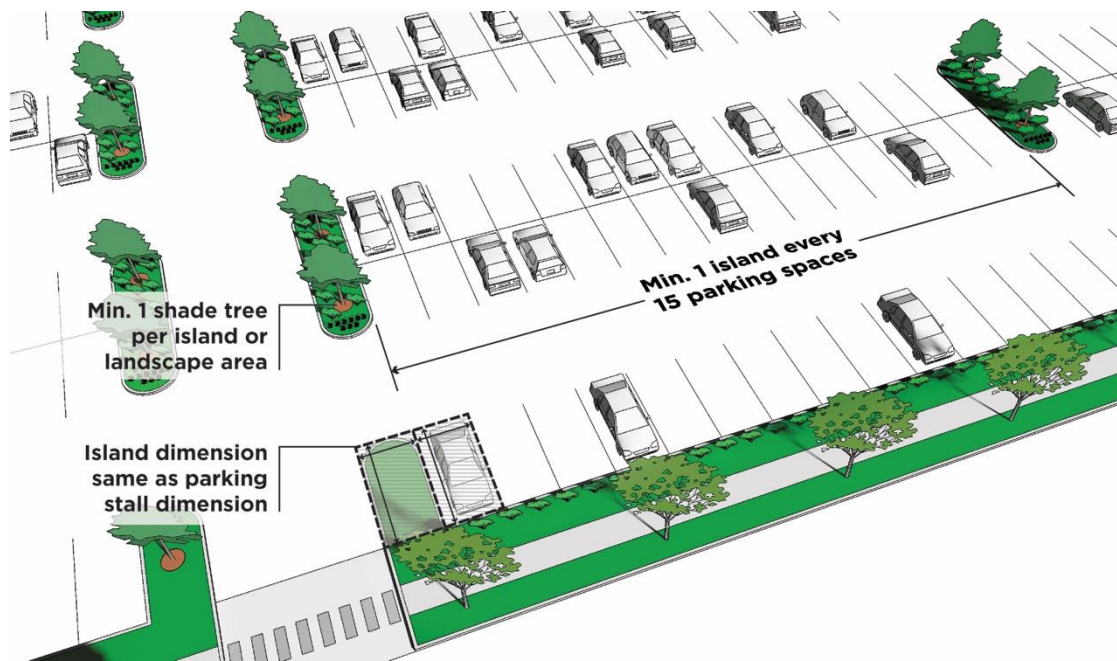
**12.7 SITE LANDSCAPE**

**A.** Areas of any lot that are not covered by structures or pavement must be planted with live landscaping. Stone, mulch, or other permeable landscape materials may be used to satisfy this requirement, but must not cover more than 40% of the landscape area.

**B.** Where multi-family and nonresidential (including mixed-use) developments are located ten feet or more from a street lot line and no parking is located in front of the structure and also where any façade abuts any parking area, foundation landscape must be planted as described below. This planting area is required along 60% of the linear façade area. This percentage may be reduced to accommodate entry design and other building functional operations during landscape plan review.

1. One shrub for every three feet. Shrub locations within the planting area may be varied, but the total number of shrubs must be no less than as required in this section.
2. Shade trees are required in the amount of one tree every 50 feet. Two ornamental trees may be substituted for one shade tree and must be spaced one ornamental tree every 25 feet. Tree locations within the planting area may be varied, but the total number of trees must be no less than as required in this section.
3. 60% of the landscape area outside of shrub and tree masses must be planted in live groundcover, perennials, or ornamental grasses. Stone, mulch, or other permeable landscape materials may be used for the remaining area.
4. Planted pots and/or planter boxes may be used to satisfy up to 30% of the total landscape area requirement.

**C.** In the SW District, all slopes steeper than 3:1 must be planted for erosion control.

## SITE LANDSCAPE

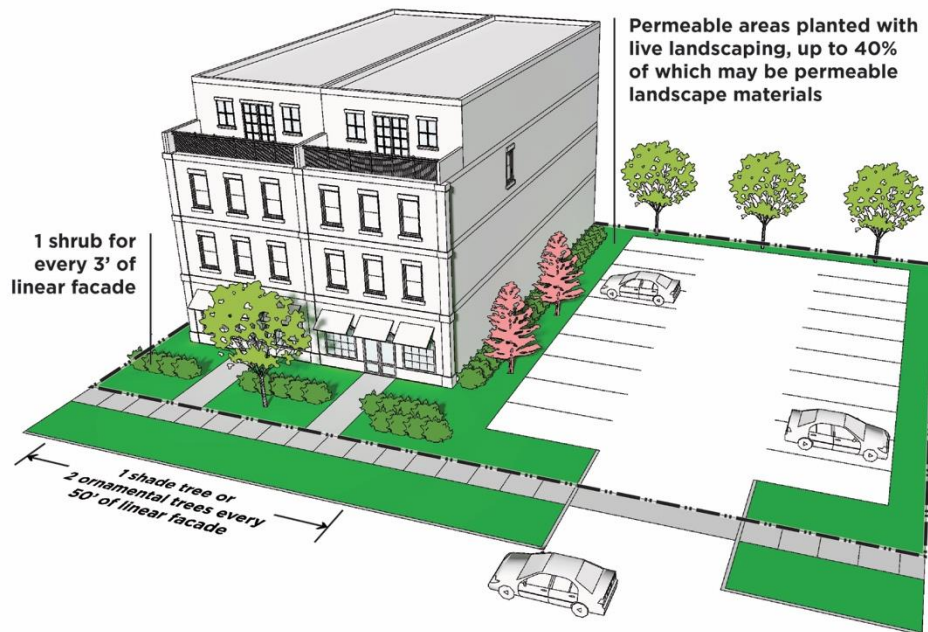

### 12.8 BUFFER YARDS

This section establishes standards for the dimension and required landscape for buffer yards between land uses and/or zoning districts within the rear and/or side yards. Nothing in this section prevents the applicant's voluntary installation of buffer yards where they are not required.

**A.** As of the effective date of this Code, buffer yards are required for new construction along interior side and rear lot lines.

**B.** Buffer yards may be located within required setbacks but must be reserved for the planting of material and installation of screening as required by this section. No parking, driveways, sidewalks, accessory structures, or any impervious surfaces are permitted within the buffer yard area.

**C.** The two types of buffer yards are as follows:

#### 1. Class A Buffer

- a.** Minimum Width: Ten feet.
- b.** Minimum Required Shrubs: One shrub every five feet. A minimum of 50% of the shrubs must be evergreen.
- c.** Minimum Required Trees: One evergreen tree for every 25 feet and one shade tree for every 50 feet.
- d.** Planting locations may be varied, but the total number of trees must be no less than as required in this section.
- e.** 60% of the landscape area outside of shrub and tree masses must be planted in live groundcover, perennials, or ornamental grasses. Stone, mulch, or other permeable landscape materials may be used for the remaining area.

## 2. Class B Buffer

- a. Minimum Width: Twenty feet.
- b. Minimum Required Shrubs: One shrub every three feet. A minimum of 50% of the shrubs must be evergreen.
- c. Minimum Required Trees: One evergreen tree for every 20 feet and one shade tree for every 30 feet.
- d. Planting locations may be varied, but the total number of trees must be no less than as required in this section.
- e. 60% of the landscape area outside of shrub and tree masses must be planted in live groundcover, perennials, or ornamental grasses. Stone, mulch, or other permeable landscape materials may be used for the remaining area.

**D.** Where the buffer yard incorporates a wall, solid fence, or berm, or a combination of such, the buffer yard width may be reduced by 30%.

**E.** When a wall or solid fence is incorporated into a buffer yard, the fence must be a minimum of six feet to a maximum of eight feet. When a wall or solid fence is combined with a berm, the combined height of the wall or solid fence and berm cannot exceed eight feet.

**F.** Buffer yards are required as described in the following chart:

Development	Buffer Yard Class
Nonresidential use located within residential district	Class A Buffer
Nonresidential district abuts a residential district	Class B Buffer
Parking lot of a multi-family dwelling within a residential district	Class A Buffer
Per use standards	As determined in the standards of Article 9

### CLASS A BUFFER YARD

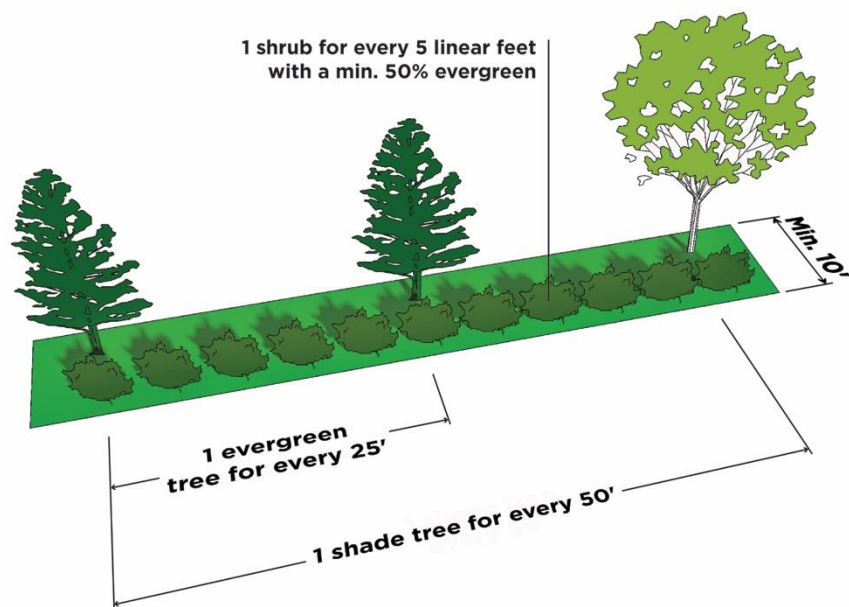

## CLASS B BUFFER YARD

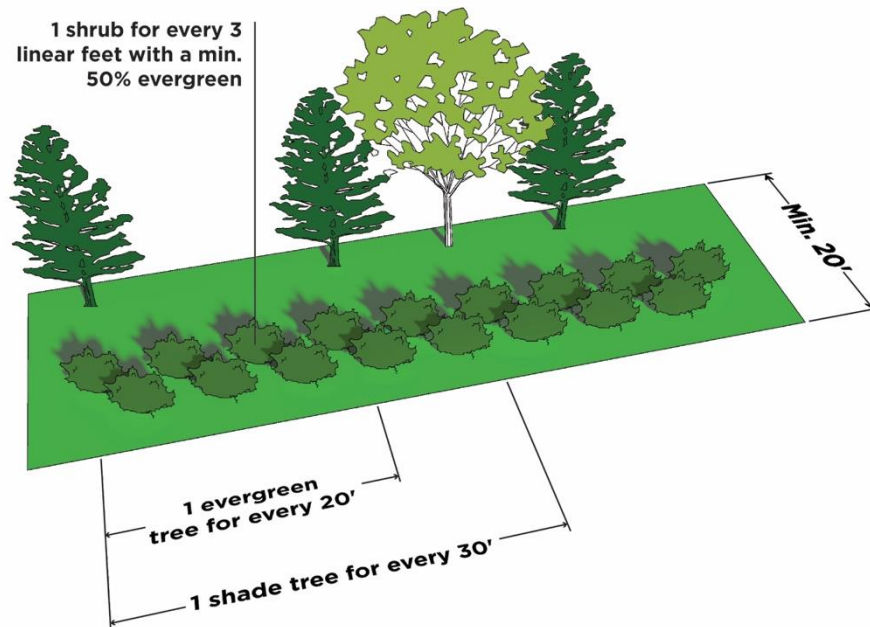

### 12.9 TREE PRESERVATION

Existing healthy trees must be conserved when possible and will be credited toward landscaping requirements, when they are comparable in terms of species to new trees that would be permitted in the proposed location.

**A.** Credit for conserving existing, healthy trees is subject to Urban Forester approval. The credit approved for each conserved tree is based on a tree's diameter, measured 4.5 feet above the ground, and may be up to the amount indicated below:

1. Four to eight inches: Two trees credited
2. Eight to twelve inches: Three trees credited
3. Twelve to eighteen inches: Four trees credited
4. Eighteen inches or greater: Five trees credited

**B.** Existing trees may be used to fulfill some of the perimeter screening requirements, subject to approval by the Zoning Administrator. Existing trees are credited as set forth in this section. Trees to be conserved must be identified on the required landscaping plan. Conserved trees may comprise no more than 50% of the perimeter screening requirements and must be supplemented with new landscaping as required to create an effective screen.

**C.** If existing trees are being used as credit toward meeting the tree planting standards, a grading permit will not be issued until the following protections are installed:

1. Within the drip line of any protected tree, there may be no cut or fill over a four inch depth unless a qualified arborist or forester has evaluated and approved the disturbance.
2. Prior to and during construction, temporary barriers must be erected around all protected trees with barriers a minimum of four feet in height, and no closer than six feet from the trunk or one-half of the drip line, whichever is greater. There may be no storage or movement of equipment, material, debris, or fill within the fenced, tree-protection zone.

## EXHIBIT B

PUBLIC DRAFT v.2.0  
July 2018

3. During construction, the applicant must prevent the cleaning of equipment or material or the storage and disposal of waste material, such as paints, oils, solvents, asphalt, concrete, motor oil, or any other material, potentially harmful to the tree within the drip line of any protected tree. Nothing within this section is interpreted as an authorization to ignore or violate applicable federal or state hazardous waste laws.
4. No damaging attachment, wires, signs, or permits may be fastened to any protected tree.