

DESIGN

GUIDELINES LANDSCAPE SCREENING

Type "A" Screen: Dense

APPROPRIATE LOCATION: Boundaries of commercial and industrial developments adjoining residential areas

NOTE: Landscape buffer strips should be a minimum of 15 feet in width, and sown with grass or ground cover for their full width, allowing for mulch at the base of plantings.

- Two offset rows of deciduous or evergreen canopy trees with a 6 ft. high continuous dense evergreen hedge, fence, wall or earth berm

TREE HEIGHT
Installed: 8 ft.
Mature: 40 ft.

SHRUB HEIGHT
Installed: 4 ft.
Mature: 6 ft.



Maximum 16' Centers

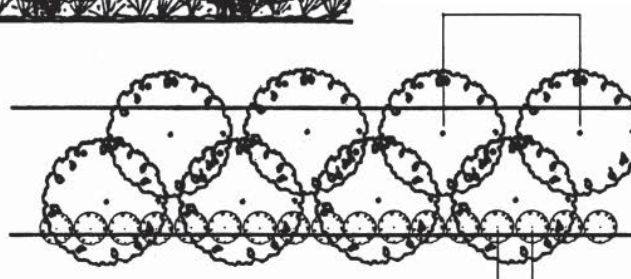

Maximum 4' Centers

- Two offset rows of evergreen trees with branches touching the ground

TREE HEIGHT
Installed: 8 ft.
Mature: 30 ft.

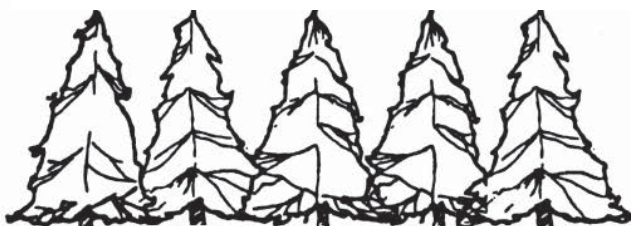

Maximum 12' Centers

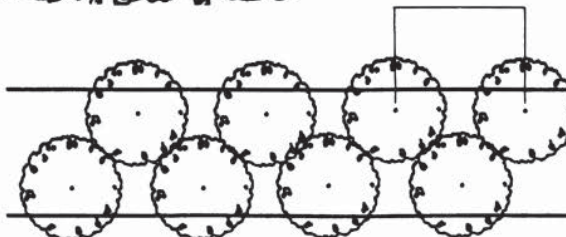

INTRODUCTION

Landscape screening reduces the impact of intense development upon adjacent land uses by providing visual separation, reducing the transmission of glare and air pollution, and limiting access. Screening also promotes the aesthetic appeal of a neighborhood and promotes higher property values.

This series of design guidelines defines several types of landscape screen. Each type is applicable to a certain intensity of conflict between adjacent land uses. Each screen type is illustrated by several planting schemes with an equivalent height, density and opacity of landscaping.

MPC uses these guidelines to illustrate desirable levels of screening appropriate to various site planning situations. Creative alternatives which achieve a comparable effect are encouraged.

For more information:

MPC
Development Services
Suite 403
City County Building
400 Main Street
Knoxville, TN 37902
Phone: 865 215-2500
Fax: 865 215-2068
Web: www.knoxmpc.org

The contents of these guidelines are advisory and are intended to supplement, but not replace, the requirements of the Knoxville Zoning Ordinance and the Knox County Zoning Ordinance.